

# BECKER POND DAM REMOVAL - MT. WASHINGTON, MA

## CLEAN WATER ACT, SECTION 404 PERMIT APPLICATION SEPTEMBER 2022

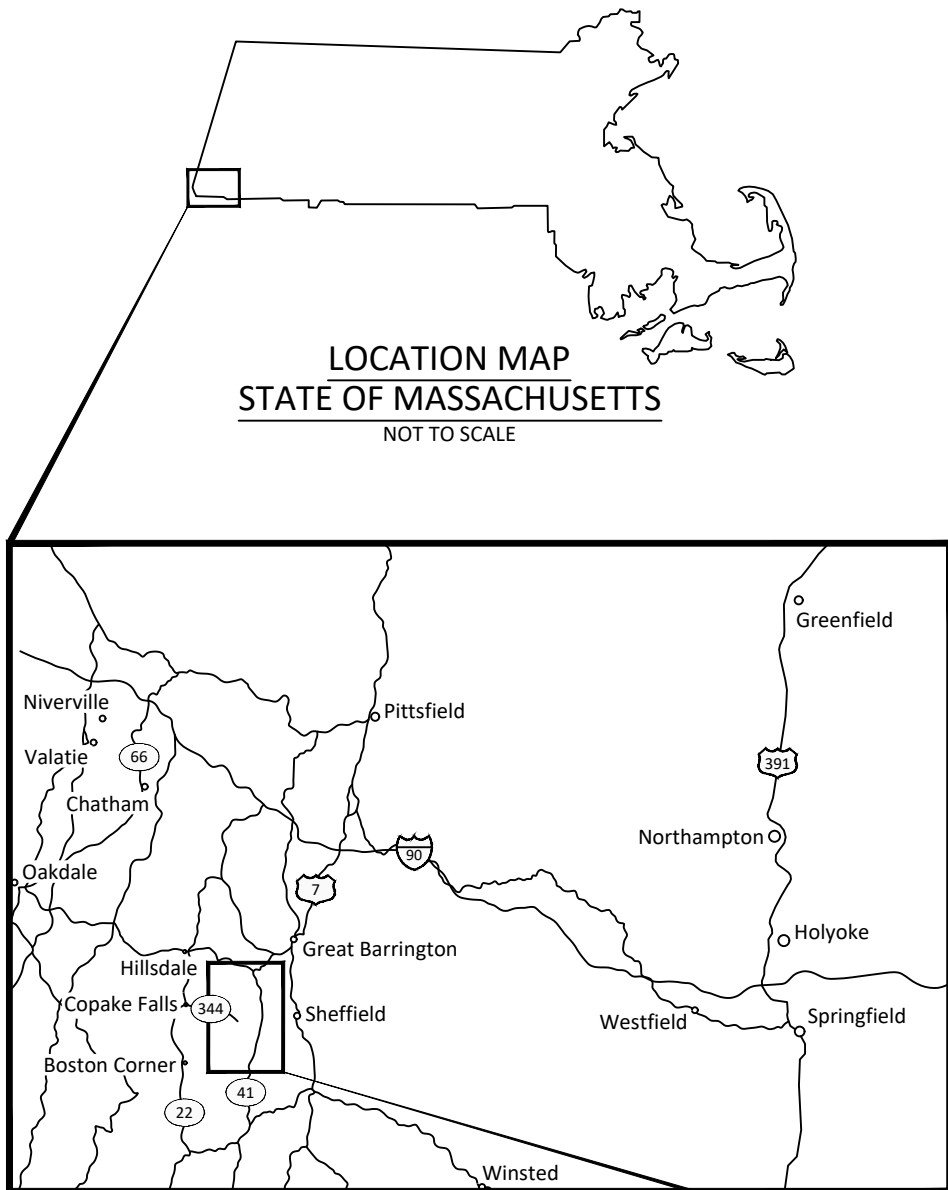

**LOCATION MAP**  
STATE OF MASSACHUSETTS  
NOT TO SCALE



**VICINITY MAP**  
SCALE: 1" = 15 MI.

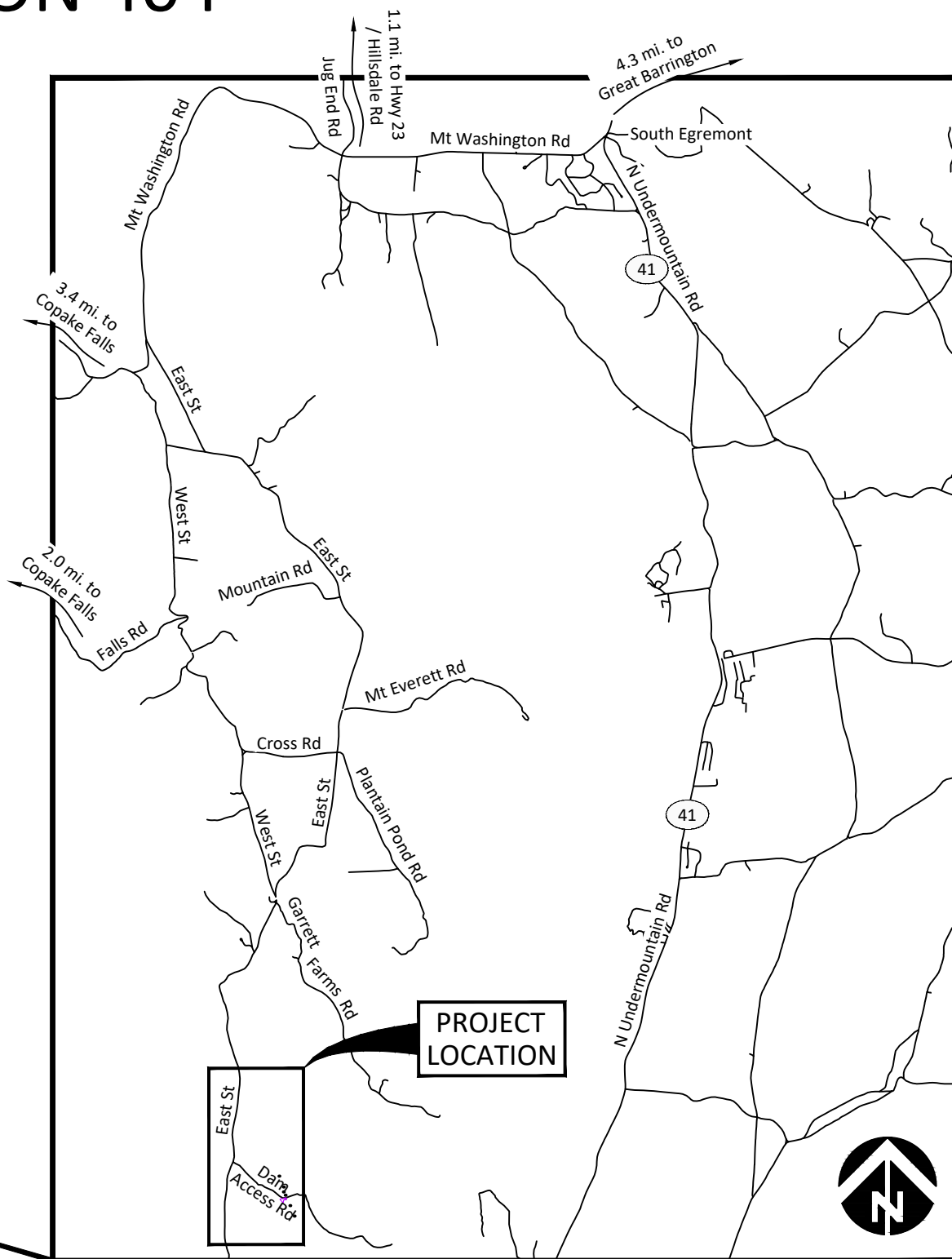
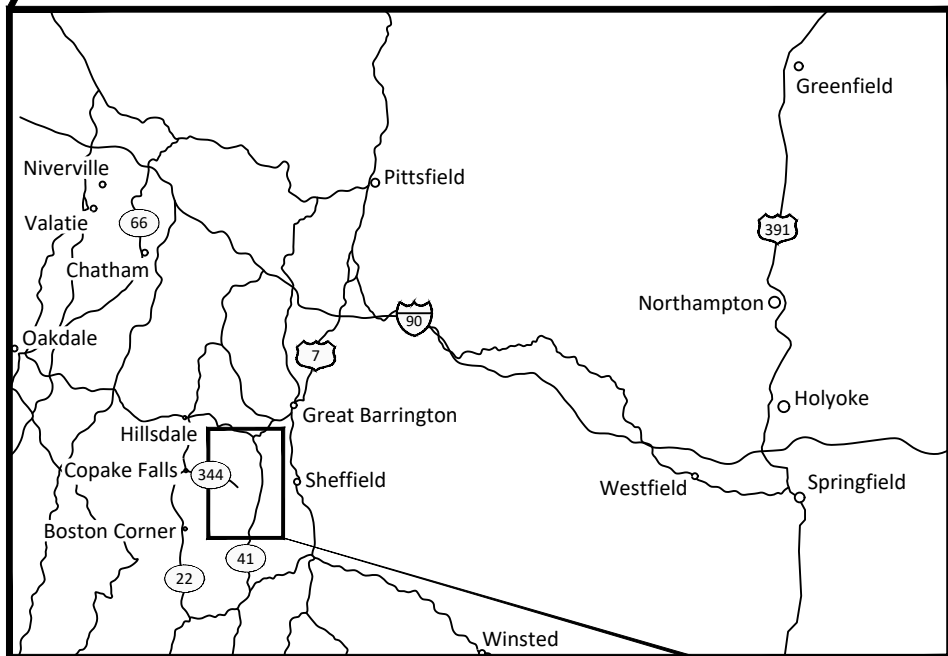

**SITE MAP**  
SCALE: 1" = 1 MI.

**SHEET INDEX**

1. COVER - SITE MAP AND SHEET INDEX
2. EXISTING CONDITIONS, OWNERSHIP AND SURVEY CONTROL
3. PROJECT AREA PLAN & PROFILE: ORDINARY HIGH WATER AND EXISTING WETLANDS
4. SECTION VIEWS (1 OF 2): ORDINARY HIGH WATER
5. SECTION VIEWS (2 OF 2): ORDINARY HIGH WATER
6. RESOURCE AREA IMPACTS

**MOUNT PLANTAIN PRESERVE**  
OWNER: THE NATURE CONSERVANCY

**COORDINATES:**  
LATITUDE 42°03'29.88" N  
LONGITUDE 73°27'33.12" W

**MOUNT WASHINGTON, BERKSHIRE COUNTY, MASSACHUSETTS**

**WATERBODY:** BECKER POND  
**TRIBUTARY OF:** SHENOB BROOK AND HOUSATONIC RIVER

SHEET PROVIDED FOR PROJECT PERMITTING ONLY. NOT FOR USE IN PROJECT CONSTRUCTION.

F:\INTERFLUVE\Boston\Drawings\NEL\BeckerPond.dwg - sjohnson - 9/26/22

NO.	BY	DATE	REVISION DESCRIPTION

DF,SW,SJ	NN,SW	CC
DRAWN	DESIGNED	CHECKED
SAW	09/26/2022	18-05-01
APPROVED	DATE	PROJECT

**BECKER POND DAM REMOVAL**  
**THE NATURE CONSERVANCY**  
**BERKSHIRE COUNTY, MASSACHUSETTS**



220 Concord Avenue, 2nd Floor  
Cambridge, MA 02138  
617.714.5537  
www.interfluve.com

**COVER - SITE MAP AND SHEET INDEX**

SHEET  
**1 OF 6**

### SURVEY CONTROL POINTS

PT NO	NORTHING	EASTING	ELEVATION	DESCRIPTION
100	2852371.25'	124142.01'	1620.87'	STAKE
101	2852290.85'	124078.40'	1635.07'	CAPPED REBAR
102	2852374.56'	124096.57'	1627.66'	CAPPED REBAR
103	2852422.40'	124232.01'	1626.99'	CAPPED REBAR
104	2852767.31'	124112.83'	1620.78'	STAKE
105	2852391.20'	124189.53'	1622.10'	PK NAIL
106	2852914.11'	124099.55'	1624.06'	STAKE
107	2822903.58'	124062.79'	1621.03'	STAKE
301	2853108.94'	122251.53'	1790.53'	PK NAIL

### SURVEY NOTES:

- Ground survey completed within the Limit of Survey by Inter-Fluve in April 2018 and May 2019.
- Depth of refusal survey completed within the impoundment by Inter-Fluve in April 2018.
- Contours beyond the Limits of Survey in upland areas from LiDAR Digital Elevation Model: 2016 USGS CoNED Topobathymetric Model (1887-2016) New England Dataset (obtained from NOAA June 2019).
- The horizontal coordinate system is the North American Datum of 1983 (NAD83), Massachusetts State Plane, Mainland Zone, US feet. Elevations are presented in feet and referenced to the North American Vertical Datum 1988 (NAVD88)
- Existing parcel data provided by TNC (2019) and obtained by MassGIS. Existing trail data provided by TNC (2019).
- The wetland delineation was completed by BSC Group on May 16, 2022 using handheld GPS with sub-meter accuracy.

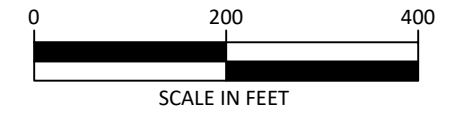
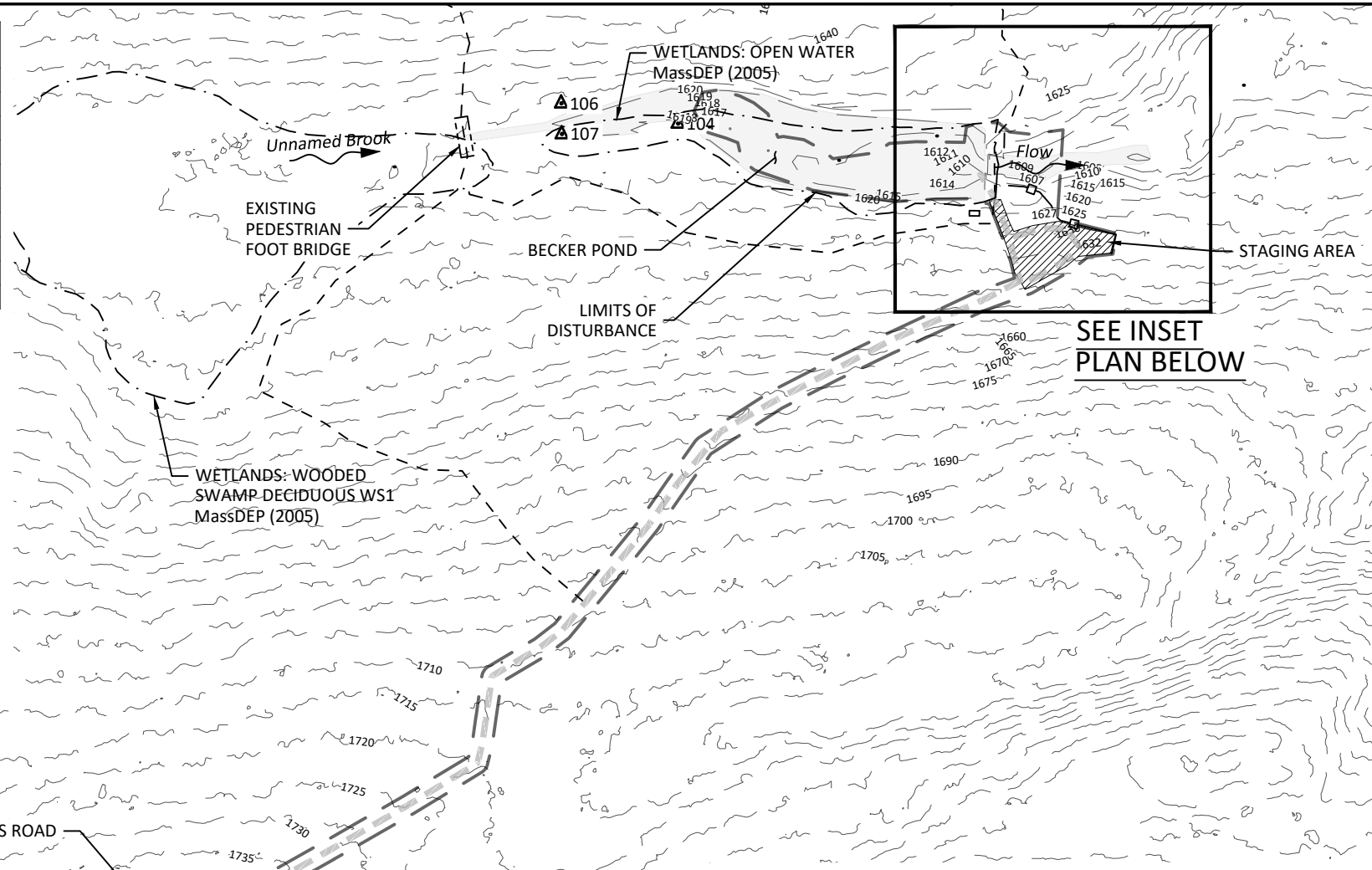

### LEGEND

- SURVEY CONTROL POINT
- EXISTING 5-FT CONTOURS
- EXISTING 1-FT CONTOURS
- PROPERTY LINE (MassGIS)
- PROPERTY LINE (TNC GIS)
- EXISTING TRAIL
- EXISTING ROAD
- FIELD DELINEATED WETLAND
- WETLANDS MassDEP (2005)
- MAP NUMBER
- LOT NUMBER
- PROPERTY OWNER
- STAGING AREAS
- SILT FENCE
- LIMITS OF DISTURBANCE
- EXISTING LAND UNDER WATER

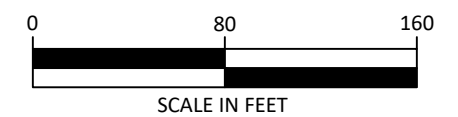
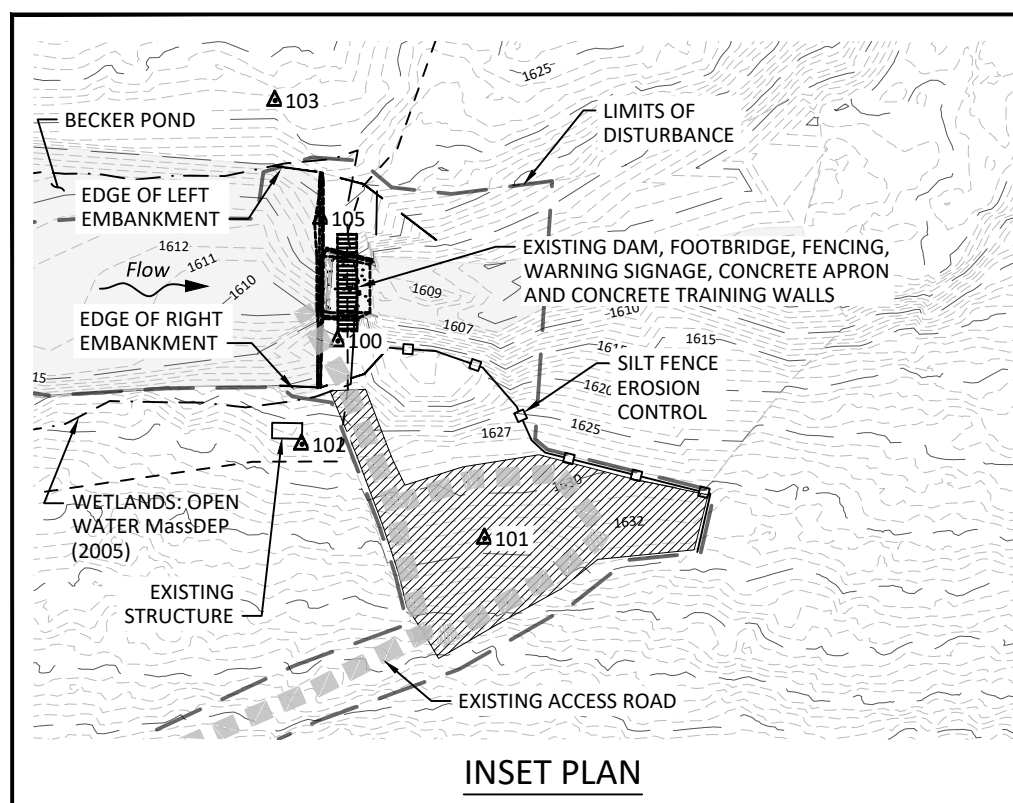
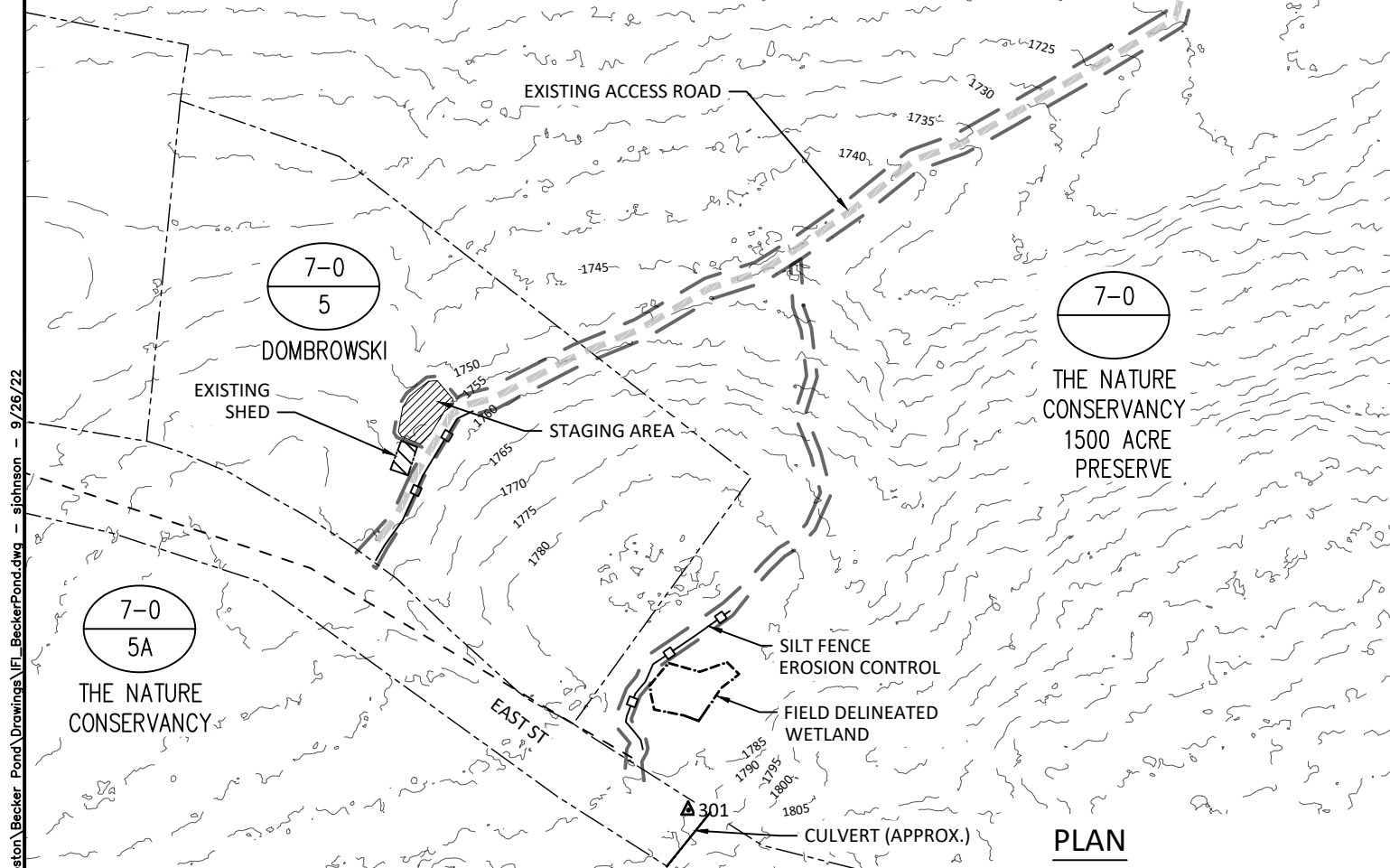

SHEET PROVIDED FOR PROJECT PERMITTING ONLY. NOT FOR USE IN PROJECT CONSTRUCTION.

NO.	BY	DATE	REVISION DESCRIPTION

DF, SW, SJ	NN, SW	CC
DRAWN	DESIGNED	CHECKED
SAW	09/26/2022	18-05-01
APPROVED	DATE	PROJECT

BECKER POND DAM REMOVAL  
THE NATURE CONSERVANCY  
BERKSHIRE COUNTY, MASSACHUSETTS



220 Concord Avenue, 2nd Floor  
Cambridge, MA 02138  
617.714.5537  
www.interfluve.com

EXISTING CONDITIONS,  
OWNERSHIP, ACCESS, STAGING  
AND SURVEY CONTROL

E:\INTERFLUVE\Boston\Becker Pond\Drawings\IFL\_BeckerPond.dwg - 9/26/22 - sjohnson

**NOTES**

- EXISTING LAND UNDER WATER IN THE IMPOUNDMENT IS BASED ON THE EXISTING EXTENTS OF OPEN WATER AS DETERMINED BY FIELD SURVEY.
- THE MassDEP WETLANDS GIS LAYER INDICATES THAT THERE IS AN OPEN WATER WETLAND ASSOCIATED WITH BECKER POND. THE WETLAND LINEWORK IS NOT DISPLAYED ON THIS SHEET BECAUSE THE HORIZONTAL RESOLUTION OF THE DATASET IS NOT SUFFICIENT TO ACCURATELY SHOW THE LOCATION OF THE RESOURCE AREA.
- LIMITS OF DISTURBANCE WITHIN THE IMPOUNDMENT FALL WITHIN THE LIMITS OF OPEN WATER AS DETERMINED BY FIELD SURVEY.

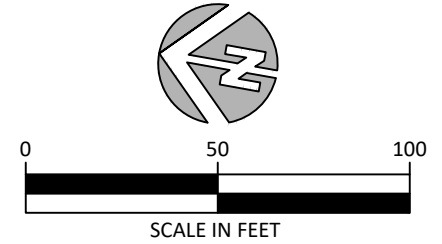

**LEGEND**

- EXISTING 1-FT CONTOURS
- EXISTING 5-FT CONTOURS
- LIMITS OF CONSTRUCTION DISTURBANCE
- EXISTING ACCESS ROAD
- EXISTING TREES INCLUDED IN SURVEY
- PROPOSED PILOT CHANNEL AND DAM REMOVAL GRADING
- LAND UNDER WATER (LUW) EXISTING CONDITIONS
- DREDGE/CUT FOOTPRINT IN OHW (16,371 SF)  
THE LENGTH OF THE DREDGE AREA IS APPROXIMATELY 454 LINEAR FEET. THE AVERAGE WIDTH OF THE DREDGE AREA IS APPROXIMATELY 36 FEET.  
THE DEPTH OF THE DREDGE AREA VARIES. REFER TO LONG PROFILE AND SECTIONS.
- FILL IN OHW (70 SF)
- LIMITS OF CONSTRUCTION PERIOD DISTURBANCE WITHIN THE LAND UNDER WATER (LUW) (25,500 SF)
- TBR: TO BE REMOVED

DREDGING AND FILL VOLUMES WITHIN OHW	
DREDGE VOLUME:	644 CY
FILL VOLUME:	0.2 CY
TEMPORARY FILL	
COFFER DAM (UPSTREAM):	20 CY
SEDIMENT TRAP RETENTION/FILTRATION STRUCTURE (DOWNSTREAM):	10 CY

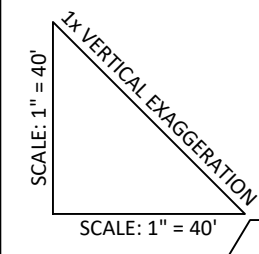

SCALE: 1" = 40'  
TIE INTO EXISTING GRADE AT UPSTREAM LIMIT OF WORK

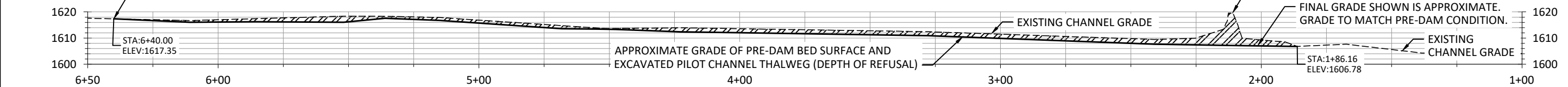

**LONGITUDINAL PROFILE - THALWEG STA 1+00 to STA 6+50**

C:\Users\stephanie\OneDrive\Documents\Projects\BeckerPondDam\_MA\Drawings\IF\BeckerPond\_remove\_stephanie\_permitting\_submittal.dwg - 12/13/23

**SHEET PROVIDED FOR PROJECT PERMITTING ONLY. NOT FOR USE IN PROJECT CONSTRUCTION.**

NO.	BY	DATE	REVISION DESCRIPTION
1	SAW	12/8/2023	RESPONSE TO AGENCY COMMENTS

DF,SW,SJ	NN,SW	CC
DRAWN	DESIGNED	CHECKED
SAW	09/26/2022	18-05-01
APPROVED	DATE	PROJECT

**BECKER POND DAM REMOVAL  
THE NATURE CONSERVANCY  
BERKSHIRE COUNTY, MASSACHUSETTS**

220 Concord Avenue, 2nd Floor  
Cambridge, MA 02138  
617.714.5537  
www.interfluve.com

**PROJECT AREA PLAN & PROFILE:  
EXISTING ORDINARY HIGH  
WATER AND WETLANDS**

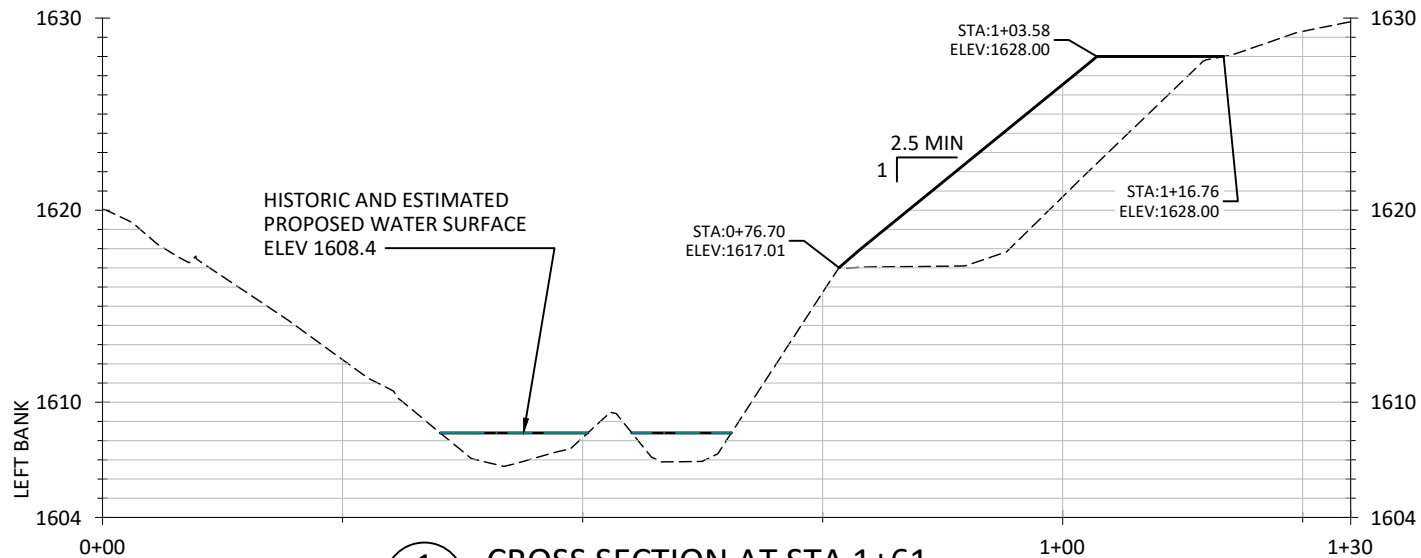

1  
4 CROSS SECTION AT STA 1+61

2x VERTICAL EXAGGERATION  
SCALE: 1" = 10'  
SCALE: 1" = 20'

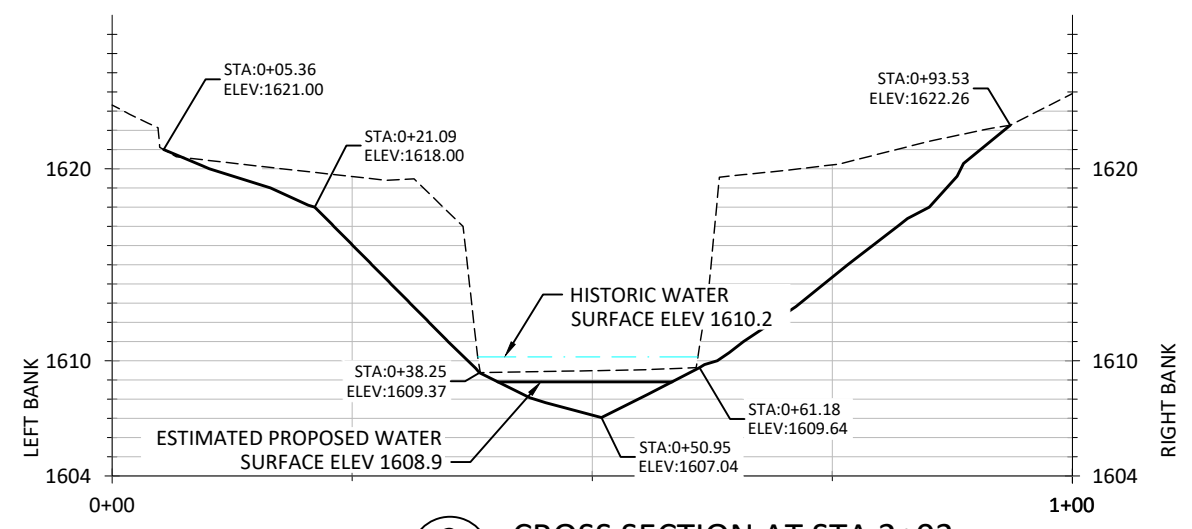

2  
4 CROSS SECTION AT STA 2+03

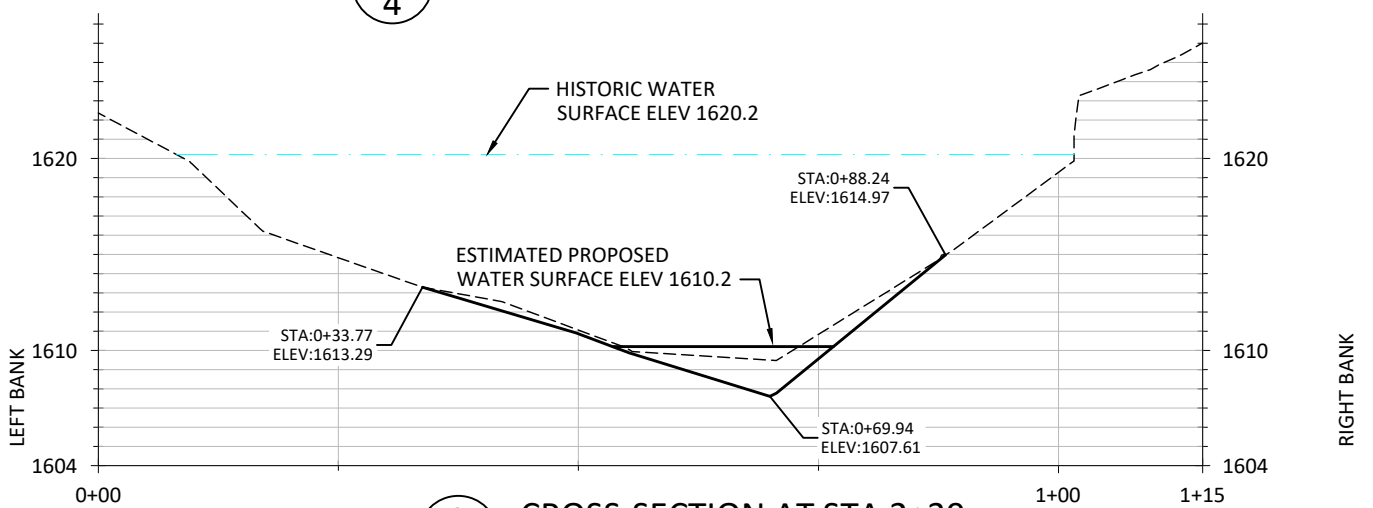

3  
4 CROSS-SECTION AT STA 2+39

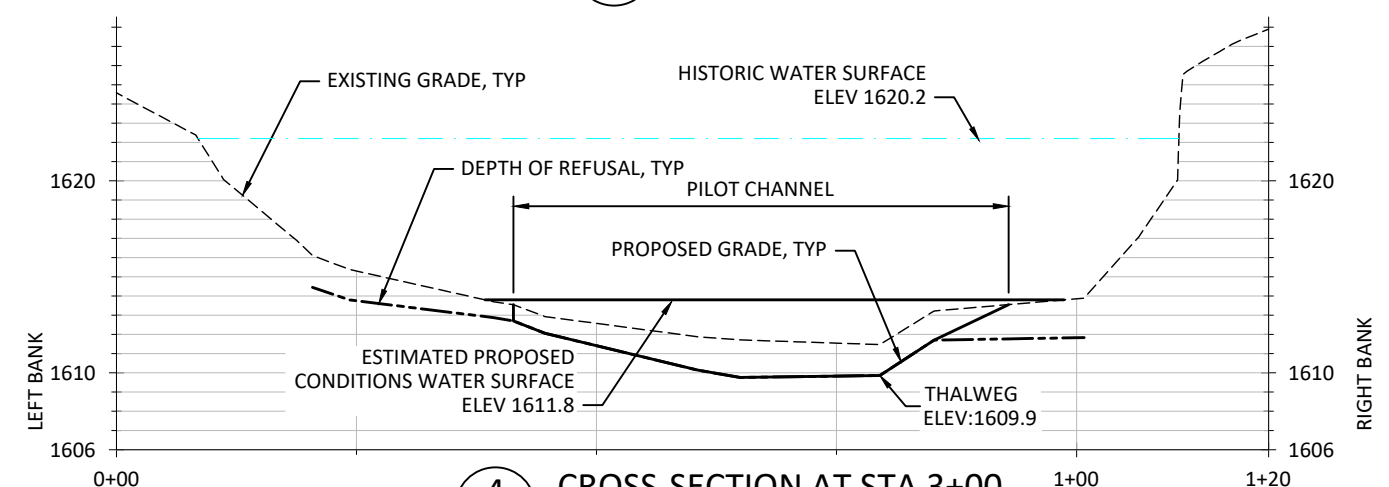

4  
4 CROSS-SECTION AT STA 3+00

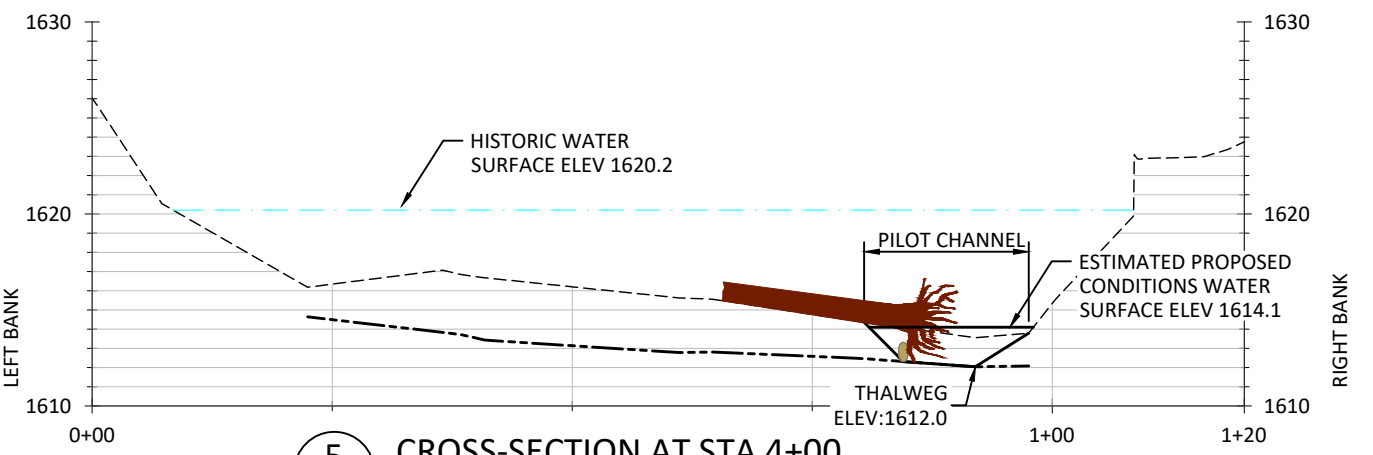

5  
4 CROSS-SECTION AT STA 4+00

NOTES:

1. SECTIONS ARE ORIENTED LEFT TO RIGHT FACING DOWNSTREAM.
2. THE PROPOSED CUT SLOPES PRESENTED ON THESE SECTIONS REPRESENT OUR BEST ESTIMATES OF THE PRE-DAM RIVER CHANNEL GEOMETRY.
3. THE PROPOSED CUT-SLOPES ARE NOT INTENDED TO BE PRESCRIPTIVE. THE INTENT OF EXCAVATION ACTIVITIES IS TO REMOVE FILL MATERIAL OR IMPOUNDED SEDIMENT THAT IS ON TOP OF THE HISTORIC NATIVE MATERIAL, WHICH IS LIKELY TO CONSIST OF COBBLES, BOULDERS, AND ROCK. IF HISTORIC NATIVE MATERIAL IS ENCOUNTERED ABOVE THE PROPOSED GRADE, IT SHALL REMAIN IN PLACE. IF HISTORIC NATIVE MATERIAL IS NOT ENCOUNTERED AT THE PROPOSED GRADE, NO FURTHER EXCAVATION IS REQUESTED.
4. THE PROPOSED CUT-SLOPES MAY BE USED TO ESTIMATE THE VOLUME OF SALVAGED MATERIAL THAT WILL NEED TO BE DISPOSED OF, EITHER IN DESIGNATED AREAS ON-SITE, OR AT OFF-SITE FACILITIES.

LEGEND

- HISTORIC OHW SURFACE
- ESTIMATED PROPOSED OHW SURFACE

OHW: ORDINARY HIGH WATER  
ALL ELEVATIONS GIVEN IN FEET NAVD88

SHEET PROVIDED FOR PROJECT PERMITTING ONLY. NOT FOR USE IN PROJECT CONSTRUCTION.

F:\INTERFLUVE\Boston\Drawings\Becker Pond\Drawings\MEL\_BeckerPond.dwg - sjohnson - 9/26/22

NO.	BY	DATE	REVISION DESCRIPTION

DF,SW,SJ DRAWN SAW APPROVED	NN,SW DESIGNED 09/26/2022 DATE	CC CHECKED 18-05-01 PROJECT
--------------------------------------	---	--------------------------------------

BECKER POND DAM REMOVAL  
THE NATURE CONSERVANCY  
BERKSHIRE COUNTY, MASSACHUSETTS



220 Concord Avenue, 2nd Floor  
Cambridge, MA 02138  
617.714.5537  
www.interfluve.com

DAM REMOVAL GRADING  
CROSS SECTIONS

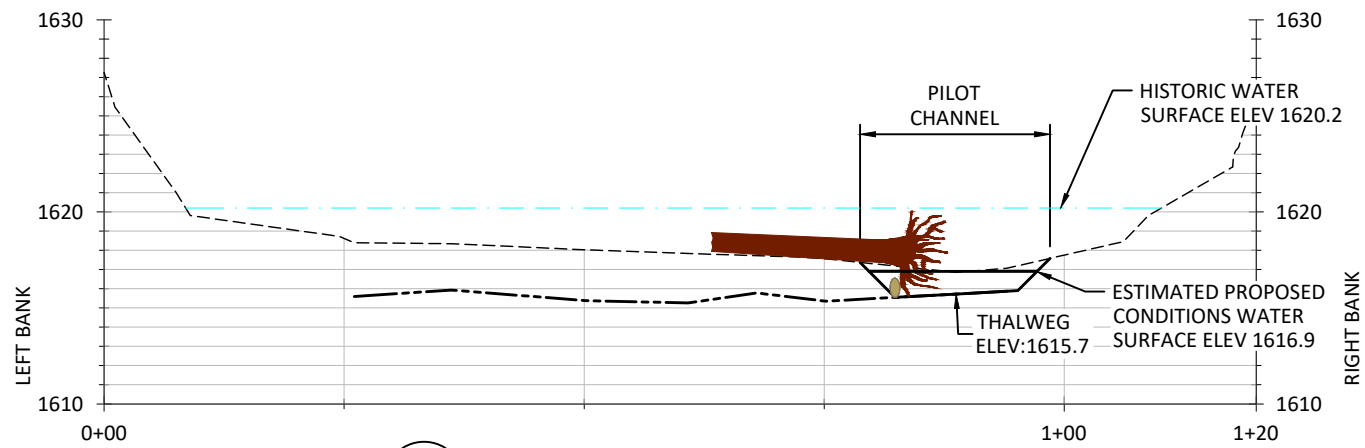

6  
5 CROSS-SECTION AT STA 5+00

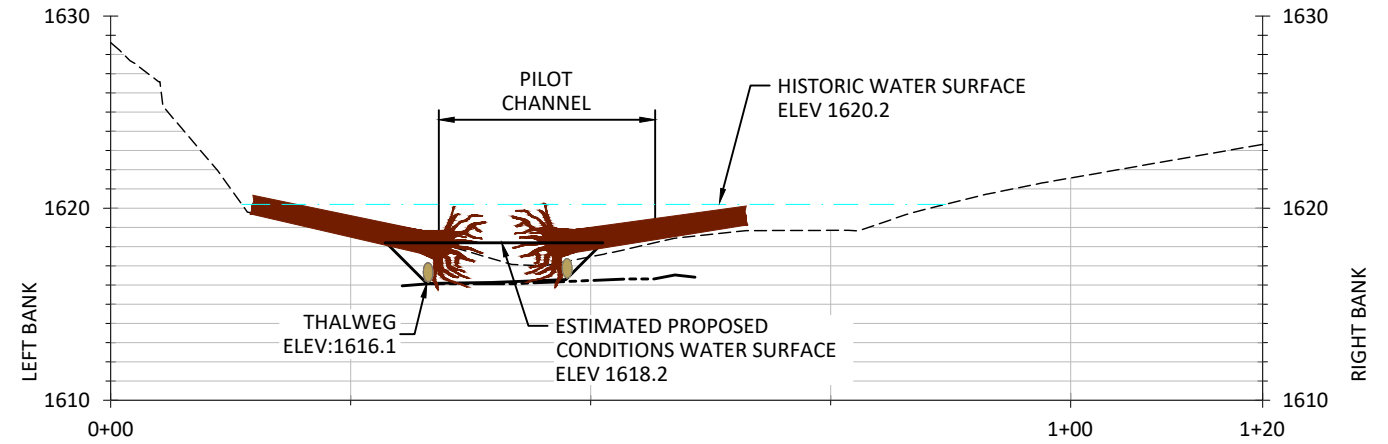

7  
5 CROSS-SECTION AT STA 6+00

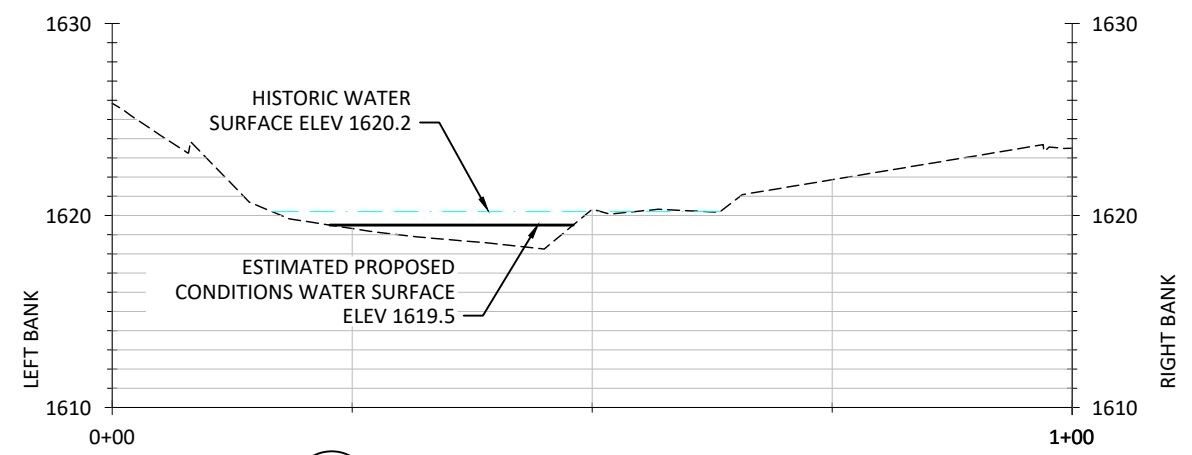

8  
5 CROSS-SECTION AT STA 7+00

2x VERTICAL EXAGGERATION  
SCALE: 1" = 10'  
SCALE: 1" = 20'

**LEGEND**

- - - HISTORIC OHW SURFACE
- ESTIMATED PROPOSED OHW SURFACE

OHW: ORDINARY HIGH WATER  
ALL ELEVATIONS GIVEN IN FEET NAVD88

**NOTES:**

1. SECTIONS ARE ORIENTED LEFT TO RIGHT FACING DOWNSTREAM.
2. THE PROPOSED CUT SLOPES PRESENTED ON THESE SECTIONS REPRESENT OUR BEST ESTIMATES OF THE PRE-DAM RIVER CHANNEL GEOMETRY.
3. THE PROPOSED CUT-SLOPES ARE NOT INTENDED TO BE PRESCRIPTIVE. THE INTENT OF EXCAVATION ACTIVITIES IS TO REMOVE FILL MATERIAL OR IMPOUNDED SEDIMENT THAT IS ON TOP OF THE HISTORIC NATIVE MATERIAL, WHICH IS LIKELY TO CONSIST OF COBBLES, BOULDERS, AND ROCK. IF HISTORIC NATIVE MATERIAL IS ENCOUNTERED ABOVE THE PROPOSED GRADE, IT SHALL REMAIN IN PLACE. IF HISTORIC NATIVE MATERIAL IS NOT ENCOUNTERED AT THE PROPOSED GRADE, NO FURTHER EXCAVATION IS REQUESTED.
4. THE PROPOSED CUT-SLOPES MAY BE USED TO ESTIMATE THE VOLUME OF SALVAGED MATERIAL THAT WILL NEED TO BE DISPOSED OF, EITHER IN DESIGNATED AREAS ON-SITE, OR AT OFF-SITE FACILITIES.
5. WATER SURFACE SHOWN ON SECTIONS IS THE PREDICTED 2-YEAR FLOOD.

SHEET PROVIDED FOR PROJECT PERMITTING ONLY. NOT FOR USE IN PROJECT CONSTRUCTION.

F:\INTERFLUVE\Boston\Becker\_Pond\Drawings\MFL\_BeckerPond.dwg - sjohnson - 9/26/22

NO.	BY	DATE	REVISION DESCRIPTION

DF,SW,SJ	NN,SW	CC
DRAWN	DESIGNED	CHECKED
SAW	09/26/2022	18-05-01
APPROVED	DATE	PROJECT

**BECKER POND DAM REMOVAL  
THE NATURE CONSERVANCY  
BERKSHIRE COUNTY, MASSACHUSETTS**



220 Concord Avenue, 2nd Floor  
Cambridge, MA 02138  
617.714.5537  
www.interfluve.com

**DAM REMOVAL GRADING  
CROSS SECTIONS**

**NOTES**

1. EXISTING LAND UNDER WATER IN THE IMPOUNDMENT IS BASED ON THE EXISTING EXTENTS OF OPEN WATER AS DETERMINED BY FIELD SURVEY.
2. THE MassDEP WETLANDS GIS LAYER INDICATES THAT THERE IS AN OPEN WATER WETLAND ASSOCIATED WITH BECKER POND. THE WETLAND LINEWORK IS NOT DISPLAYED ON THIS SHEET BECAUSE THE HORIZONTAL RESOLUTION OF THE DATASET IS NOT SUFFICIENT TO ACCURATELY SHOW THE LOCATION OF THE RESOURCE AREA.
3. LIMITS OF DISTURBANCE WITHIN THE IMPOUNDMENT FALL WITHIN THE LIMITS OF OPEN WATER AS DETERMINED BY FIELD SURVEY.

	Existing Resource Area Dimension	Proposed Resource Area Dimension	Net Change in Resource Area	Temporary Construction Impact*
<b>Bank (310 CMR 10.54)**</b>				
Length Left Bank (feet)	640	640	0**	140
Length Right Bank (feet)	620	620	0**	145
<b>Land Under Water (LUW) (310 CMR 10.56)</b>				
Area (square feet)	42,400	13,200	-29,200	25,500
<b>Riverfront Area (310 CMR 10.58)</b>				
Area (square feet)	n/a***	255,500	255,500	14,150
<b>Bordering Land Subject to Flooding (BLSF) (310 CMR 10.57)</b>				
Area (square feet)	6,100	14,300	8,200	530

- NOTES:**
- \* The temporary construction impact is calculated relative to the Existing Resource Area and the Limit of Disturbance.
  - \*\* 550 feet of left bank and 560 feet of right bank will be permanently relocated upon removal of the impoundment.
  - \*\*\* Riverfront Area is not applicable to the existing impoundment. Riverfront Area will be created upon removal of the impoundment.

**LEGEND**

EXISTING AND PROPOSED RESOURCE AREAS  
BANK (310CMR10.54)

- EXISTING
  - PROPOSED
- LAND UNDERWATER (310CMR10.56)
- EXISTING
  - PROPOSED
- LAND SUBJECT TO FLOODING (310CMR10.57)
- BLSF 100 — EXISTING
  - PROPOSED
- RIVERFRONT AREA (310CMR10.58)
- NEW
  - EXISTING RIVERFRONT BOUNDARY

**LEGEND**

- GENERAL
- LIMITS OF DISTURBANCE
  - EXISTING ROAD

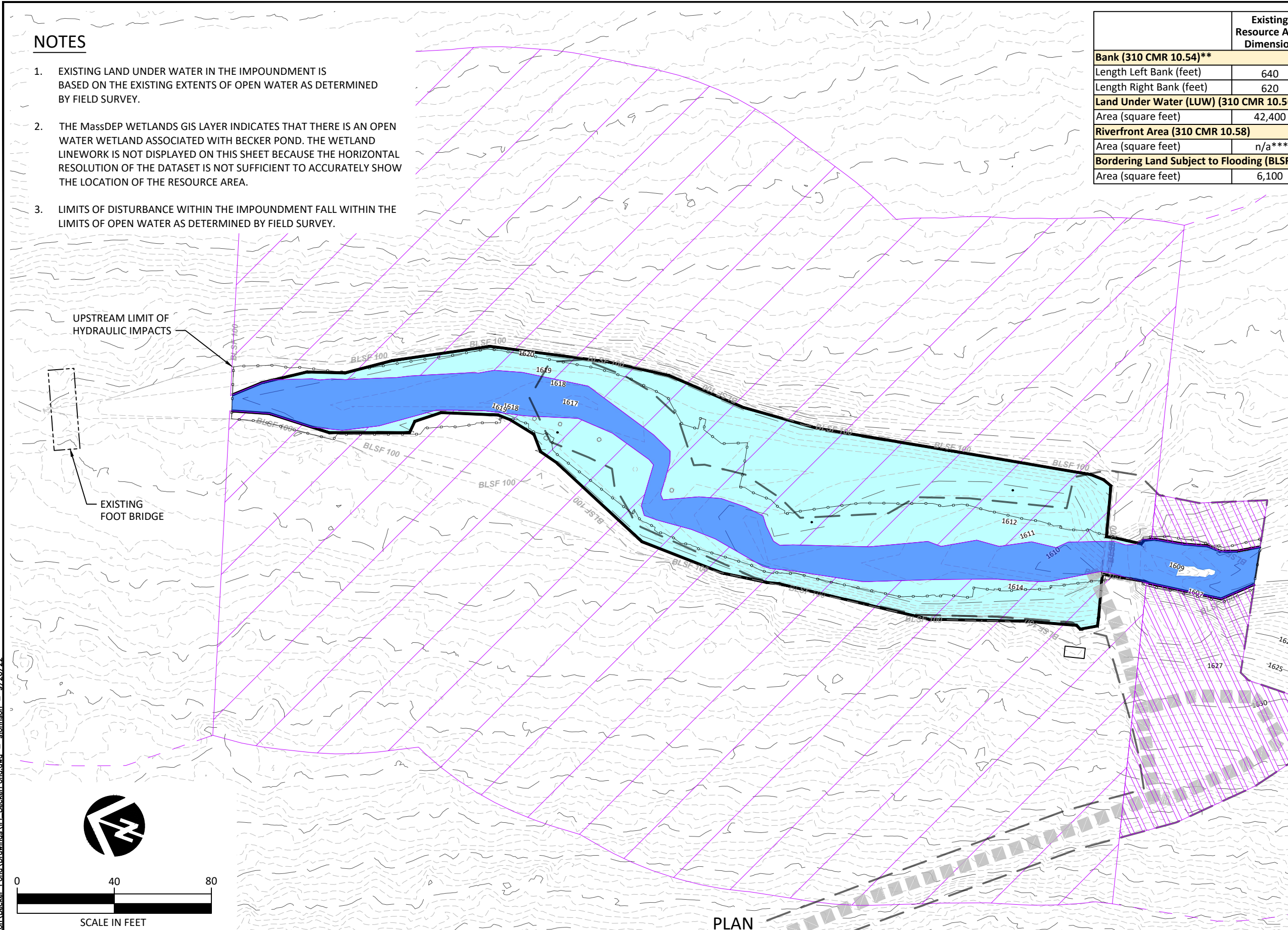

UPSTREAM LIMIT OF HYDRAULIC IMPACTS

EXISTING FOOT BRIDGE

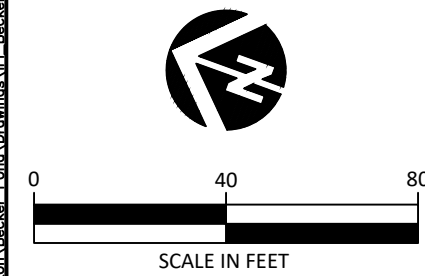

SHEET PROVIDED FOR PROJECT PERMITTING ONLY. NOT FOR USE IN PROJECT CONSTRUCTION.

E:\INTERFLUVE\Boston\Becker\_Pond\Drawings\FI\_BeckerPond.dwg - sibjohson - 9/26/22

NO.	BY	DATE	REVISION DESCRIPTION

DF,SW,SJ DRAWN	NN,SW DESIGNED	CC CHECKED
SAW	09/26/2022	18-05-01
APPROVED	DATE	PROJECT

**BECKER POND DAM REMOVAL**  
THE NATURE CONSERVANCY  
BERKSHIRE COUNTY, MASSACHUSETTS



220 Concord Avenue, 2nd Floor  
Cambridge, MA 02138  
617.714.5537  
www.interfluve.com

**RESOURCE AREA IMPACTS**