

**LIMIT OF PAVEMENT MARKINGS**

MATCH EXISTING  
RT. 156 @ STA. 0+00  
N 667209.44  
E 1132274.66

**LIMIT OF PAVEMENT MARKINGS**

MATCH EXISTING  
RT. 156 @ STA. 8+80.68  
N 667794.18  
E 1132926.92

NATIONAL RAILROAD  
PASSENGER CORP.

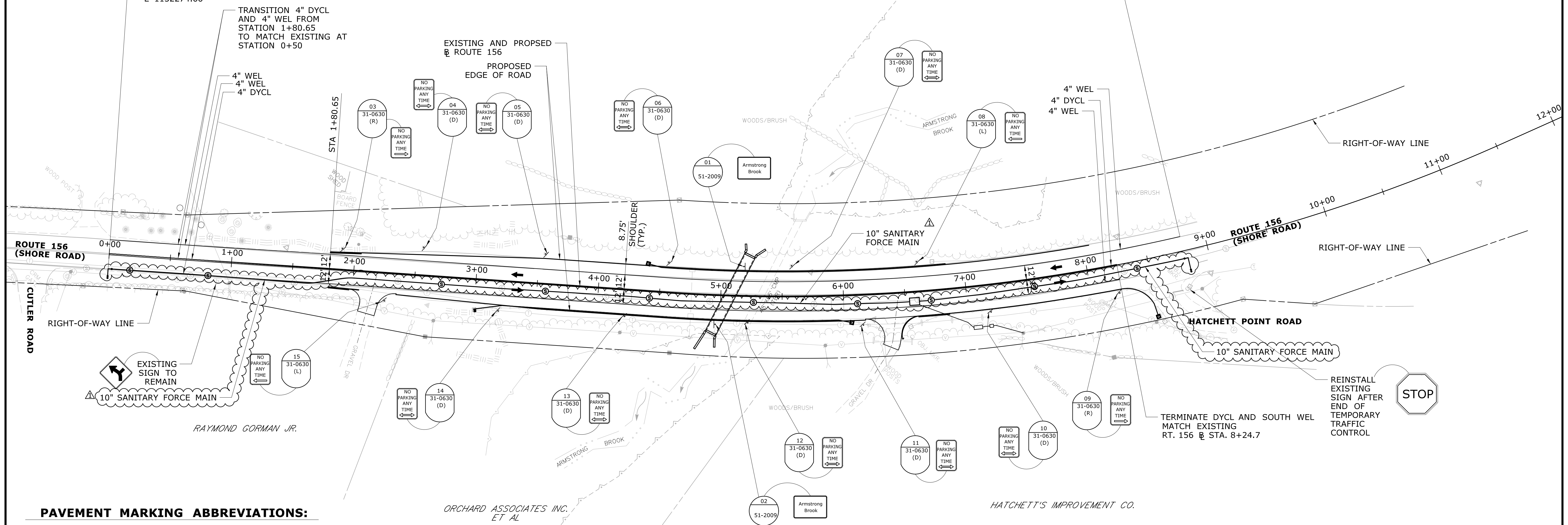

**PAVEMENT MARKING ABBREVIATIONS:**

WEL - WHITE EDGE LINE  
DYCL - DOUBLE YELLOW CENTERLINE

**PAVEMENT MARKING NOTES:**

1. ALL FINAL PAVEMENT MARKINGS ARE TO BE TYPE I EPOXY RESIN.
2. ALL PAVEMENT MARKINGS SHALL BE INSTALLED IN ACCORDANCE WITH STANDARD SHEET TR-1210-04 - PAVEMENT MARKINGS LINES AND SYMBOLS & STANDARD SHEET TR-1210-08 - PAVEMENT MARKINGS ON NON FREEWAYS, UNLESS OTHERWISE NOTED.
3. PAVEMENT MARKINGS SHALL BE INSTALLED THROUGHOUT THE PROJECT TO THE LIMIT OF PAVEMENT MARKINGS OR AS DIRECTED BY THE ENGINEER. ALL CONFLICTING PAVEMENT MARKINGS WITHIN THE LIMIT OF CONSTRUCTION ARE TO BE REMOVED. THE REMOVAL OF PAVEMENT MARKINGS IS PAID UNDER ITEM "REMOVAL OF PAVEMENT MARKINGS".
4. PAVEMENT MARKINGS THAT ARE TO REMAIN IN THEIR EXISTING LOCATION AND ARE DISTURBED BY CONSTRUCTION OPERATIONS SHALL BE REINSTALLED USING CONSTRUCTION SURVEYING.

**SIGNING NOTES:**

1. ALL EXISTING SIGNS OUTSIDE OF THE LIMITS OF CONSTRUCTION ARE TO REMAIN UNLESS OTHERWISE DIRECTED BY THE ENGINEER.
2. SIGNS SHALL BE INSTALLED IN ACCORDANCE WITH CTDOT STANDARD SHEET NO. TR-1208.01 - SIGN PLACEMENT AND RETROREFLECTIVE STRIP DETAILS, TR-1208.02 - METAL SIGN POSTS AND SIGN MOUNTING DETAILS, UNLESS OTHERWISE NOTED ON THE PLANS.
3. EXACT SIGN LOCATION TO BE VERIFIED BY THE ENGINEER.
4. ALL SIGNS ARE NEW UNLESS OTHERWISE NOTED.

DESIGNED BY:  
PRIME AE GROUP, INC.  
100 GREAT MEADOW ROAD  
6TH FLOOR  
WETHERSFIELD, CT 06109

**ADDENDUM NO. 2**

REV.	DATE	REVISION DESCRIPTION	SHEET NO.
1	1.31.25	ADD SANITARY FORCE MAIN	05.02

THE INFORMATION, INCLUDING ESTIMATED QUANTITIES OF WORK, SHOWN ON THESE SHEETS IS BASED ON LIMITED INVESTIGATIONS BY THE STATE AND IS IN NO WAY WARRANTED TO INDICATE THE CONDITIONS OF ACTUAL QUANTITIES OF WORK WHICH WILL BE REQUIRED.

DESIGNER/DRAFTER:  
E. SMITH / N. ROSSI  
CHECKED BY:  
S. ROSE  
SCALE IN FEET  
0 40 80  
SCALE 1"=40'

**STATE OF CONNECTICUT  
DEPARTMENT OF TRANSPORTATION**

File name: ...TR\_MST\_0104\_0175\_(02).Br06896.SPM.dgn

SIGNATURE/  
BLOCK:

PROJECT TITLE:  
**REPLACEMENT OF  
BRIDGE NO. 06896, ROUTE 156  
OVER ARMSTRONG BROOK**

TOWN:  
**OLD LYME**  
DRAWING TITLE:  
**SIGN AND PAVEMENT  
MARKING PLAN**

PROJECT NO.  
**104-175**  
DRAWING NO.  
**SPM-01**  
SHEET NO.  
**05.02.A2**



**NOTES**

- CONTRACTOR SHALL MAINTAIN ACCESS TO HATCHETT POINT ROAD AT ALL TIMES.
- TYPE DE-7D DELINEATORS SHALL BE INSTALLED ON THE TEMPORARY TRAFFIC BARRIER AS SPECIFIED ON THE STANDARD SHEET, "DELINEATORS, DELINEATORS AND OBJECT MARKER DETAILS," TR-1205-01.
- TEMPORARY PAVEMENT MARKINGS SHALL BE HOT-APPLIED AND INCLUDED UNDER THE CONTRACT BID ITEM PRICE FOR EACH RESPECTIVE HOT-APPLIED PAINTED PAVEMENT MARKING.
- TEMPORARY 12" STOP BAR SHALL BE INCLUDED UNDER THE CONTRACT BID ITEM PRICE FOR "HOT-APPLIED PAINTED LEGEND, ARROWS, AND MARKINGS".
- ITEM NO. 0976002 - BARRICADE WARNING LIGHTS - HIGH INTENSITY SHALL BE MOUNTED ON ALL DIAMOND SHAPED POST-MOUNTED CONSTRUCTION SIGNS.
- THE CONTRACTOR SHALL SELECT AN APPROVED SAND BARREL SYSTEM FROM THE CT DOT QUALIFIED PRODUCTS LIST (QPL). THE CONTRACTOR SHALL INSTALL BARREL ARRAY FOR 45 MPH AS RECOMMENDED BY THE MANUFACTURER. INSTALL ATTENUATOR REFLECTOR (SIGN#40-4266R OR SIGN#40-4266L) AT LEADING BARREL.
- ALL SIGNS SHALL BE POST MOUNTED WHEN FEASIBLE.
- ALL SIGNS SHOWN ON THIS SHEET SHALL BE INCLUDED IN THE CONTRACT BID ITEM PRICE FOR "CONSTRUCTION SIGNS."
- SIGN LOCATIONS SHALL BE ADJUSTED WITH RESPECT TO ROADWAY GEOMETRY AT THE DIRECTION OF THE ENGINEER.
- EXISTING SIGNS THAT CONFLICT WITH THE CONSTRUCTION SIGNING SHALL BE COVERED OR REMOVED AS DIRECTED BY THE ENGINEER AND SHALL BE UNCOVERED OR REPLACED UPON COMPLETION OF THE PROJECT. PAYMENT FOR THIS WORK SHALL BE INCLUDED UNDER THE CONTRACT BID ITEM PRICE FOR "MAINTENANCE AND PROTECTION OF TRAFFIC."
- EXACT LOCATIONS OF TRAFFIC CONTROL DEVICES ARE TO BE DETERMINED BY THE CONTRACTOR IN THE FIELD AND ADJUSTED AS DIRECTED BY THE ENGINEER.
- THE CONTRACTOR SHALL REMOVE EXISTING PAVEMENT MARKINGS IN THE CONSTRUCTION AREA. TEMPORARY PAVEMENT MARKINGS SHALL BE REPLACED WITH FINAL PAVEMENT MARKINGS UPON PROJECT COMPLETION AS SHOWN ON DWG. SPM-01 OR AS DIRECTED BY THE ENGINEER.

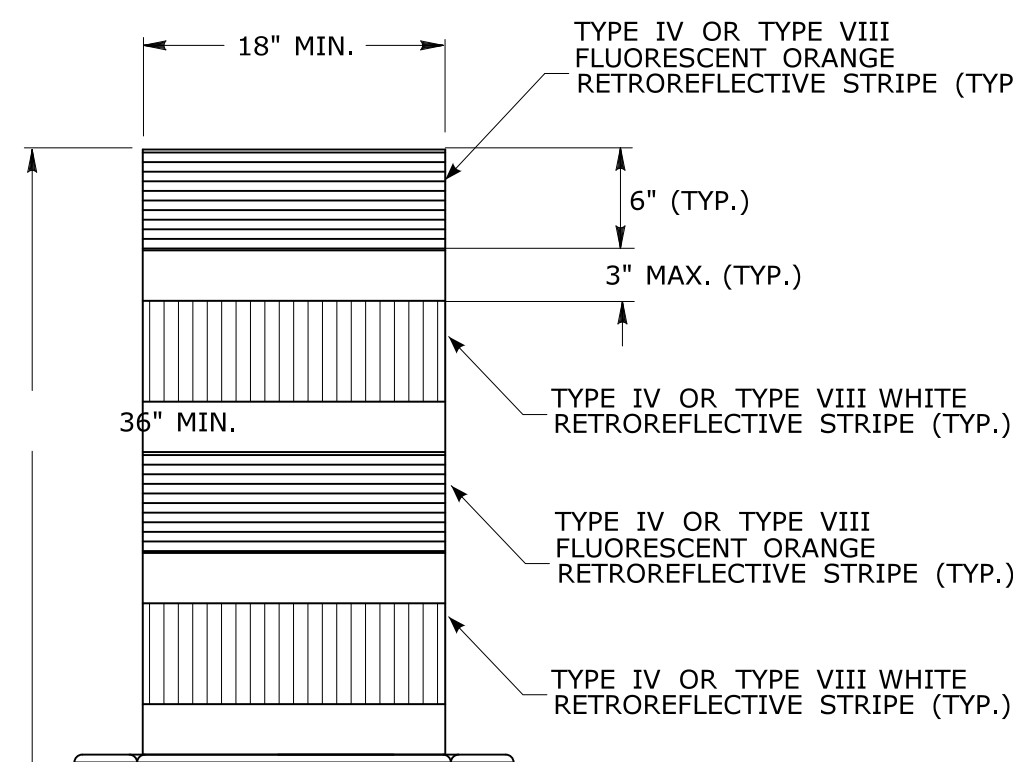

- NOTES:
- TRAFFIC DRUM SHALL CONFORM TO THE REQUIREMENTS OF NCHRP REPORT 350 (TL-3) OR THE AASHTO MASH FOR CATEGORY 1 DEVICES AND THE LATEST EDITION OF THE MUTCD. TRAFFIC DRUMS SHALL BE 40 LBS. MINIMUM WEIGHT.
  - THE ENGINEER RESERVES THE RIGHT TO REJECT ANY DRUM DEEMED UNSUITABLE FOR THE PURPOSE INTENDED.
  - THE ENTIRE AREA OF FLUORESCENT ORANGE AND WHITE STRIPES SHALL BE RETROREFLECTIVE SHEETING AS REQUIRED IN THE SPECIFICATIONS.
  - THE SECTIONS OF DRUMS NOT COVERED WITH RETROREFLECTIVE STRIPES SHALL BE ORANGE.

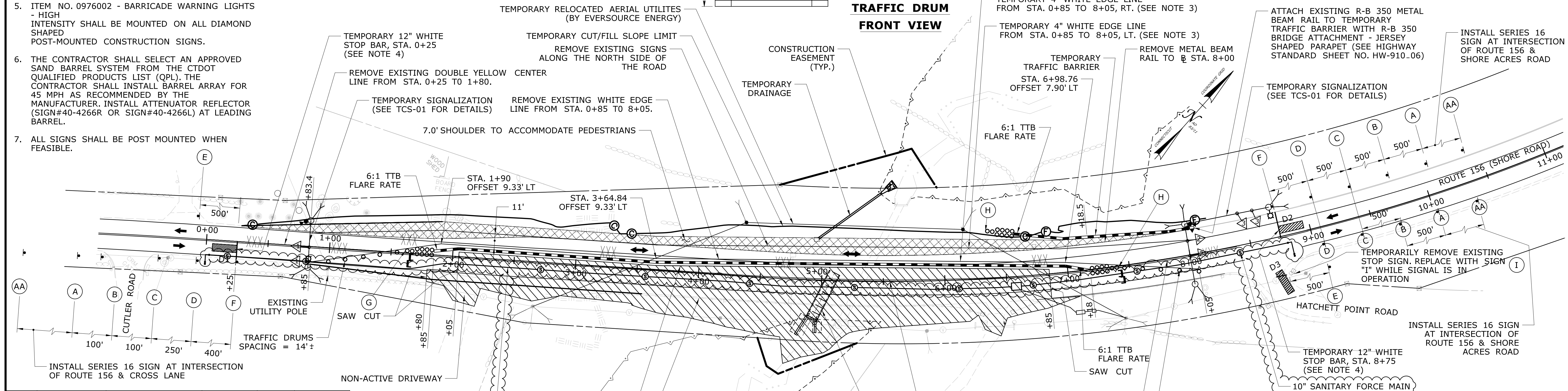
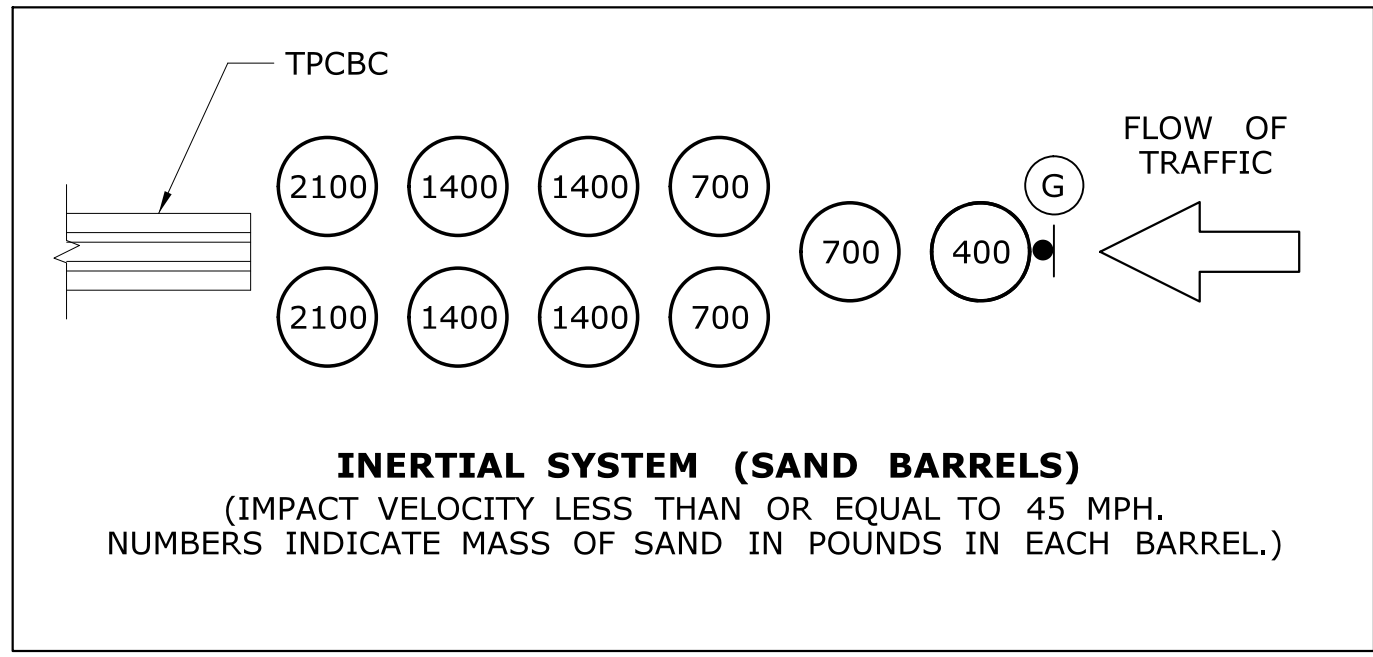

SIGN	CONN. D.O.T. NO.	SIGN DESCRIPTION	NO. REQUIRED	POSTS	SIZE (IN.)
AA	80-1608	CONSTRUCTION AHEAD ROAD AHEAD RESTRICTED TRAFFIC SIGNALS LIMITED	2	2	60" x 42"
A	31-1906	ROAD WORK AHEAD FINES DOUBLED	2	2	48" x 42"
B	80-9603	ROAD WORK AHEAD	2	1	36" x 36"
C	80-9834	ONE LANE ROAD AHEAD	2	1	36" x 36"
D	80-9052	ROAD WORK AHEAD	2	1	36" x 36"
E	80-9612	END ROAD WORK	2	2	48" x 24"
F	31-0802	STOP HERE ON RED	2	1	24" x 36"
G	40-4266R	NO TURN ON RED	1	ATTACH SIGN TO BARREL	VARIABLE

- NOTES:
- TRAFFIC CONES SHALL CONFORM TO THE REQUIREMENTS OF NCHRP REPORT 350 (TL-3) OR THE AASHTO MASH FOR CATEGORY 1 DEVICES AND THE LATEST EDITION OF THE MUTCD. TRAFFIC CONES SHALL BE 9.5 LBS. MINIMUM WEIGHT.
  - IF RUBBER CONES ARE USED, THEY SHALL HAVE INTERIOR RIBS FOR RIGIDITY.
  - IF PLASTIC CONES ARE USED, THEY SHALL BE COLOR IMPREGNATED.
  - THE ENGINEER RESERVES THE RIGHT TO REJECT ANY CONE DEEMED UNSUITABLE FOR THE PURPOSE INTENDED.
  - THE ENTIRE AREA OF WHITE STRIPES SHALL BE RETROREFLECTIVE SHEETING AS REQUIRED IN THE SPECIFICATIONS.
  - TRAFFIC CONES NOT USED AT NIGHT MAY UTILIZE TYPE III SHEETING.
  - THE SECTIONS OF CONES NOT COVERED WITH RETROREFLECTIVE STRIPES SHALL BE ORANGE.

SIGN	CONN. D.O.T. NO.	SIGN DESCRIPTION	NO. REQUIRED	POSTS	SIZE (IN.)
H	40-4266L	ATTACH SIGN TO BARREL	2	ATTACH SIGN TO BARREL	VARIABLE
I	31-0830	NO TURN ON RED	1	1	30" x 36"

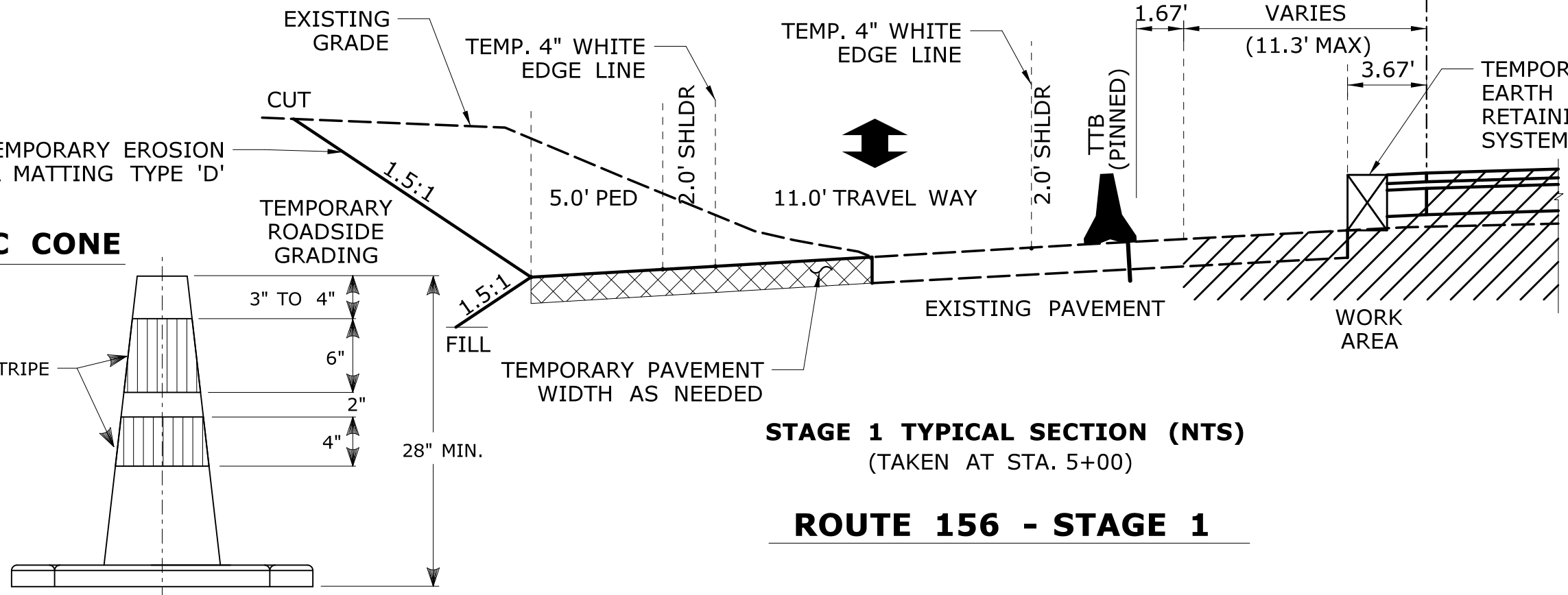

- LEGEND:**
- WORK AREA (INCLUDES FULL-DEPTH ROADWAY & GRADING AREAS)
  - TEMPORARY PAVEMENT (SEE DETAIL "TEMPORARY PAVEMENT", SUBSET 03, DWG. NO. MDS-01)
  - VIDEO DETECTION AREA
  - TEMPORARY TRAFFIC BARRIER (TTB) (PINNED) UNLESS NOTED OTHERWISE
  - CONSTRUCTION EASEMENT LINE
  - TRAFFIC FLOW
  - CONSTRUCTION BARRICADE TYPE III
  - TRAFFIC SIGNAL FACE
  - TEMPORARY SAND BARREL SYSTEM (SEE NOTE 6)
  - REMOVAL OF EXISTING PAVEMENT MARKINGS
  - WOODEN TEMPORARY SIGNAL SUPPORT
  - TEMPORARY ILLUMINATION UNIT
  - VIDEO DETECTOR
  - TRAFFIC DRUMS SIGN

ADDENDUM NO. 2

DESIGNER/DRAFTER: E. SMITH / N. ROSSI  
CHECKED BY: S. ROSE  
SCALE IN FEET: 1" = 40'

STATE OF CONNECTICUT DEPARTMENT OF TRANSPORTATION

PRIME AL

REPLACEMENT OF BRIDGE NO. 06896, ROUTE 156 OVER ARMSTRONG BROOK

OLD LYME

TRAFFIC CONTROL PLAN - 1

PROJECT NO. 104-175  
DRAWING NO. TCP-01  
SHEET NO. 05.03.A2

REV. DATE: 1.31.25  
REVISION DESCRIPTION: ADD SANITARY FORCE MAIN  
SHEET NO.: 05.03

Plotted Date: 2/6/2025

Filename: ...TR\_MST\_0104\_0175\_(03)\_Br06896\_TCP-01.dgn



**NOTES**

- REFER TO NOTES AND TEMPORARY SIGNALIZATION NOTES ON DWG. TCP-01.

**NOTES:**

- TRAFFIC CONES SHALL CONFORM TO THE REQUIREMENTS OF NCHRP REPORT 350 (TL-3) OR THE AASHTO MASH FOR CATEGORY 1 DEVICES AND THE LATEST EDITION OF THE MUTCD. TRAFFIC CONES SHALL BE 9.5 LBS MINIMUM WEIGHT.
- IF RUBBER CONES ARE USED, THEY SHALL HAVE INTERIOR RIBS FOR RIGIDITY.
- IF PLASTIC CONES ARE USED, THEY SHALL BE COLOR IMPREGNATED.
- THE ENGINEER RESERVES THE RIGHT TO REJECT ANY CONE DEEMED UNSUITABLE FOR THE PURPOSE INTENDED.
- THE ENTIRE AREA OF WHITE STRIPES SHALL BE RETROREFLECTIVE SHEETING AS REQUIRED IN THE SPECIFICATIONS.
- TRAFFIC CONES NOT USED AT NIGHT MAY UTILIZE TYPE III SHEETING.
- THE SECTIONS OF CONES NOT COVERED WITH RETROREFLECTIVE STRIPES SHALL BE ORANGE. ATTACH EXISTING R-B 350 METAL BEAM RAIL TO TEMPORARY TRAFFIC BARRIER WITH R-B 350 BRIDGE ATTACHMENT - JERSEY SHAPED PARAPET INSTALLED IN STAGE 1 (SEE HIGHWAY STANDARD SHEET NO. HW-910-06)

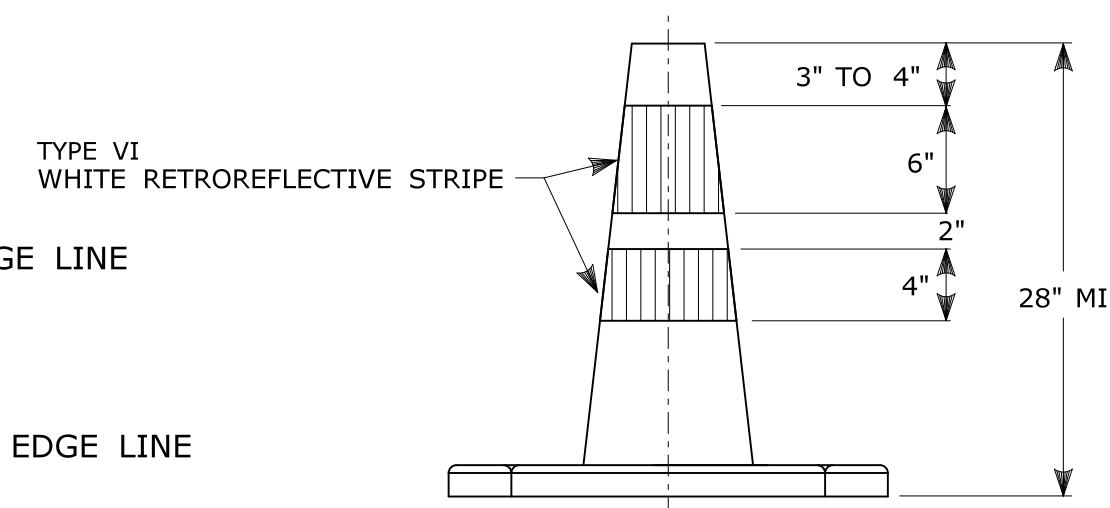

**TRAFFIC CONE**

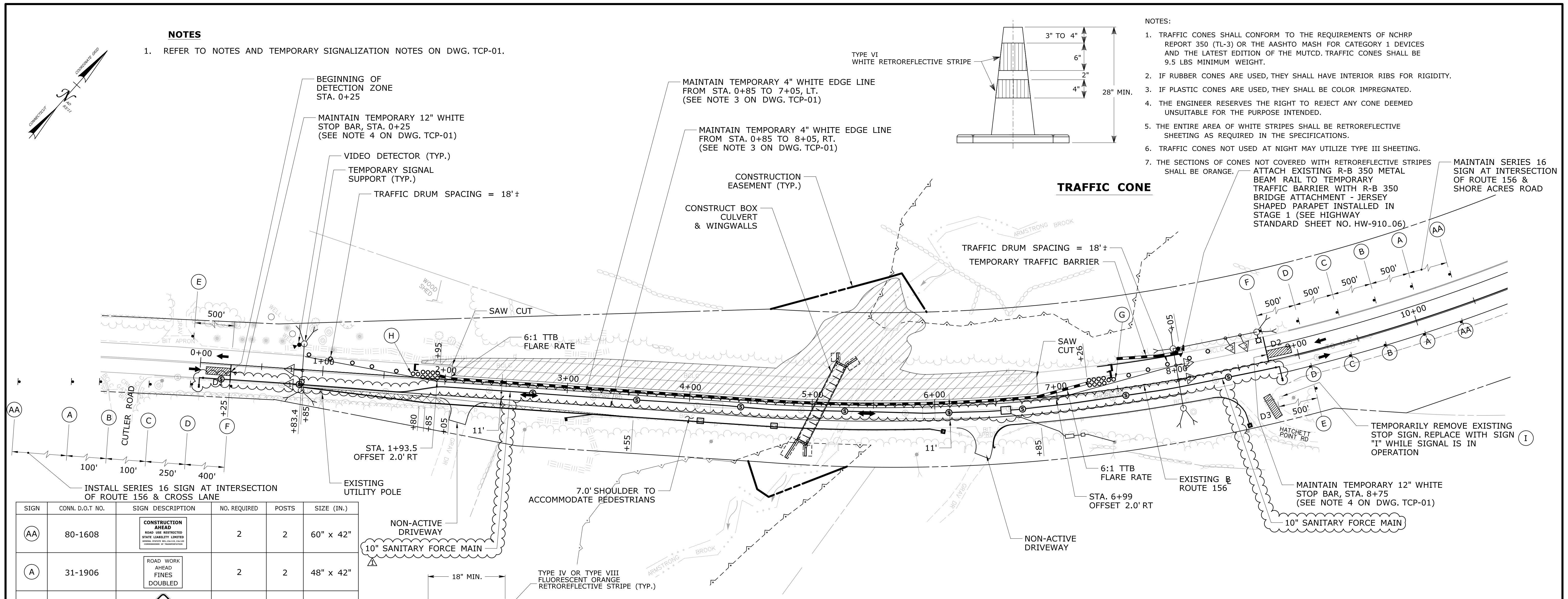

SIGN	CONN. D.O.T NO.	SIGN DESCRIPTION	NO. REQUIRED	POSTS	SIZE (IN.)
(AA)	80-1608	CONSTRUCTION AHEAD ROAD USE RESTRICTED (SEE LEGEND)	2	2	60" X 42"
(A)	31-1906	ROAD WORK AHEAD FINES DOUBLED	2	2	48" X 42"
(B)	80-9603	ROAD WORK AHEAD	2	1	36" X 36"
(C)	80-9834	ONE LANE ROAD AHEAD	2	1	36" X 36"
(D)	80-9052	TRAFFIC SIGNAL AHEAD	2	1	36" X 36"
(E)	80-9612	END ROAD WORK	2	2	48" X 24"
(F)	31-0802	STOP HERE ON RED	2	1	24" X 36"
(G)	40-4266R	DIAGONAL STRIPES	1	ATTACH SIGN TO BARREL	VARIABLE
(H)	40-4266L	DIAGONAL STRIPES	1	ATTACH SIGN TO BARREL	VARIABLE
(I)	31-0830	NO TURN ON RED	1	1	30" X 36"

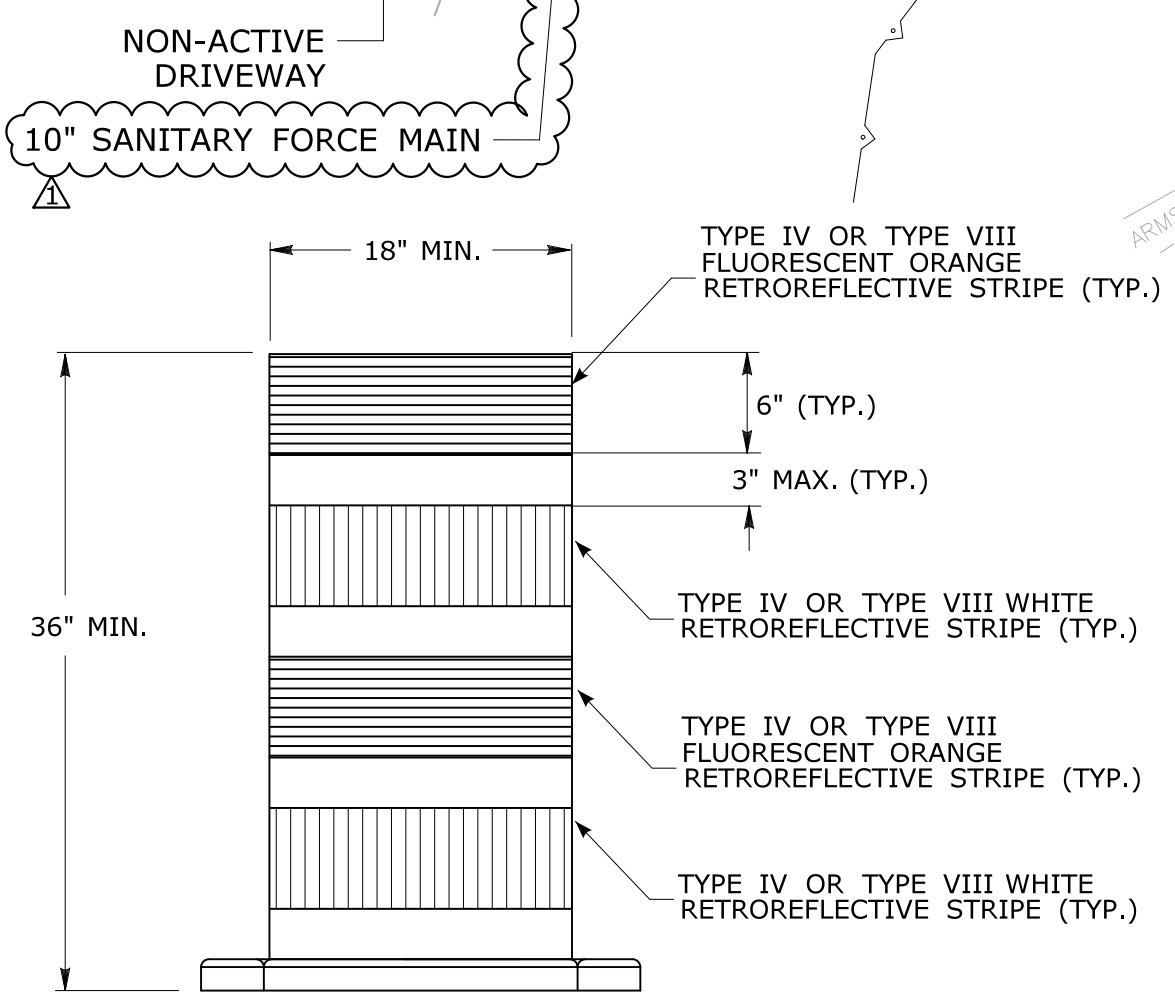

- NOTES:**
- TRAFFIC DRUM SHALL CONFORM TO THE REQUIREMENTS OF NCHRP REPORT 350 (TL-3) OR THE AASHTO MASH FOR CATEGORY 1 DEVICES AND THE LATEST EDITION OF THE MUTCD. TRAFFIC DRUMS SHALL BE 40 LBS. MINIMUM WEIGHT.
  - THE ENGINEER RESERVES THE RIGHT TO REJECT ANY DRUM DEEMED UNSUITABLE FOR THE PURPOSE INTENDED.
  - THE ENTIRE AREA OF FLUORESCENT ORANGE AND WHITE STRIPES SHALL BE RETROREFLECTIVE SHEETING AS REQUIRED IN THE SPECIFICATIONS.
  - THE SECTIONS OF DRUMS NOT COVERED WITH RETROREFLECTIVE STRIPES SHALL BE ORANGE.

**TRAFFIC DRUM FRONT VIEW**

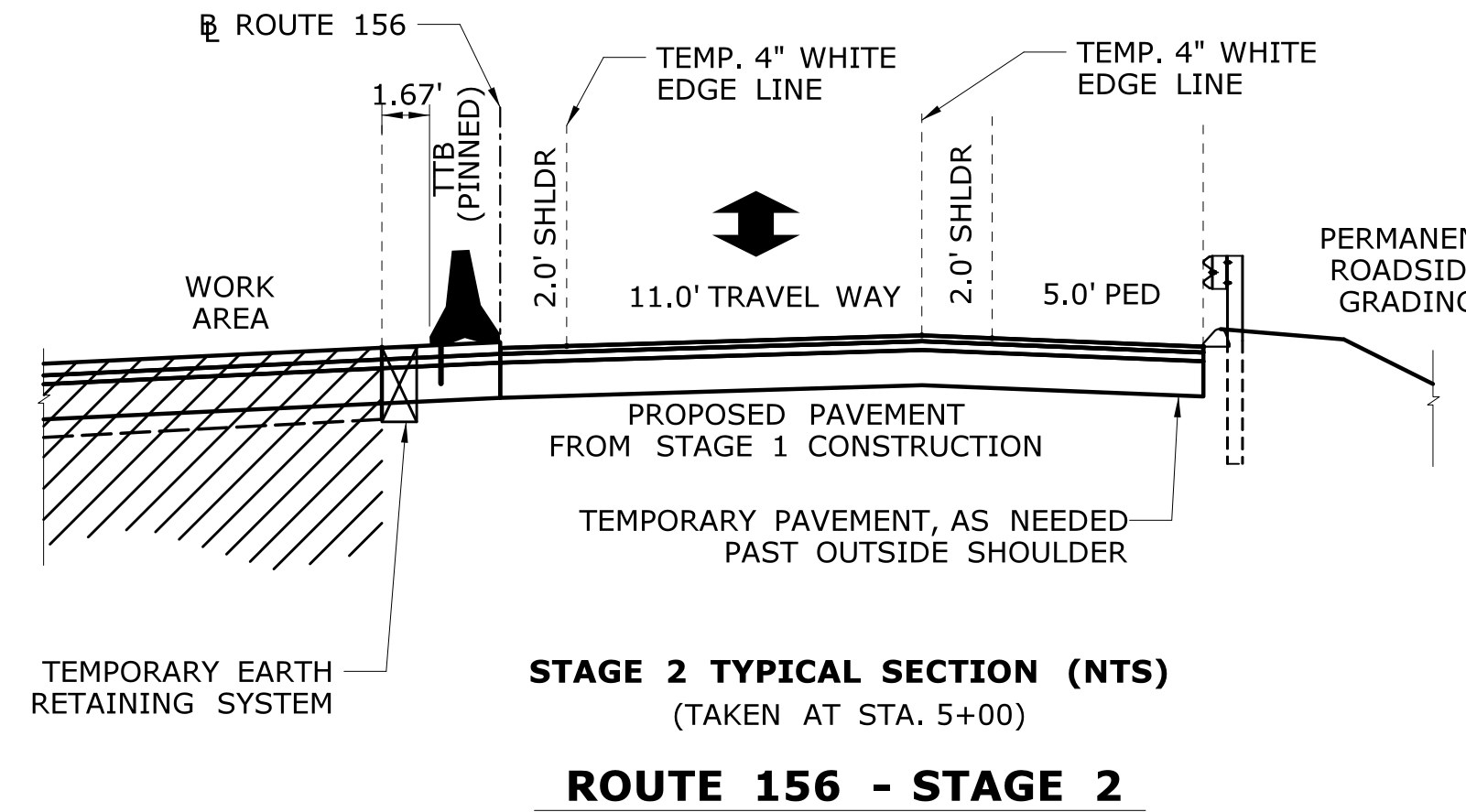

**STAGE 2 TYPICAL SECTION (NTS)  
ROUTE 156 - STAGE 2**

**LEGEND:**

	WORK AREA (INCLUDES FULL-DEPTH ROADWAY & GRADING AREAS)
	TEMPORARY PAVEMENT (SEE DETAIL "TEMPORARY PAVEMENT", SUBSET 03, DWG. NO. MDS-01)
	VIDEO DETECTION AREA
	RELOCATED TEMPORARY TRAFFIC BARRIER (TTB) (PINNED) UNLESS NOTED OTHERWISE
	TRAFFIC FLOW
	CONSTRUCTION BARRICADE TYPE III
	TRAFFIC SIGNAL FACE
	TEMPORARY SAND BARREL SYSTEM (SEE NOTE 6 ON DWG. TCP-01)
	REMOVAL OF EXISTING PAVEMENT MARKINGS
	WOODEN TEMPORARY SIGNAL SUPPORT
	TEMPORARY ILLUMINATION UNIT
	VIDEO DETECTOR
	TRAFFIC DRUMS
	SIGN

**ADDENDUM NO. 2**

REV.	DATE	REVISION DESCRIPTION	SHEET NO.
1	1.31.25	ADD SANITARY FORCE MAIN	05.04

THE INFORMATION, INCLUDING ESTIMATED QUANTITIES OF WORK SHOWN ON THESE SHEETS IS BASED ON LIMITED INVESTIGATIONS BY THE STATE AND IS IN NO WAY WARRANTED TO INDICATE THE CONDITIONS OF ACTUAL QUANTITIES OF WORK WHICH WILL BE REQUIRED.

DESIGNER/DRAFTER:  
**E. SMITH / N. ROSSI**  
CHECKED BY:  
**S. ROSE**  
SCALE IN FEET  
0 40 80  
SCALE 1"=40'

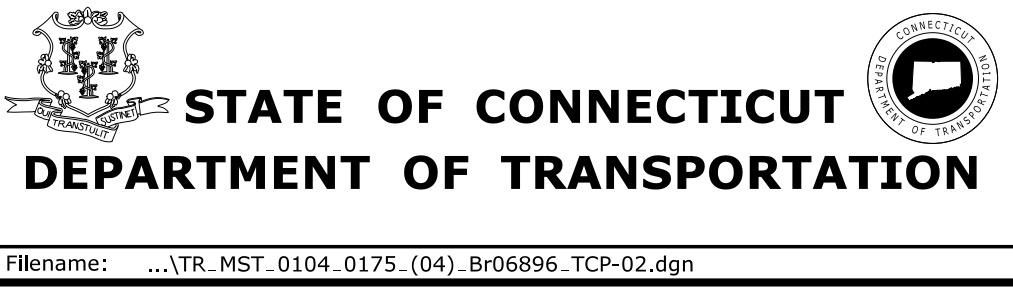

PROJECT TITLE:  
**REPLACEMENT OF  
BRIDGE NO. 06896, ROUTE 156  
OVER ARMSTRONG BROOK**

TOWN:  
**OLD LYME**  
DRAWING TITLE:  
**TRAFFIC CONTROL  
PLAN - 2**

PROJECT NO.  
**104-175**  
DRAWING NO.  
**TCP-02**  
SHEET NO.  
**05.04.A2**



MOVEMENT DIAGRAM																									
NTOR	PHASE 1			PHASE 2			PHASE 3			PHASE 4			PHASE 5			PHASE 6			PHASE 7			PHASE 8			
	1			2			3																		
	FLASH	GRN	CL	CL	GRN	CL	CL	GRN	CL	CL	GRN	CL	CL	GRN	CL	CL	GRN	CL	CL	GRN	CL	CL	GRN	CL	CL
F	1	R	G	Y	R	R	R	R	R	R	R	R	R	R	R	R	R	R	R	R	R	R	R	R	R
A	2	R	R	R	R	G	Y	R	R	R	R	R	R	R	R	R	R	R	R	R	R	R	R	R	R
C	3	R	R	R	R	R	R	G	Y	R	R	R	R	R	R	R	R	R	R	R	R	R	R	R	R
E																									
#																									

TECHNICAL NOTES				REV #	OFFICE RECORD	SM #	SIGNAL REVISED:
STANDARD OVERLAP SKIP FEATURES APPLY PHASE 4 TO ALWAYS FOLLOW PHASE 2 OR PHSE 3							

DETECTORS			
IDENT	SIZE (WXL)	TYPE	MODE
D1	6' X 20'	VIDEO	PRESENCE
D2	6' X 20'	VIDEO	PRESENCE
D3	6' X 20'	VIDEO	PRESENCE

INTERVALS			
	MIN GRN	WALK	PED CLR
PHASE 1	7		
PHASE 2	7		
PHASE 3	5		
PHASE 4			
PHASE 5			
PHASE 6			
PHASE 7			
PHASE 8			

MODE	MIN. RECALL	NON-LOCK	NON-LOCK	LOCK
INIT START	THIS PHASE			

PRE-EMPTION SETTINGS	PRE-EMPT
PRIORITY	1
DET. LOCK	NO
DELAY	0
ALT. MIN. GRN	15
ALT. YELLOW	PARENT
ALT. RED	PARENT
ALT. PED CLR.	PARENT
HOLD GREEN	16
HOLD YELLOW	3.5
HOLD RED	1.5
HOLD PHASE	1
EXIT PHASE	2
EXIT CALL	NONE

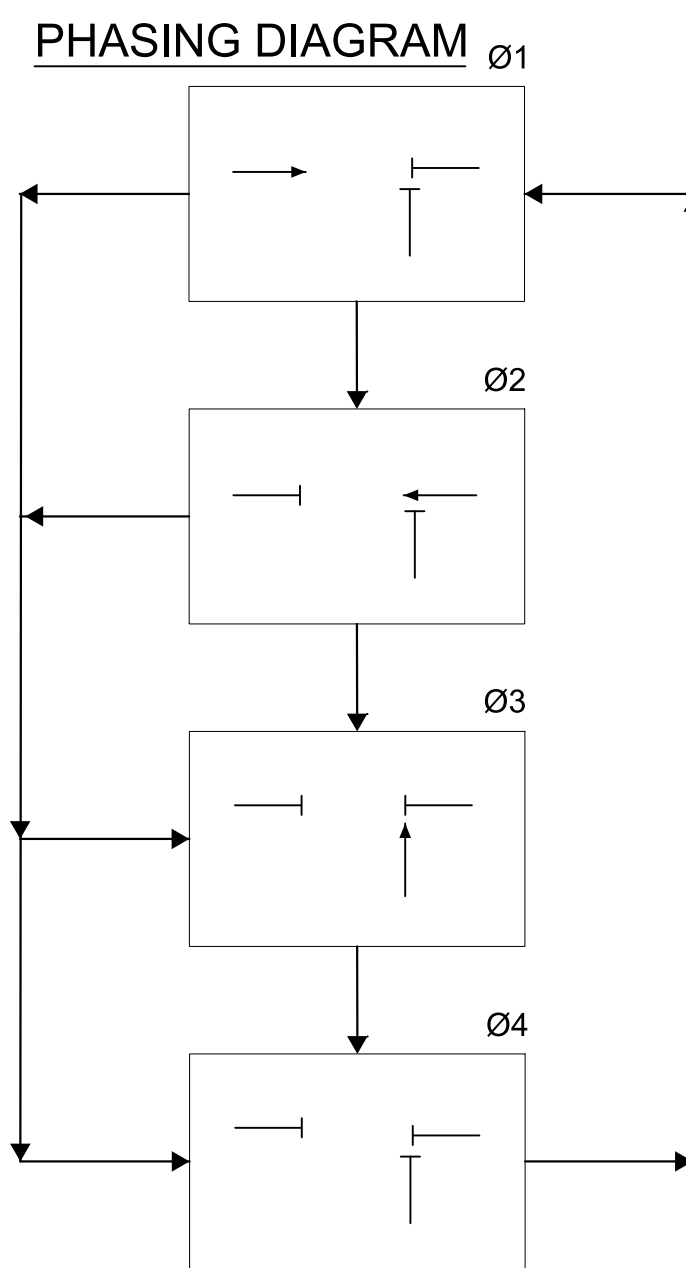
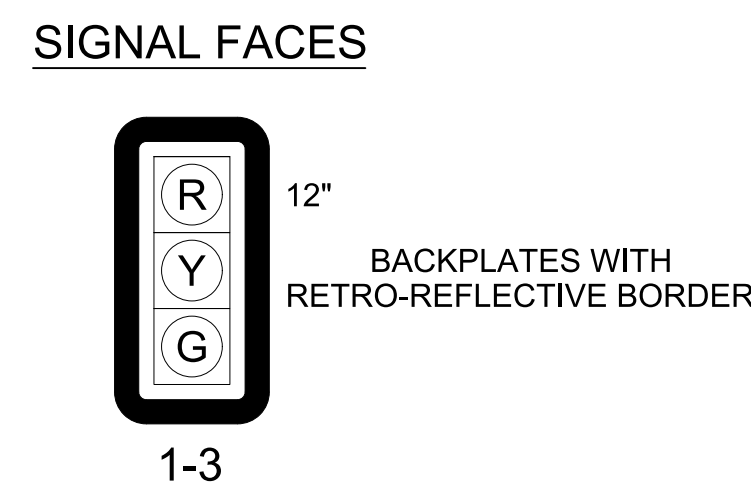

**CONSTRUCTION NOTES**

- SEE SPECIAL PROVISION ITEM NO. 1118101A - TEMPORARY SIGNALIZATION FOR ADDITIONAL INFORMATION.
- TEMPORARY WOODEN SPAN POLE LOCATIONS ARE APPROXIMATE. ACTUAL LOCATIONS SHALL BE FIELD LOCATED.
- TEMPORARY WOODEN SPAN POLES SHALL BE LOCATED NO LESS THAN 2 FEET FROM THE EDGE OF ROAD.
- EXACT LOCATIONS OF TRAFFIC CONTROL DEVICES ARE TO BE DETERMINED BY THE CONTRACTOR IN THE FIELD AND ADJUSTED AS DIRECTED BY THE ENGINEER.
- THE CONTRACTOR SHALL BE RESPONSIBLE FOR CONTACTING AND COORDINATING WITH THE RESPECTIVE UTILITY COMPANY FOR TEMPORARY SIGNALIZATION. UTILITY CONTACT INFORMATION CAN BE FOUND IN THE CONTRACT DOCUMENTS.
- TEMPORARY TRAFFIC SIGNAL SHALL BE MAINTAINED DURING ALL STAGES OF CONSTRUCTION INCLUDING RELOCATIONS OF TRAFFIC SIGNAL APPURTENANCES THAT MAY BE NECESSARY.
- ENSURE THAT A MINIMUM OF 16 FEET OVERHEAD CLEARANCE FOR THE SIGNAL HEADS ABOVE THE ROADWAY IS MAINTAINED PER THE DEPARTMENT'S TRAFFIC CONTROL SIGNAL DESIGN MANUAL.
- ALL TEMPORARY TRAFFIC SIGNAL APPURTENANCES SHALL BE REMOVED UPON COMPLETION OF WORK, AND AREAS RESTORED TO ORIGINAL CONDITION.

**NOTES**

- TEMPORARY TRAFFIC CONTROL SIGNAL PLAN SHOWN IS FOR STAGES 1 AND 2. TRAFFIC CONTROL PLAN FOR STAGE 1 IS SHOWN ON THIS SHEET FOR REFERENCE. SEE DRAWINGS "TRAFFIC CONTROL PLAN - 1" AND "TRAFFIC CONTROL PLAN - 2" FOR TRAFFIC CONTROL DETAILS.
- PROVIDE AUDIBLE SIGNAL PREEMPTION COMPATIBLE WITH OLD LYME FIRE DEPARTMENT. PREEMPTION MUST HAVE MANUAL OPERATION CAPABILITIES. AUDIBLE PREEMPTION WILL COINCIDE WITH "DUMMY PHASE." A PRE-EMPTION BLOCK SHOULD BE PROVIDED ON THIS PLAN.
- PROVIDE OLD LYME FIRE MARSHALL, DAVE ROBERGE (CELL: 860-662-1339) ENTRY TO THE SIGNAL CONTROLLER OF THE TEMPORARY SIGNAL FOR FIRE DEPARTMENT CONTROL. PROVIDE HALF HOUR TRAINING TO FIRE DEPARTMENT PERSONNEL OF FIRE MARSHALL'S CHOOSING PRIOR TO ALTERNATING ONE-WAY SIGNAL IMPLEMENTATION.
- THE OLD LYME FIRE MARSHALL, DAVE ROBERGE [CELL 860 662-1339] AND THE LOCAL FIRE DEPT SHALL ASSUME CONTROL OF THE TEMPORARY SIGNAL OPERATIONS IN THE EVENT OF TWO OCCURRENCES:
  - A CLOSURE OF I-95 IN EITHER DIRECTION FOR THE SECTION PARALLEL TO SR 156 ON THE SAME SECTION OF I-95
  - A MAJOR EVENT AT THE DOMINION MILLSTONE POWER STATION THAT REQUIRES EVACUATION OF LOCAL RESIDENTS ALONG SR 156

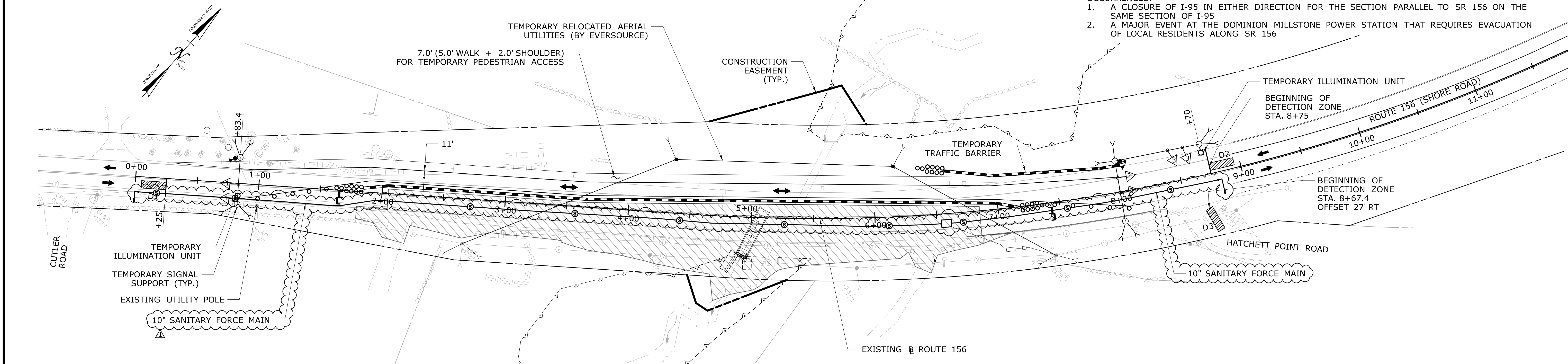

**ADDENDUM NO. 2**

NO.	DATE	REVISION DESCRIPTION
1	1.31.25	ADD SANITARY FORCE MAIN

LEGEND:
R, Y, G RED, YEL, GRN
RED ARROW
YELLOW ARROW
GREEN ARROW
WALK/ PED. CLR
D.W. DON'T WALK
FL. FLASHING
○ PROPOSED WOOD SPAN POLE
● EXISTING WOOD SPAN POLE
□ PROPOSED STEEL SPAN POLE
● EXISTING STEEL SPAN POLE
○ PROPOSED UTILITY POLE
● EXISTING UTILITY POLE
□ PEDESTAL MOUNTING
□ PEDESTRIAN PUSH BUTTON & SIGN
□ DIRECTIONAL ARW. FOR PUSH BUTTON
○ PROPOSED CONTROLLER
● EXISTING CONTROLLER
□ LOOP DETECTOR
SD SYSTEM DETECTOR
○ MAGNETIC DETECTOR
● OPTICAL DETECTOR
□ VIDEO DETECTOR
● AUDIO DETECTOR
VC VIDEO CAMERA CABLE
◆ CABLE CLOSURE
□ WIRELESS SENSOR
□ WIRELESS RECEIVER
□ WIRELESS TRANSMITTER
□ GUY WIRE
□ PROPOSED HANDHOLE
□ EXISTING HANDHOLE

TRAFFIC SIGNAL FACE	PEDESTRIAN SIGNAL FACE	DET. LEADS IN SAW CUT	PROPOSED RMC (RIGID METAL CONDUIT)	EXISTING RMC (RIGID METAL CONDUIT)	AUXILIARY TERMINATION CABINET	AUXILIARY EQUIPMENT CABINET	VIDEO DETECTION ZONE
---------------------	------------------------	-----------------------	------------------------------------	------------------------------------	-------------------------------	-----------------------------	----------------------

**STATE OF CONNECTICUT**  
**DEPARTMENT OF TRANSPORTATION**

ENGINEER	TRAFFIC DESIGN	ELECTRICAL DESIGN	REV #	INTERSECTION #
A. POWELL				
N. ROSSI				
S. ROSE				
D. COSTELLO				
A. POWELL				

ENERGY BY	ADDRESS #

MAINT LEVEL	SERVICE POLE

TOWN:	PROJECT NO.
<b>OLD LYME</b>	0104-0175

DRAWING TITLE:	DRAWING NO.
<b>TEMPORARY TRAFFIC CONTROL SIGNAL PLAN</b>	TCS-01

SHEET NO.
<b>05.05.A2</b>

SCALE 1" = 40'

DATE PLOTTED : 2/6/2025 1:001 - Projects\CTDOT\CTDOT\Projects\104\_0175\Traffic\TR\_MST\_0104\_0175\_(05)\_Br06896\_TCS-01.dgn