

ADDENDUM NO. 2

FOR INFORMATION ONLY



PROJECT NUMBER: 0104-0175  
 PROJECT DESCRIPTION: REPLACEMENT OF BRIDGE NOS. 02713 & 06896, ROUTE 156 OVER FOUR MILE RIVER & ARMSTRONG BROOK  
 TOWN(S): OLD LYME & EAST LYME  
 DRAWING TITLE: BRIDGE NO. 02713 - FRONTIER COMMUNICATIONS FIO RELOCATION PLAN-ABOVE GROUND

DRAWING NO. FC-02  
 SHEET NO. 14.02.A2



THE RELOCATION EXISTING CONDUIT STRUCTURE  
AT PROPOSED NEW BRIDGE#02713 SHP 104-175

\*\*\*ATTENTION: STEPS 1-4 MUST BE DONE AFTER STAGE 3, AFTER ALL TRAFFIC HAS BEEN SHIFTED TO THE NORTH  
COORDINATION BETWEEN CT DOT CONTRACTOR & FRONTIER CONTRACTOR IS CRITICAL

EXCAVATE AND PLACE  
2-4" P[SPLIT] 3' BELOW FG

APPROXIMATE FINAL LOCATION 2-4" DUCTS  
EXACT HORIZONTAL & VERTICAL LOCATION  
TO BE DETERMINED IN THE FIELD

EXCAVATE AND PLACE  
2-4" P[SPLIT] 3' BELOW FG

SEQUENCE OF RELOCATING FRONTIER  
UNDERGROUND CONDUIT STRUCTURE

1. FRONTIER CONTRACTOR TO EXCAVATE, EXPOSE & BREAK-OUT 400' ± 2-4" OCCUPIED CONDUIT AND 3 DIRECT BURIED CABLES BETWEEN POINTS 'A' & 'D' EXACT LOCATION OF ALL POINTS TO BE DETERMINED IN THE FIELD
2. FRONTIER FORCES WILL DETERMINE WHICH CABLES CAN BE REMOVED BY FRONTIER CONTRACTOR.
3. FRONTIER CONTRACTOR TO MOVE ALL OTHERS CABLES INTO TEMPORARY SUPPORT TO BE PROVIDED BY CT DOT CONTRACTOR.
4. FRONTIER CONTRACTOR TO EXCAVATE BETWEEN POINTS A & B AND C & D AND PLACE 2-4" P[SPLIT] CONDUIT AROUND EXISTING CABLES AND PLACE 3' ± BELOW FINISH GRADE TO AND BACKFILL TO CT DOT SPECS

NOTE: THIS STEP IS DONE TO ENSURE CT DOT CONTRACTOR CAN WORK BEHIND THE JERSEY BARRIERS WHILE ARE CABLES ARE IN TEMPORARY SUPPORT

5. WHEN THE STATE CONTRACTOR HAS FINISHED INSTALLING THE CULVERT AND IS CLOSE TO FINISH GRADE. FRONTIERS CONTRACTOR CAN REMOVE CABLES FROM TEMPORARY SUPPORT AND PLACE 2-4" P[SPLITS] AROUND THE CABLES AND LOWER THEM INTO THERE FINAL LOCATION.

NOTE: FRONTIER CONTRACTOR WILL WORK WITH THE STATE CONTRACTOR TO AVOID ANY PROPOSED DRAINAGE.

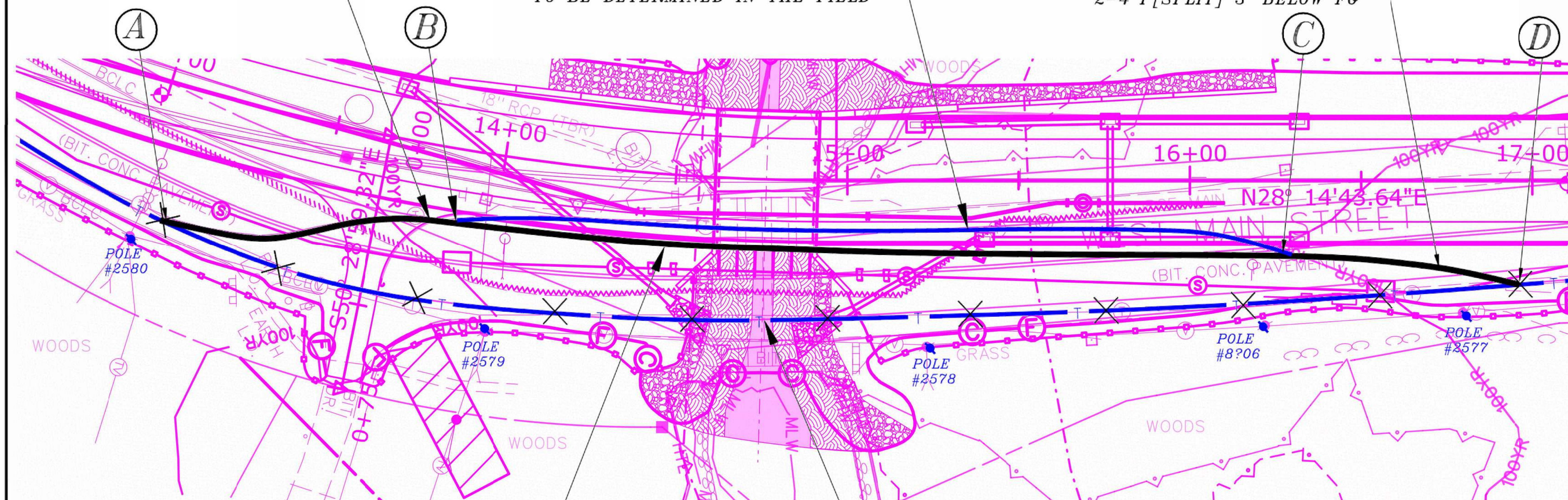

CABLES TO BE PLACED IN  
TEMPORARY SUPPORT  
FROM PT 'B' TO PT 'C'  
STATE CONTRACTOR TO SUPPLY  
SUPPORT & PROTECTION

FRONTIER CONTRACTOR TO EXCAVATE  
& BREAK-OUT CABLES AND MOVE THEM  
INTO TEMPORARY SUPPORT PROVIDED  
BY CT DOT CONTRACTOR

PLAN VIEW  
NTS

ADDENDUM NO. 2

FOR INFORMATION ONLY

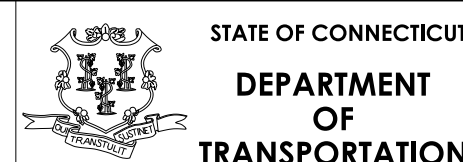

PROJECT NUMBER: 0104-0175  
PROJECT DESCRIPTION: REPLACEMENT OF BRIDGE NOS. 02713 & 06896, ROUTE 156 OVER FOUR MILE RIVER & ARMSTRONG BROOK  
TOWN(S): OLD LYME & EAST LYME  
DRAWING TITLE: BRIDGE NO. 02713- FRONTIER COMMUNICATIONS FIO RELOCATION PLAN-UNDERGROUND

DRAWING NO.  
FC-03  
SHEET NO.  
14.03.A2