

DETOUR PLAN
NOT TO SCALE

LEGEND

- DIRECTION OF TRAVEL LANE
- CONSTRUCTION BARRICADE TYPE III
- SIGN SUPPORT
- ROAD CLOSURE

SUGGESTED LEGEND

W STAFFORD TO CLOSE
x/xx-x/xx

FOLLOW DETOUR

VARIABLE MESSAGE SIGN FOR PERIOD OF 14 DAYS PRIOR TO DETOUR

SUGGESTED LEGEND

RT 190 CLOSED
IN X.X MI

FOLLOW DETOUR

VARIABLE MESSAGE SIGNS DURING DETOUR

EXISTING SIGNS TO REMAIN

DETOUR
190
→
30

INSTALL 80-9707
INSTALL 51-6614
INSTALL 51-6647

COVER EXISTING STRAIGHT ARROW WITH 51-2626(R)

DETAIL 1

EXISTING SIGNS TO REMAIN

DETOUR
WEST
190
NORTH
30
→

INSTALL 80-9707
INSTALL 51-6614
INSTALL 51-6647

DETAIL 2

A		INSTALL 31-0552 (SEE NOTE 3)
B		INSTALL 80-9080 (SEE NOTE 3)
C		INSTALL 80-9928
D		INSTALL 80-9707 51-6614 51-6647 51-2625
E		INSTALL 80-9707 51-6614 51-6647 51-2626(R)
F		INSTALL 80-9707 51-6614 51-6647 51-2626(L)
G		INSTALL 80-9708
H		INSTALL 80-9707 51-6614 51-6647 51-2630
I		INSTALL 80-9707 51-6614 51-6647 51-2631
J		INSTALL 80-9928
K		INSTALL 80-9928
L		INSTALL 80-9077
M		INSTALL 80-9928
N		INSTALL 80-9707 51-6612 51-6647 51-2625

NOTES:

- THE CONTRACTOR SHALL NOTIFY THE ENGINEER, CITY OR MUNICIPAL ENGINEER, DEPARTMENT OF TRAFFIC AND PARKING, AND THE STAFFORD EMERGENCY SERVICES A MINIMUM OF TWO WEEKS PRIOR TO INITIATING THE DETOUR.
- THE DETOUR IS ONLY TO BE IMPLEMENTED DURING THE ALLOWABLE PERIODS AS STATED IN THE SPECIAL PROVISIONS SECTION 1.08.04 - PROSECUTION AND PROGRESS-LIMITATION OF OPERATIONS.
- INSTALL CONSTRUCTION BARRICADES TYPE III ACROSS WEST STAFFORD ROAD AS SHOWN ON THE TRAFFIC PLANS TO CLOSE THE ROADWAY TO TRAFFIC. INSTALL SIGNS 80-9080 (ROAD CLOSED) AND 31-0552 (STOP) ON BARRICADES WITH BARRICADE WARNING LIGHTS-HIGH INTENSITY (ITEM NO. 0976002).
- THE CONTRACTOR MUST MAINTAIN ACCESS TO ALL DRIVEWAYS AT ALL TIMES UNLESS COORDINATED WITH ENGINEER AND AFFECTED BUSINESS.
- ALL DETOUR SIGNS SHALL BE MOUNTED ON POSTS, ON PORTABLE SIGN SUPPORTS OR INSTALLED IN GRASS AREAS. SIGN SHALL BE POST MOUNTED WHERE FEASIBLE. ALL POST MOUNTED SIGNS SHALL BE POSTED 8'-6" ABOVE THE GROUND IN VICINITY OF SIDEWALKS AND 7'-0" EVERYWHERE ELSE.
- THE EXACT LOCATION OF SIGNS TO BE VERIFIED BY THE ENGINEER.
- DETOUR SIGNS ARE BE PAID FOR UNDER ITEM NO. 1220027-CONSTRUCTION SIGNS.
- THE CONTRACTOR MAY BE REQUIRED TO SHIFT, COVER OR TEMPORARILY RELOCATE EXISTING SIGNS TO ACCOMMODATE TEMPORARY DETOUR. THIS WORK SHALL BE PAID UNDER ITEM 0971001A - MAINTENANCE AND PROTECTION OF TRAFFIC.
- EXISTING SIGNS AND PAVEMENT MARKINGS IN CONFLICT WITH THIS TRAFFIC PATTERN SHALL BE COVERED FROM VIEW OF MOTORISTS.
- ALL DETOUR SIGNS SHALL BE COVERED OR REMOVED WHEN THE DETOUR IS NOT IN EFFECT.
- TWO WEEKS PRIOR TO INITIATING THE DETOUR, THE CONTRACTOR SHALL INSTALL TWO CMS ON ROUTE 190 AT THE PROJECT LOCATION INDICATING THAT ROUTE 190 WILL BE CLOSED. DURING THE DETOUR, THE TWO CMS SHALL BE RELOCATED AS FOLLOWS: ONE AT THE INTERSECTION OF ROUTE 190 AND THOMAS DRIVE, AND ONE AT THE INTERSECTION OF ROUTE 319 AND STANDISH DRIVE. FINAL LOCATIONS FOR ALL CMS SHALL BE FIELD VERIFIED BY THE ENGINEER. ALL CMS SHALL REMAIN FOR THE DURATION OF THE DETOUR.
- THE CONTRACTOR SHALL MAINTAIN PEDESTRIAN WALKWAYS AT ALL TIMES THROUGH OR AROUND WORK AREAS DURING CONSTRUCTION.

O		INSTALL 80-9707 51-6612 51-6647 51-2626(R)
P		INSTALL 80-9707 51-6612 51-6647 51-2626(L)
Q		INSTALL 80-9707 51-6612 51-6647 51-2631
R		INSTALL 80-9707 51-6614 51-6647 51-2632
S		INSTALL 80-9077

EXISTING SIGNS TO REMAIN

DETOUR
WEST
190
←

INSTALL 80-9707
INSTALL 51-2629

DETAIL 3

NOTE:
SEE DRAWING NO. MPT-01, MPT-02, AND MPT-03 FOR GENERAL CONSTRUCTION STAGING.

REV.	DATE	REVISION DESCRIPTION



SUGGESTED SEQUENCE OF CONSTRUCTION

STAGE 1A

1. INSTALL STAGE 1 MPT AS SHOWN ON THIS PLAN INCLUDING BUT NOT LIMITED TO CONSTRUCTION SIGNS, TEMPORARY PAVEMENT MARKINGS, TEMPORARY TRAFFIC BARRIERS, CONES AND DRUMS, AND TEMPORARY IMPACT ATTENUATION SYSTEM.
2. INSTALL TEMPORARY EARTH RETAINING SYSTEM AS REQUIRED AT THE LOCATION SHOWN ON THESE PLANS.
3. EXCAVATE OUT FROM THE FACE OF THE TEMPORARY EARTH RETAINING SYSTEM TO THE PROPOSED LOCATION OF THE NEW WATER MAIN SHOWN ON THESE PLANS. CONTRACTOR TO TAKE CAUTION NOT TO EXPOSE THE EXISTING WATER MAIN DURING THIS STEP.
4. CONTRACTOR TO ALLOW CT WATER TO INSTALL THEIR PROPOSED WATER MAIN AT THE LOCATION SHOWN ON THESE PLANS.
5. ONCE THE WATER MAIN IS INSTALLED, CONTRACTOR TO BACKFILL AROUND THE NEW WATER MAIN UP TO BOTTOM OF SUBBASE.

STAGE 1B

1. CONTRACTOR SHALL EXCAVATE TO THE REMAINING LIMITS OF STAGE 1 AS SHOWN ON THESE PLANS WHILE REMOVING THE EXISTING STONE MASONRY ARCH CULVERT AND PREVIOUSLY DISCONNECTED WATER MAIN.
2. BACKFILL TRENCH WITH GRANULAR FILL AS SHOWN ON THE STRUCTURE SHEETS UP TO BOTTOM OF SUBBASE WITHIN THE ROADWAY AND DRIVEWAY, AND BOTTOM OF TOPSOIL WITHIN GRASS AREAS.
3. INSTALL BITUMINOUS CONCRETE BASE COARSE WITHIN THE ROADWAY AND INSTALL BITUMINOUS CONCRETE DRIVEWAY WITHIN THE LIMITS SHOWN ON THE PLANS.
4. PLACE TOP SOIL AND TURF ESTABLISHMENT WITHIN THE GRASS AREAS SHOWN.

NOTES:

1. WHEN EXISTING SIGNAGE AND PAVEMENT MARKINGS CONFLICTS WITH THE PROPOSED TRAFFIC PATTERN SHOWN IN THE M&PT PLANS, THE CONTRACTOR SHALL COVER OR REMOVE THOSE CONFLICTING SIGNS AND PAVEMENT MARKINGS OR SIGNS MAY ALSO BE TEMPORARILY RELOCATED IF APPROPRIATE FROM THE VIEW OF THE MOTORISTS.
2. SEE SPECIAL PROVISION SECTION 1.08.04 - PROSECUTION AND PROGRESS - LIMITATIONS OF OPERATIONS AND ITEM NO. 0971001A - MAINTENANCE AND PROTECTION OF TRAFFIC FOR ADDITIONAL REQUIREMENTS.
3. THE LOCATION OF ROAD WORK AHEAD AND ROAD WORK AHEAD FINES DOUBLED SIGNING SHALL BE VERIFIED IN THE FIELD BY THE ENGINEER THEN INSTALLED BY THE CONTRACTOR PRIOR TO THE BEGINNING OF CONSTRUCTION ACTIVITIES.
4. THE LOCATION OF TRAFFIC DRUMS SHOWN ON THE PLANS ARE APPROXIMATE AND SHALL BE ADJUSTED BY THE CONTRACTOR TO MEET FIELD CONDITIONS AND TO CLEARLY DEFINE ACCESS TO AND EGRESS FROM ALL ROADWAYS AND DRIVEWAYS.
5. THE CONTRACTOR SHALL MAINTAIN PEDESTRIAN WALKWAYS AT ALL TIMES THROUGH WORK AREA DURING CONSTRUCTION. WHEN THE CONTRACTOR MAINTAINS A TEMPORARY OR EXISTING WALKWAY IN PROXIMITY TO A WORK AREA, THE CONTRACTOR SHALL SUBMIT TO THE ENGINEER A WORKING PLAN AND DETAILS SHOWING HOW THE CONTRACTOR PLANS TO PROTECT THE PEDESTRIANS.
6. ALL CONSTRUCTION SIGN LOCATIONS ARE APPROXIMATE AND SHALL BE FIELD VERIFIED BY THE ENGINEER PRIOR TO INSTALLATION. SIGN HEIGHTS & LATERAL CLEARANCES SHALL ALSO BE FIELD VERIFIED BY THE ENGINEER. ALL PORTABLE SIGN SUPPORTS SHALL CONFORM TO NCHRP REPORT 350.
7. SIGNS, PAVEMENT MARKINGS SHOWN ON THESE PLANS SHALL BE INSTALLED PRIOR TO SHIFTING TRAFFIC.
8. PRIOR TO CLOSURE OF ANY LOCAL STREET, THE CONTRACTOR MUST CONTACT THE TOWN OF STAFFORD FOR ALLOWABLE CLOSURE PERIODS IN THE ACCORDANCE WITH THE SPECIAL PROVISIONS AND MUST INSTALL ALL DETOUR SIGNS PRIOR TO A ROAD CLOSURE. SEE THE STAGE CONSTRUCTION PLANS FOR SEQUENCE.
9. ALL SIGNS FOR CONSTRUCTION WILL BE PAID FOR UNDER ITEM NO. 1220027 - CONSTRUCTION SIGNS.
10. TEMPORARY IMPACT ATTENUATION SYSTEM SAND BARREL ARRAYS, ATTENUATION REFLECTORS, AND THE RELOCATION AND REPAIR OF EACH SAND BARREL WILL BE PAID FOR UNDER ITEM #0971001A - MAINTENANCE AND PROTECTION OF TRAFFIC.

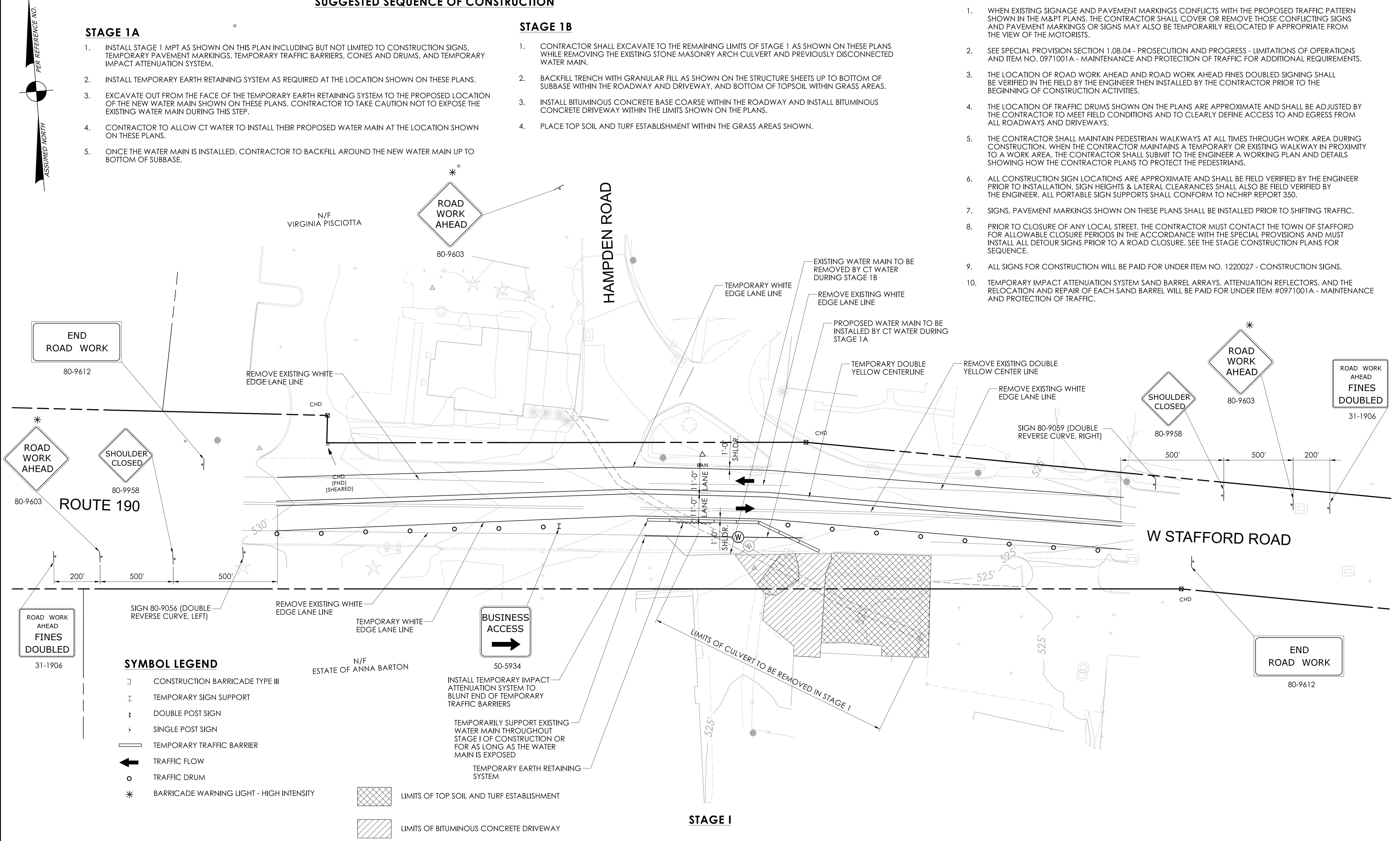

SYMBOL LEGEND

- CONSTRUCTION BARRICADE TYPE III
- ⊥ TEMPORARY SIGN SUPPORT
- ⊥ DOUBLE POST SIGN
- ⊥ SINGLE POST SIGN
- ▬ TEMPORARY TRAFFIC BARRIER
- ← TRAFFIC FLOW
- TRAFFIC DRUM
- * BARRICADE WARNING LIGHT - HIGH INTENSITY
- ▨ LIMITS OF TOP SOIL AND TURF ESTABLISHMENT
- ▩ LIMITS OF BITUMINOUS CONCRETE DRIVEWAY

REV.	DATE	DESCRIPTION

DESIGNER/DRAFTER: D.A.S. CHECKED BY: R.H.S. SCALE: 1" = 20'

SIGNATURE/BLOCK: **RHS**

STATE OF CONNECTICUT DEPARTMENT OF TRANSPORTATION

PROJECT NUMBER: 0134-0153 PROJECT DESCRIPTION: CULVERT UNDER ROUTE 190 TOWN(S): STAFFORD DRAWING TITLE: CONSTRUCTION STAGE - 1

DRAWING NO. MPT-01 SHEET NO. 05.03

LASTED SAVED BY: dachm FILE NAME: Y:\Projects\R125-7A CHA_0134_0153 Stafford Springs Culvert Abandonment\VDGN\90% Submission\Highway\RTe 190-MPT.dgn PLOTTED DATE: 8/20/2024

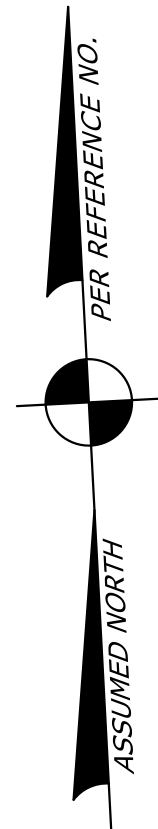

PLACE IMMEDIATELY SOUTH OF THE INTERSECTION OF HAMPDEN ROAD AND DIAMOND LEDGE ROAD

NO ACCESS TO ROUTE 190 WEST AHEAD
80-9928

STAGE 2 SUGGESTED SEQUENCE OF CONSTRUCTION

1. INSTALL DETOUR SIGNS AND CLOSE ROUTE 190 AS SHOWN ON THE DETOUR PLAN AND THIS SHEET.
2. INSTALL STAGE 2 MPT AS SHOWN ON THIS PLAN INCLUDING BUT NOT LIMITED TO CONSTRUCTION SIGNS, TEMPORARY PAVEMENT MARKINGS, TEMPORARY TRAFFIC BARRIERS, CONES, AND DRUMS. MAINTAIN A TEMPORARY PATH TO THE SOUTH OF THE WORK AREA FOR THE PASSAGE OF EMERGENCY VEHICLES THROUGH THE WORK ZONE. MAINTAIN BUSINESS ACCESS TO THE NAPA AUTO PARTS THROUGHOUT THE DETOUR.
3. INSTALL TEMPORARY EARTH RETAINING SYSTEM AS REQUIRED AT THE LOCATION SHOWN ON THESE PLANS.
4. EXCAVATE FOR THE REMOVAL OF THE EXISTING STONE MASONRY ARCH CULVERT WITHIN THE LIMITS SHOWN FOR STAGE 2 CONSTRUCTION ON THIS PLAN.
5. PLACE GRANULAR FILL WITHIN THE EXCAVATION LIMITS UP TO THE BOTTOM OF SUBBASE.
6. PLACE SUBBASE AND BASE COURSE OF BITUMINOUS CONCRETE PAVEMENT WITHIN THE LIMITS OF STAGE 2.
7. REMOVE TEMPORARY TRAFFIC BARRIERS AND PLACE TOP COURSE OF BITUMINOUS CONCRETE PAVEMENT ACROSS THE ENTIRE WIDTH OF ROUTE 190.
8. INSTALL NEW PAVEMENT MARKINGS ON ROUTE 190, REMOVE DETOUR SIGNS AND OPEN ROUTE 190 TO TRAFFIC.

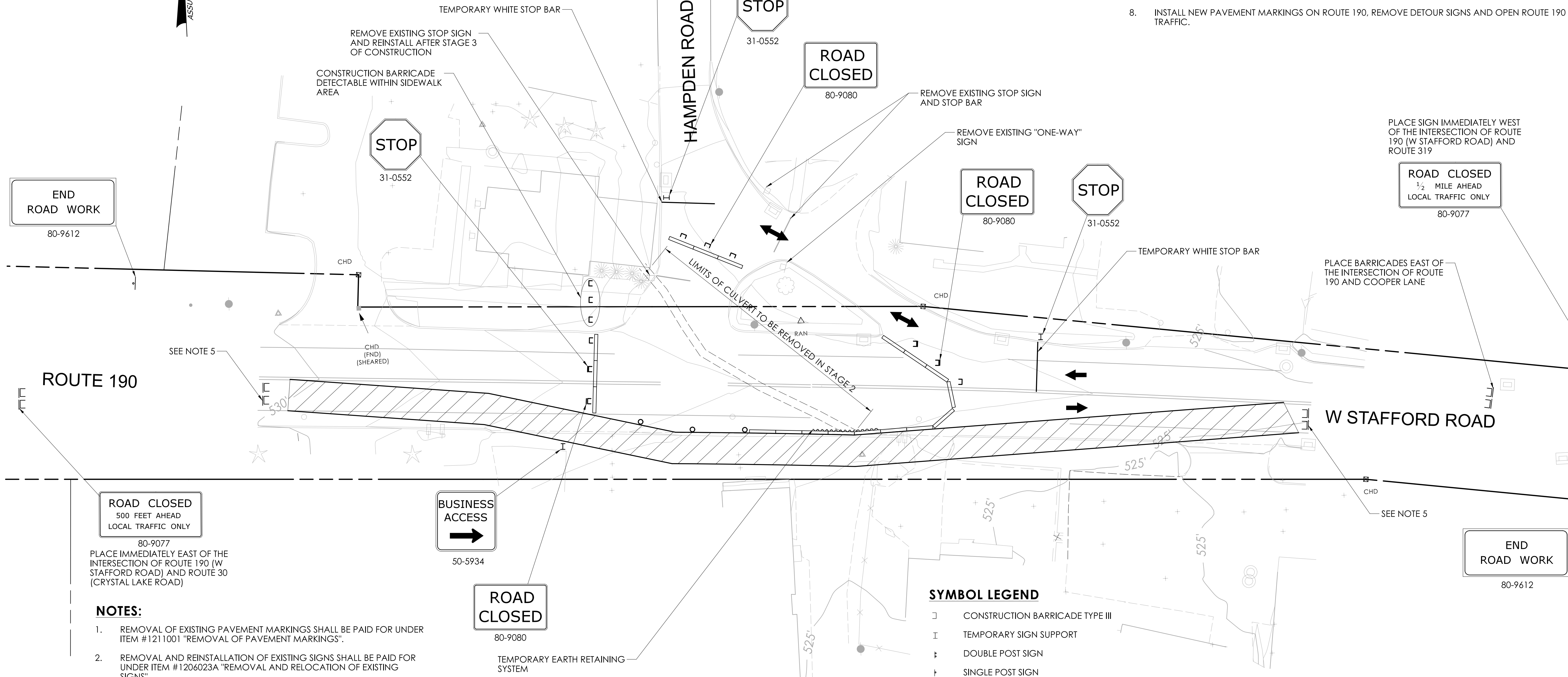

END ROAD WORK
80-9612

STOP
31-0552

STOP
31-0552

ROAD CLOSED
80-9080

ROAD CLOSED
80-9080

STOP
31-0552

ROAD CLOSED
1/2 MILE AHEAD
LOCAL TRAFFIC ONLY
80-9077

ROAD CLOSED
500 FEET AHEAD
LOCAL TRAFFIC ONLY
80-9077

BUSINESS ACCESS
50-5934

ROAD CLOSED
80-9080

END ROAD WORK
80-9612

NOTES:

1. REMOVAL OF EXISTING PAVEMENT MARKINGS SHALL BE PAID FOR UNDER ITEM #1211001 "REMOVAL OF PAVEMENT MARKINGS".
2. REMOVAL AND REINSTALLATION OF EXISTING SIGNS SHALL BE PAID FOR UNDER ITEM #1206023A "REMOVAL AND RELOCATION OF EXISTING SIGNS".
3. REMOVAL OF EXISTING STREET SIGNS THAT WILL NOT BE REINSTALLED SHALL BE PAID FOR UNDER ITEM #1206013 "REMOVAL OF EXISTING SIGNING".
4. TEMPORARY WHITE STOP BARS SHALL BE PAID FOR UNDER ITEM #1212017 "TEMPORARY PLASTIC LEGEND ARROWS AND MARKINGS".
5. CONTRACTOR TO SCHEDULE TO HAVE A MUNICIPAL POLICE OFFICER PRESENT THROUGHOUT THE DETOUR AT BOTH ENDS OF CONSTRUCTION TO ALLOW EMERGENCY VEHICLES PASSAGE THROUGH THE DESIGNATED PATH.

SYMBOL LEGEND

- ▤ CONSTRUCTION BARRICADE TYPE III
- ⊥ TEMPORARY SIGN SUPPORT
- ⋈ DOUBLE POST SIGN
- ⋆ SINGLE POST SIGN
- TEMPORARY TRAFFIC BARRIER
- ← TRAFFIC FLOW
- TRAFFIC DRUM
- * BARRICADE WARNING LIGHT - HIGH INTENSITY
- ▨ EMERGENCY VEHICLE PATH

STAGE 2

REV.	DATE	REVISION DESCRIPTION

STAGE 3 SUGGESTED SEQUENCE OF CONSTRUCTION

1. INSTALL STAGE 3 MPT INCLUDING BUT NOT LIMITED TO CONSTRUCTION SIGNS, TEMPORARY TRAFFIC BARRIERS, AND TEMPORARY 6' CHAIN LINK FENCE.
2. EXCAVATE AGAINST THE EXISTING FOUNDATION OF THE BUILDING LOCATED AT 191 W STAFFORD ROAD TO THE LIMITS SHOWN ON THESE PLANS.
3. CONSTRUCT NEW REINFORCED CONCRETE BULKHEAD TO SEAL OFF THE OPENING IN THE EXISTING STONE MASONRY FOUNDATION.
4. REMOVE EXISTING SUMP PUMP AND PIPING AND INSTALL NEW SUMP PUMP WITHIN THE BASEMENT OF THE BUILDING AND CONNECT DISCHARGE PIPE TO NEARBY CATCH BASIN AS SHOWN IN THE STRUCTURAL PLANS.
5. BACKFILL AGAINST NEW CONCRETE WALL AND PLACE TOPSOIL AND TURF ESTABLISHMENT.
6. REMOVE STAGE 3 MPT AND PLACE TOP COARSE OF BITUMINOUS CONCRETE PAVEMENT ON HAMPDEN ROAD.

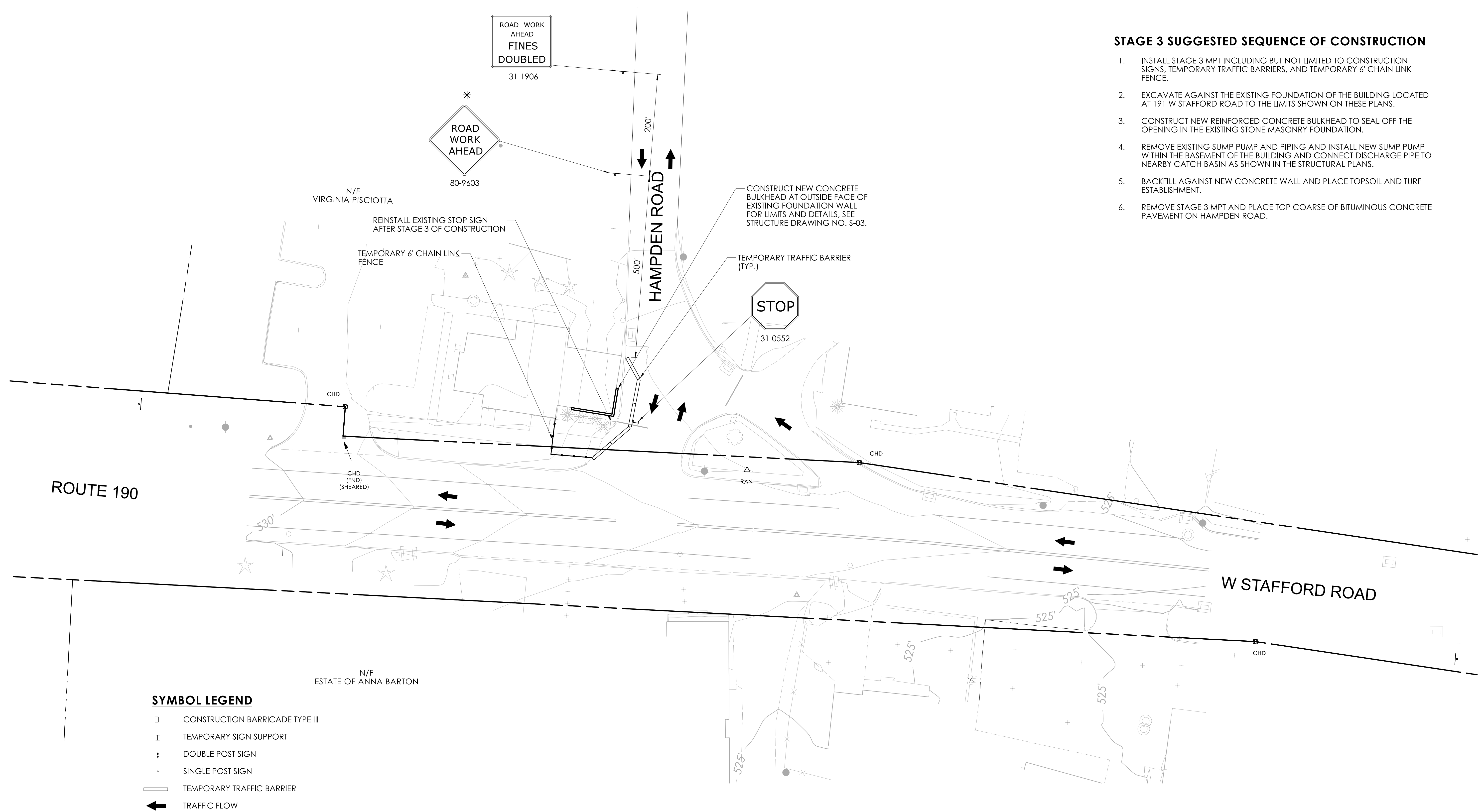

SYMBOL LEGEND

- ▮ CONSTRUCTION BARRICADE TYPE III
- ┆ TEMPORARY SIGN SUPPORT
- ⋈ DOUBLE POST SIGN
- ┆ SINGLE POST SIGN
- ▬ TEMPORARY TRAFFIC BARRIER
- ← TRAFFIC FLOW
- TRAFFIC DRUM
- * BARRICADE WARNING LIGHT - HIGH INTENSITY

STAGE 3

REV.	DATE	REVISION DESCRIPTION

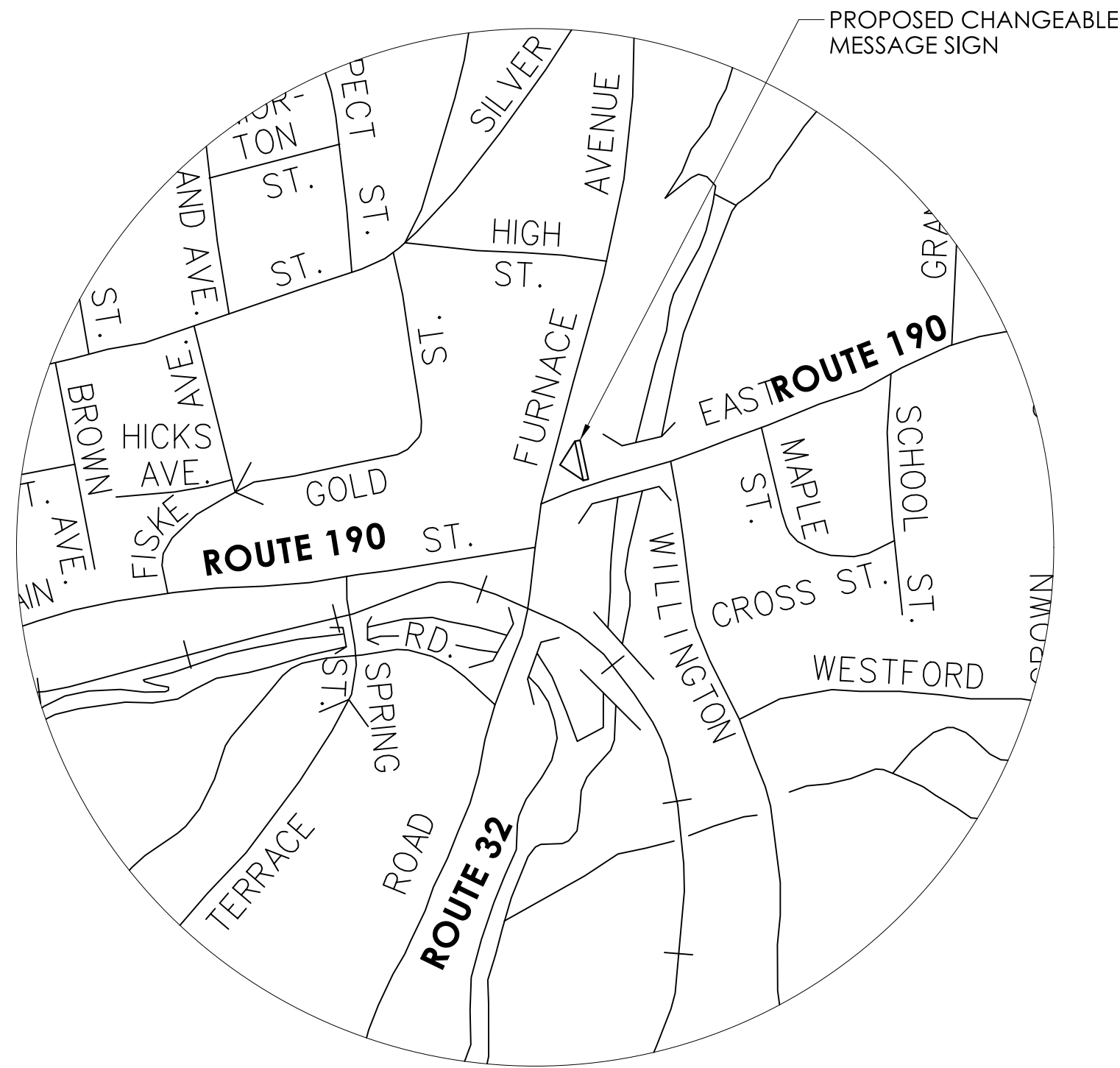

CMS LOCATION 1 (STAFFORD)
SUGGESTED LEGEND

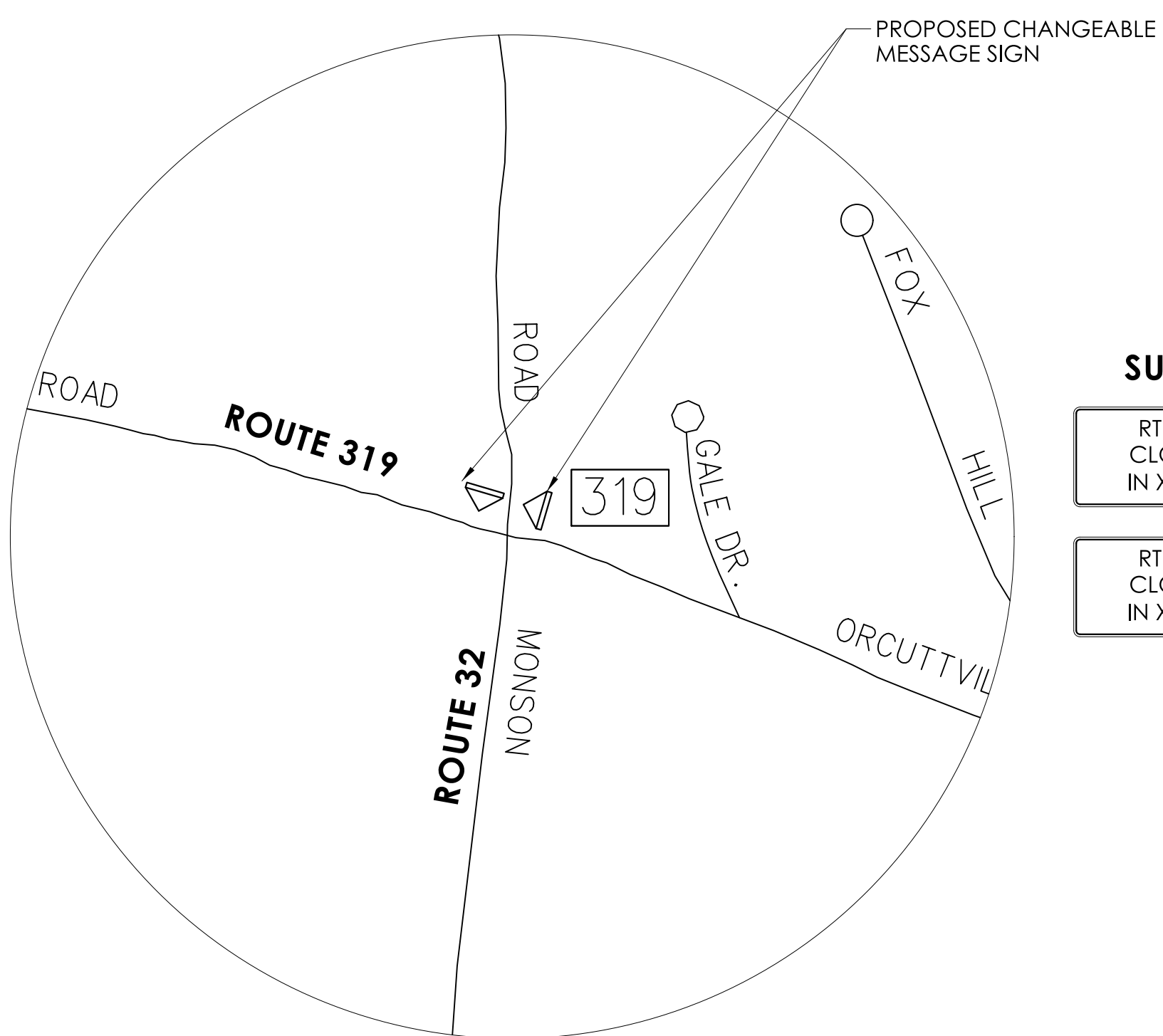
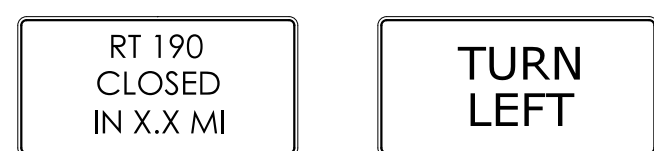

CMS LOCATION 2 (STAFFORD)

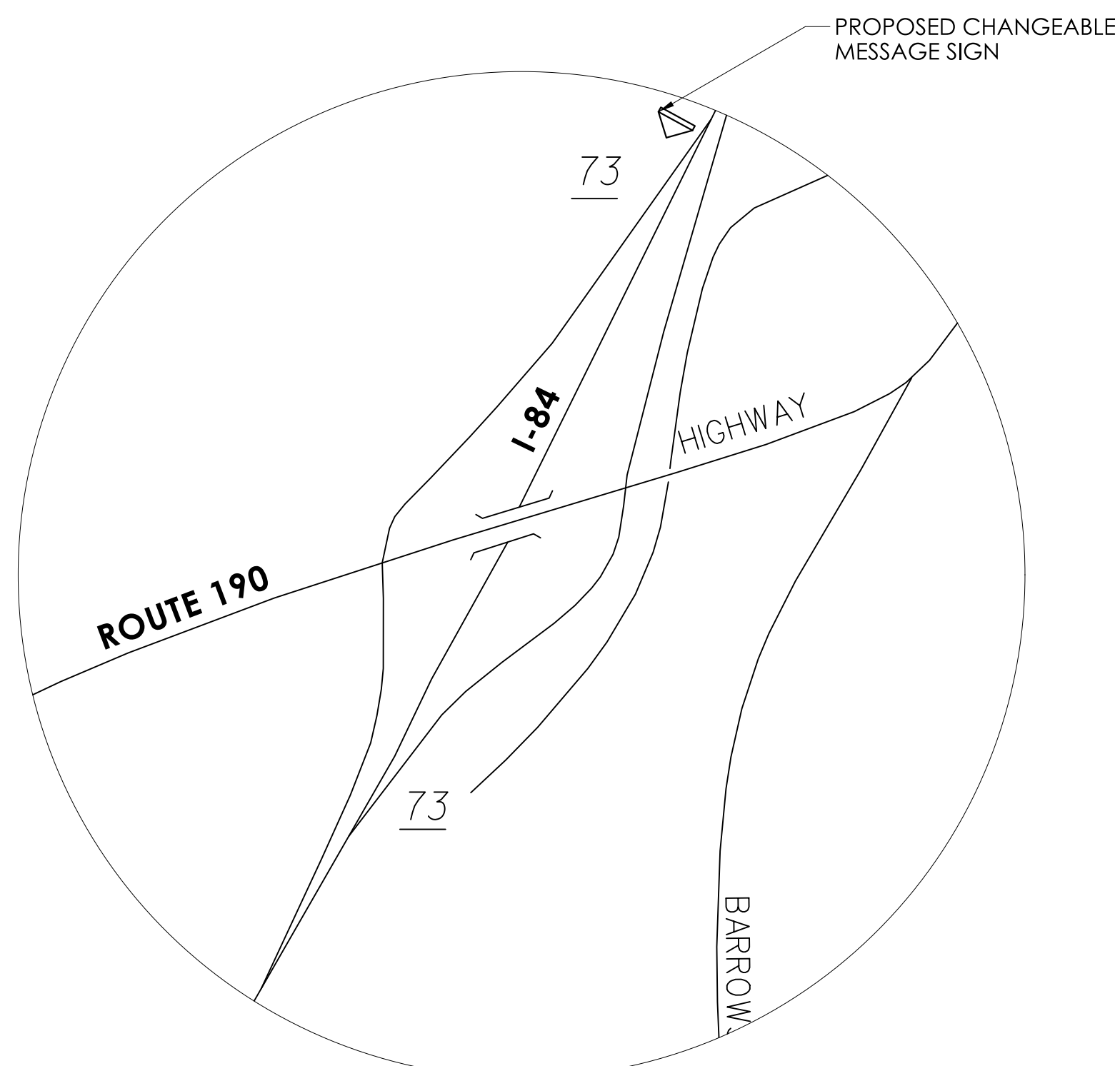
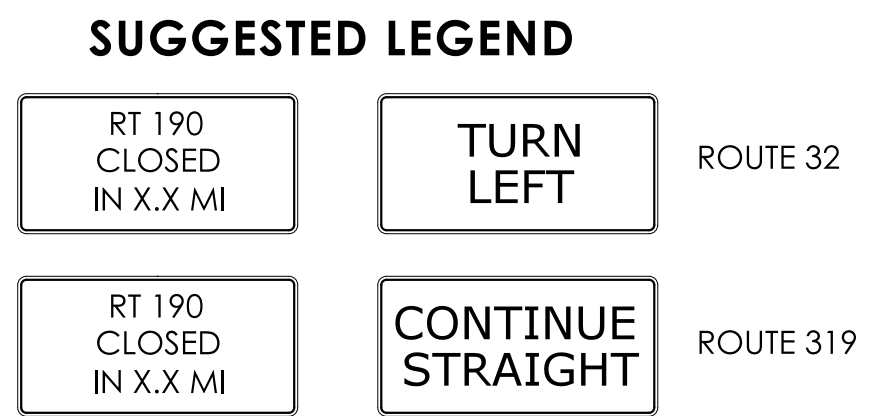

CMS LOCATION 3 (UNION)
SUGGESTED LEGEND

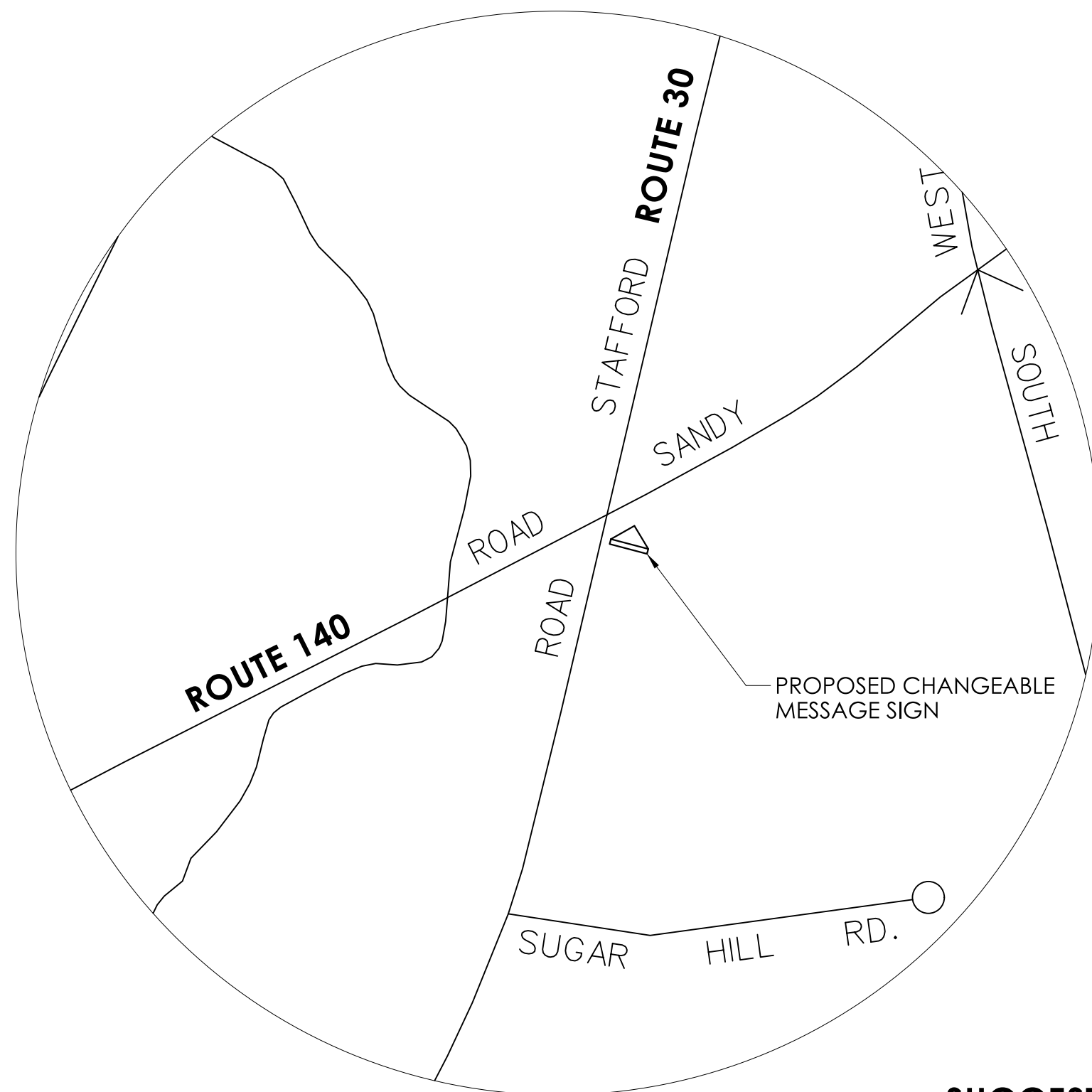
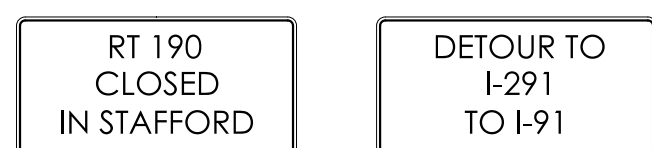

CMS LOCATION 4 (ELLINGTON)

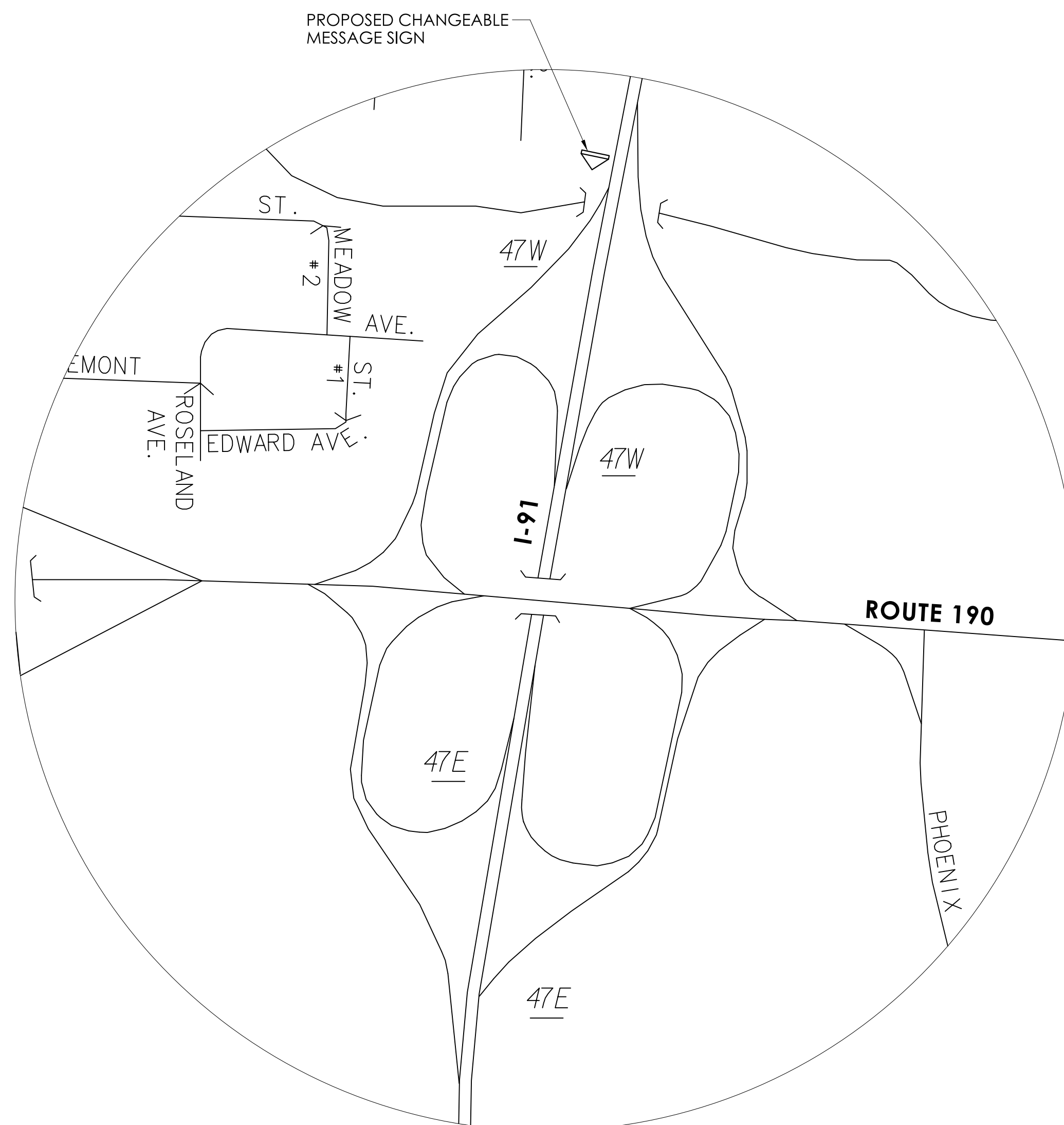

CMS LOCATION 5 (ENFIELD)



REV.	DATE	REVISION DESCRIPTION

DESIGNER/DRAFTER: _____ CHECKED BY: _____
 SIGNATURE/BLOCK: _____



PROJECT NUMBER: 0134-0153
 PROJECT DESCRIPTION: CULVERT UNDER ROUTE 190
 TOWN(S): STAFFORD
 DRAWING TITLE: CMS SIGN LOCATION PLAN

DRAWING NO. MPT-04
 SHEET NO. 05.06