

08 - ENVIRONMENTAL INDEX OF DRAWINGS

DRAWING NUMBER	DRAWING TITLE	DRAWING NUMBER	DRAWING TITLE
ENV-01	ENVIRONMENTAL INDEX OF DRAWINGS		
ENV-02 - ENV-07	PROJECT SOIL CONDITIONS		
ENV-08	TEMPORARY REUSE STOCKPILE AREA (TRSA) LOCATION		
ENV-09	TEMPORARY REUSE STOCKPILE AREA (TRSA) DETAILS		

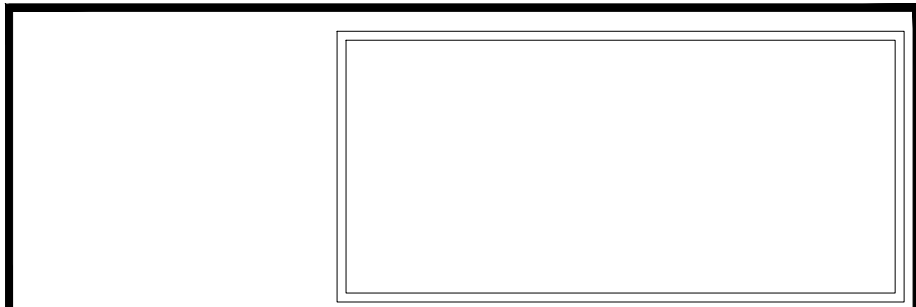

REV.	DATE	REVISION DESCRIPTION

DESIGNER/DRAFTER: WAS/BOB CHECKED BY: TRB HORIZONTAL SCALE: 1" = 40'

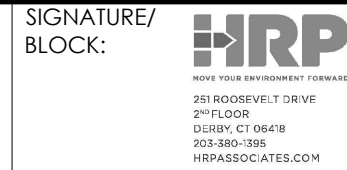
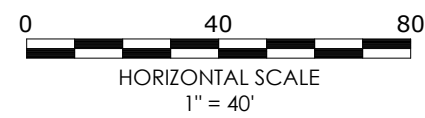

PROJECT NUMBER: 0053-0189
PROJECT DESCRIPTION: REMOVAL OF BR. NOS. 00388 & 00389, DECK REPLACEMENT ON BR. NO. 00870, AND MODIFICATIONS TO ROUTE 17 & NEW LONDON TURNPIKE
TOWN(S): GLASTONBURY
DRAWING TITLE: ENVIRONMENTAL INDEX OF DRAWINGS

DRAWING NO.: ENV-01
SHEET NO.: 08-01

LASTED SAVED BY: BEAULIEU FILE NAME: V:\...CONND\GLASTONBURY\BRIDGE NO. 00388 AND 00389 REPLACEMENT\CTD507631\CAD\ENV_PLAN_SHEETS
PLOTTED DATE: 01/30/2025

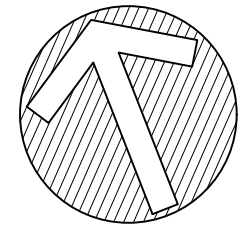

NORTH

CT STATE PROJECT NO. 0053-0189
BEGIN MILL & OVERLAY
 NEW LONDON TURNPIKE STA 10+91
 CUT BITUMINOUS CONCRETE PAVEMENT
 MATCH EXISTING

CUT CONCRETE SIDEWALK MATCH
 EXISTING CONCRETE SIDEWALK
 REMOVAL OF CONCRETE SIDEWALK AND INSTALL
 CONCRETE SIDEWALK RAMP (TYPE 13)
 MATCH EXISTING CONCRETE SIDEWALK AT NEAREST
 EXPANSION OR CONTRACTION JOINT

END MILL & OVERLAY
**BEGIN FULL DEPTH
 RECONSTRUCTION**
 NEW LONDON TURNPIKE STA 11+25

LIMIT OF MILL AND OVERLAY
 CUT BITUMINOUS CONCRETE
 PAVEMENT, MATCH EXISTING

BEGIN GRANITE STONE CURBING, MATCH EDGE
 OF EXISTING SIDEWALK RAMP

END GRANITE STONE CURBING

BITUMINOUS CONCRETE
 DRIVEWAY (COMMERCIAL)

BEGIN GRANITE STONE CURBING

MATCH EXISTING CONCRETE SIDEWALK
 AT NEAREST EXPANSION OR
 CONTRACTION JOINT

NOTES:
 1. ALL REUSABLE AND SURPLUS SOILS WITHIN THE
 PROJECT LIMITS SHALL BE HANDLED IN
 ACCORDANCE WITH ITEM NO. 0202329A -
 MANAGEMENT OF REUSABLE AND SURPLUS SOIL.

REV.	DATE	DESCRIPTION

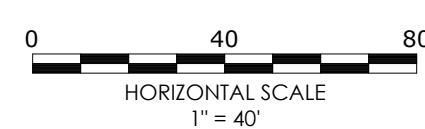

SIGNATURE/
 BLOCK: **HRP**

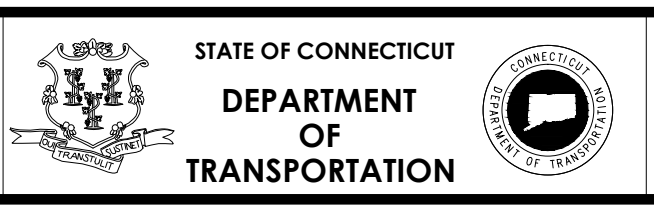

PROJECT NUMBER: 0053-0189
 PROJECT DESCRIPTION: REMOVAL OF BR. NOS. 00388 & 00389, DECK REPLACEMENT ON BR. NO. 00870, AND MODIFICATIONS TO ROUTE 17 & NEW LONDON TURNPIKE
 TOWN(S): GLASTONBURY
 DRAWING TITLE: PROJECT SOIL CONDITIONS

DRAWING NO. ENV-02
 SHEET NO. 08-02

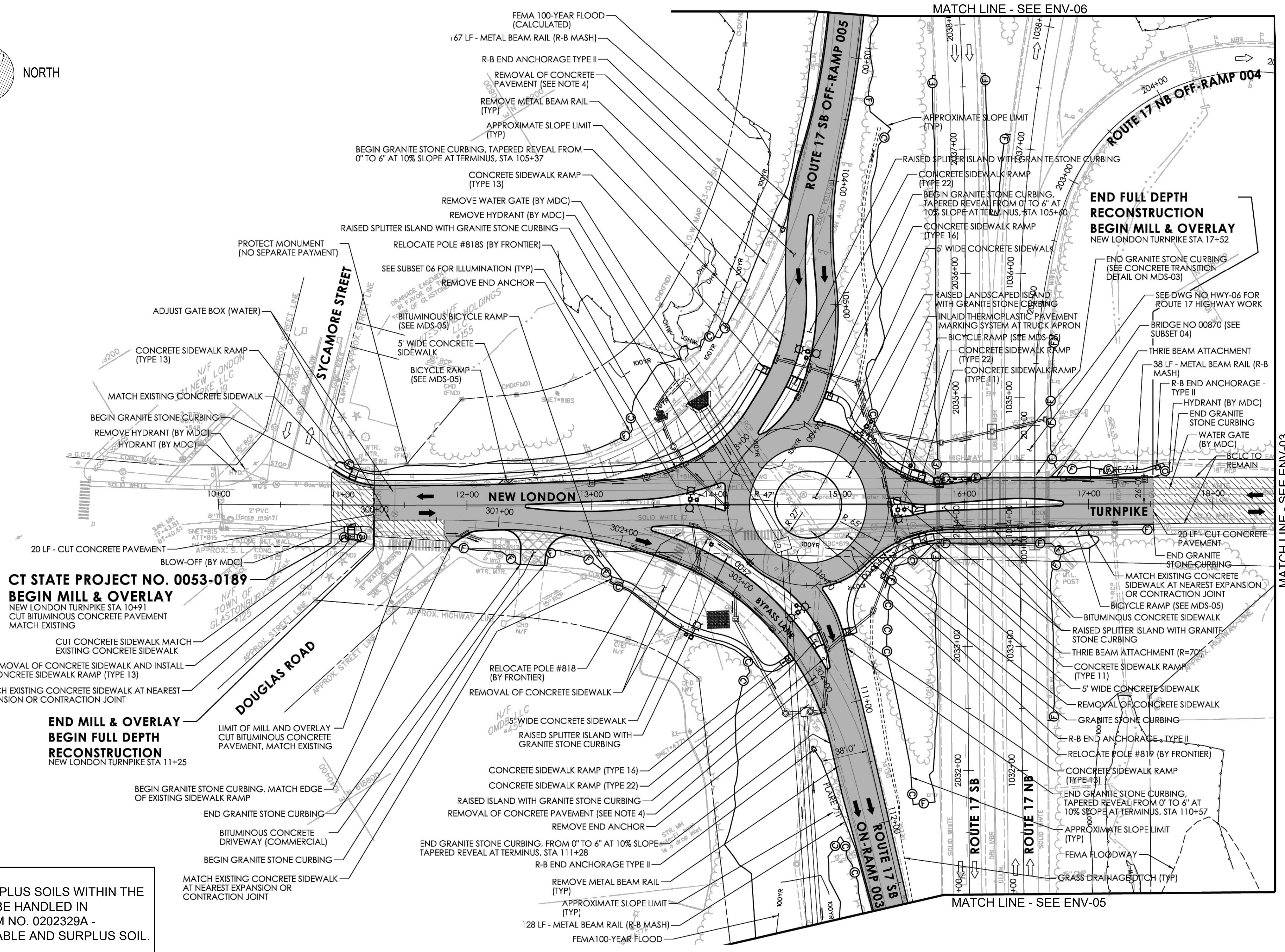

MATCH LINE - SEE ENV-03

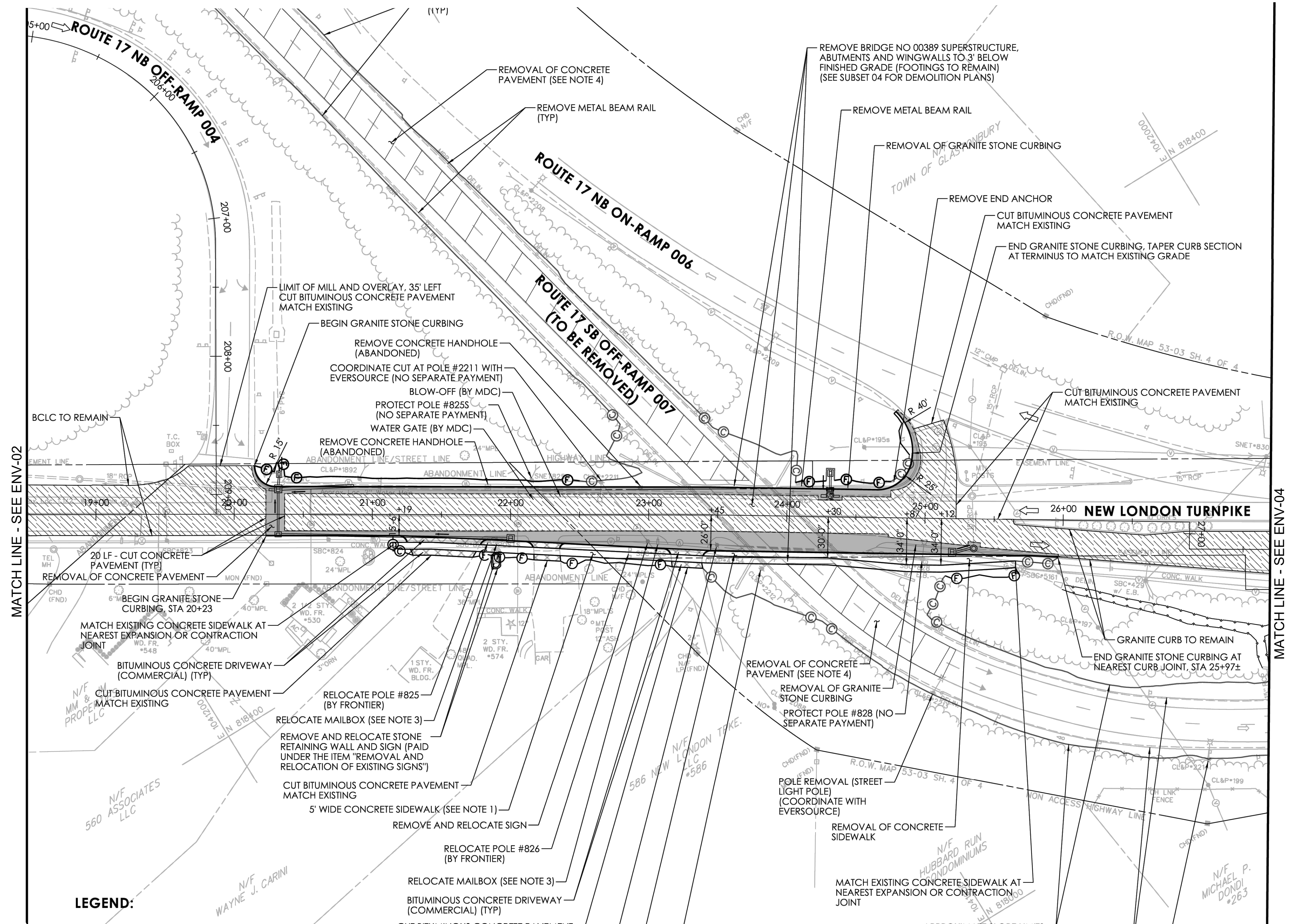

MATCH LINE - SEE ENV-02

MATCH LINE - SEE ENV-04

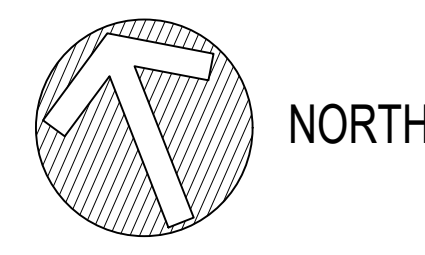

NORTH

LEGEND:

- REMOVAL OF CONCRETE PAVEMENT OUTSIDE LIMITS OF PROPOSED ROADWAY
- FULL DEPTH PAVEMENT RECONSTRUCTION
- MILL AND OVERLAY
- BITUMINOUS CONCRETE DRIVEWAY (COMMERCIAL)

NOTES:
 1. ALL REUSABLE AND SURPLUS SOILS WITHIN THE PROJECT LIMITS SHALL BE HANDLED IN ACCORDANCE WITH ITEM NO. 0202329A - MANAGEMENT OF REUSABLE AND SURPLUS SOIL.

REV.	DATE	REVISION DESCRIPTION

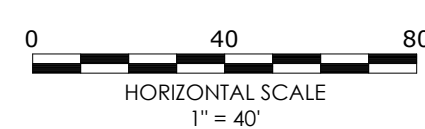

SIGNATURE/BLOCK: HRP

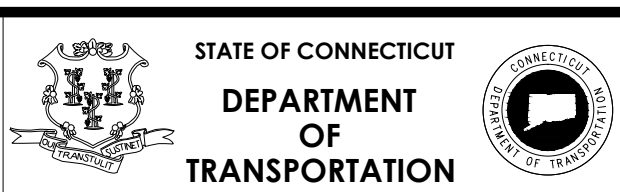

STATE OF CONNECTICUT
 DEPARTMENT OF TRANSPORTATION



DRAWING NO. ENV-03
 SHEET NO. 08-03

**END MILL AND OVERLAY
CT PROJECT NO. 0053-0189**
NEW LONDON TURNPIKE STA 34+20 EASTBOUND
NEW LONDON TURNPIKE STA 34+35 WESTBOUND
CUT BITUMINOUS CONCRETE PAVEMENT
MATCH EXISTING

**END MILL AND OVERLAY
CT PROJECT NO. 0053-0189**
OAK STREET
CUT BITUMINOUS CONCRETE PAVEMENT
MATCH EXISTING

**END MILL AND OVERLAY
CT PROJECT NO. 0053-0189**
WILLIAMS STREET EAST
CUT BITUMINOUS CONCRETE PAVEMENT
MATCH EXISTING

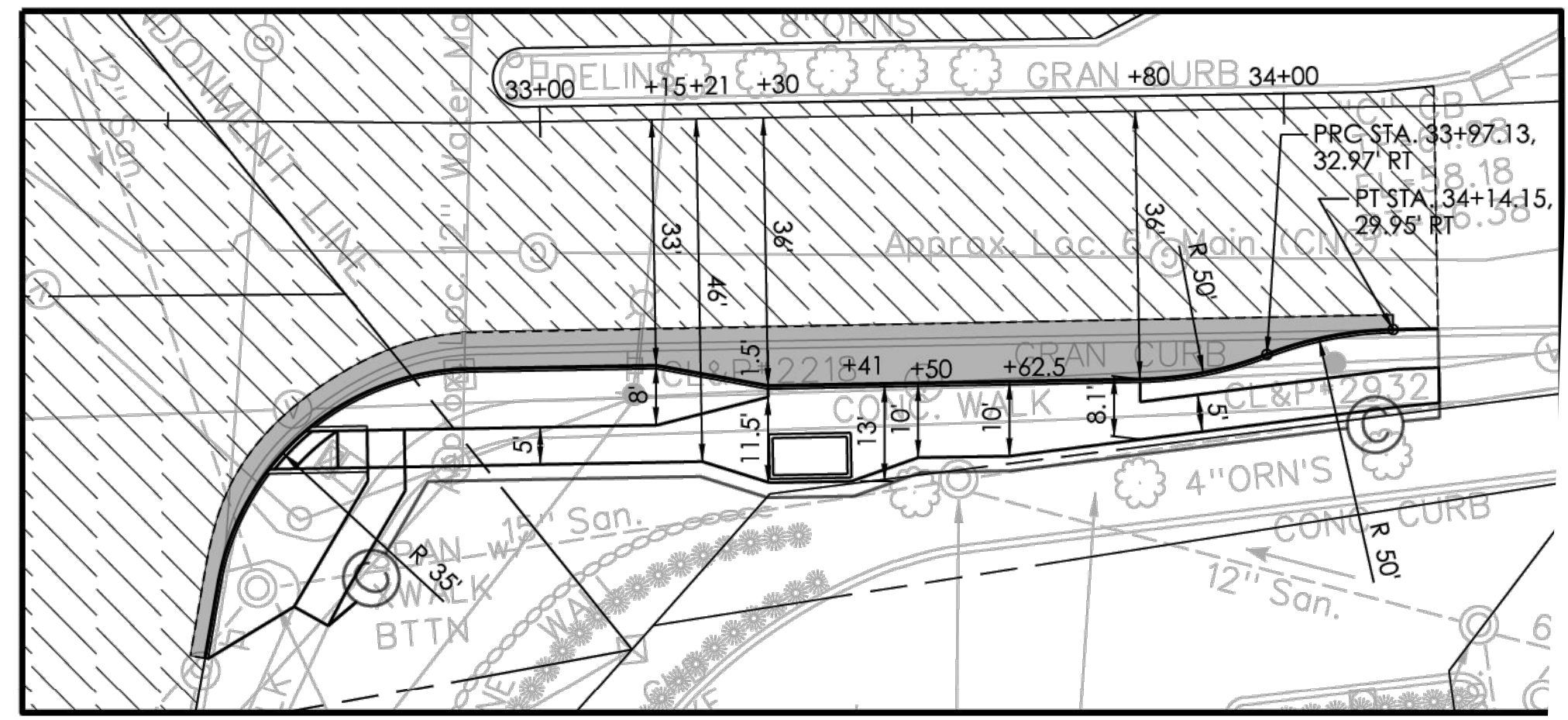

INSET
SCALE: 1"=20'

MATCH LINE - SEE ENV-03

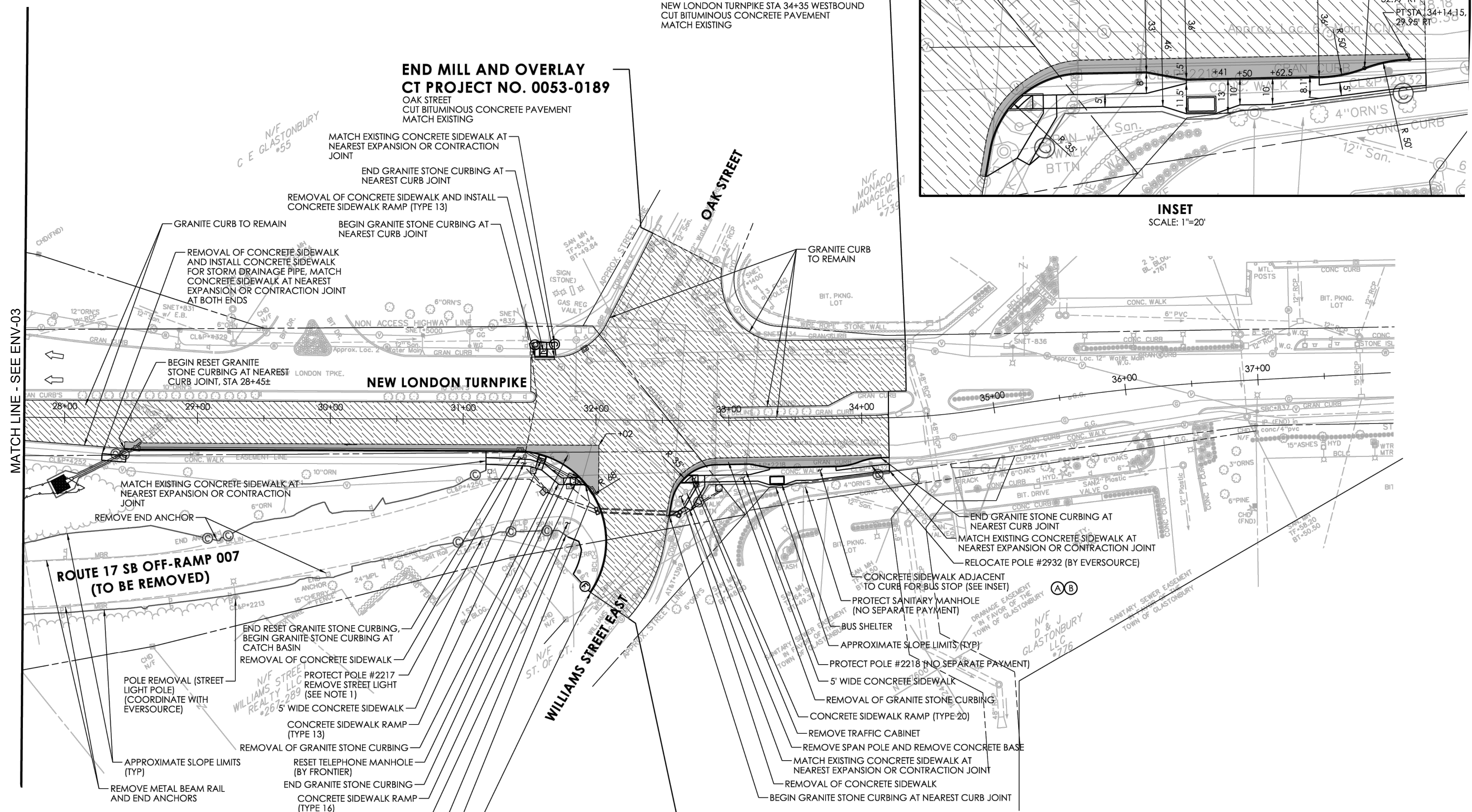

NOTES:
1. ALL REUSABLE AND SURPLUS SOILS WITHIN THE PROJECT LIMITS SHALL BE HANDLED IN ACCORDANCE WITH ITEM NO. 020329A - MANAGEMENT OF REUSABLE AND SURPLUS SOIL.

REV.	DATE	DESCRIPTION

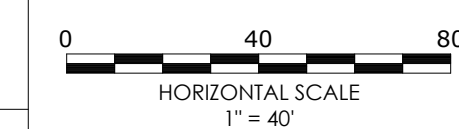

SIGNATURE/BLOCK: **HRP**
PROJECT NO. 0053-0189
DATE: 01/30/2025
DRAWN BY: JTB
CHECKED BY: TRB

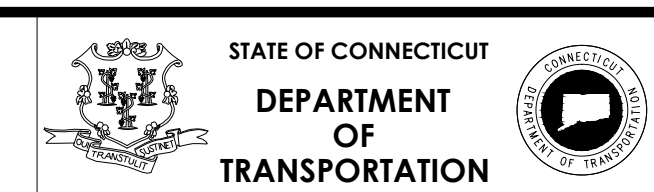

PROJECT NUMBER: 0053-0189
PROJECT DESCRIPTION: REMOVAL OF BR. NOS. 00388 & 00389, DECK REPLACEMENT ON BR. NO. 00870, AND MODIFICATIONS TO ROUTE 17 & NEW LONDON TURNPIKE
TOWN(S): GLASTONBURY
DRAWING TITLE: PROJECT SOIL CONDITIONS

DRAWING NO. ENV-04
SHEET NO. 08-04

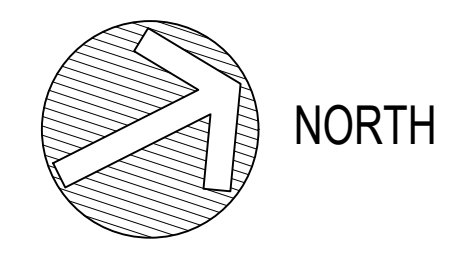

CT STATE PROJECT NO. 0053-0189
BEGIN MILL & OVERLAY
ROUTE 17 SB STA 2028+70
CUT BITUMINOUS CONCRETE PAVEMENT
MATCH EXISTING

CT STATE PROJECT NO. 0053-0189
BEGIN MILL & OVERLAY
ROUTE 17 NB STA 1027+80
CUT BITUMINOUS CONCRETE PAVEMENT
MATCH EXISTING

SEE SUBSET 05 - TRAFFIC, DRAWING NO. SPM-04 THROUGH SPM-06
FOR RUMBLE STRIP-AUTOMATED AND REMOVAL OF RUMBLE STRIPS
FROM STA 992+50 TO 1022+55± AT RIGHT SHOULDER

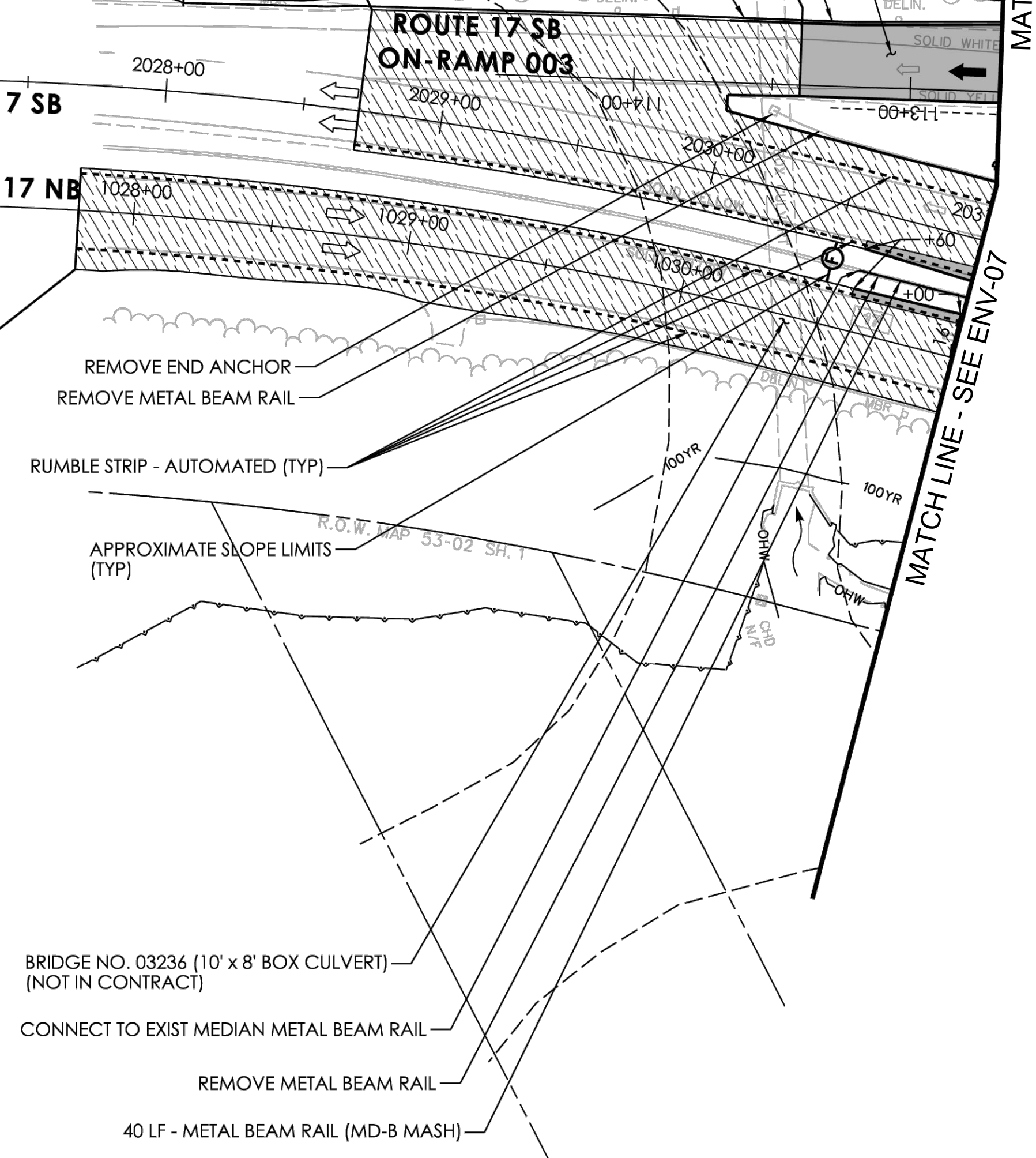
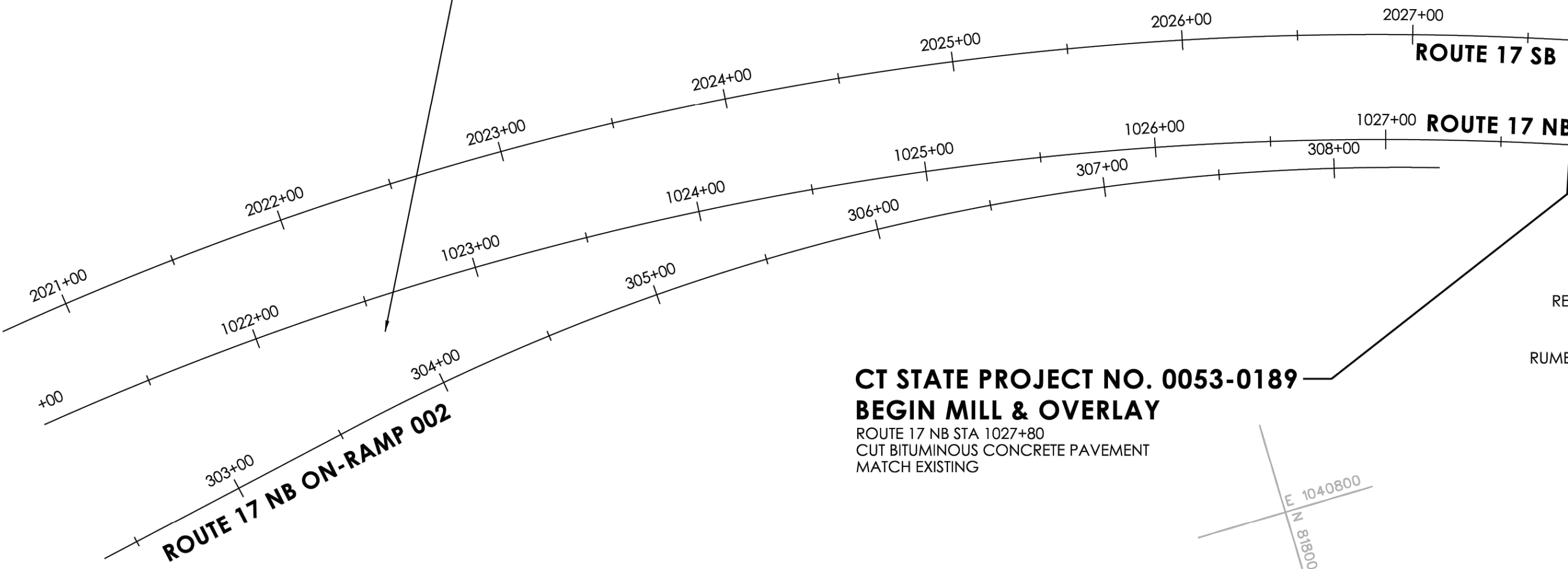
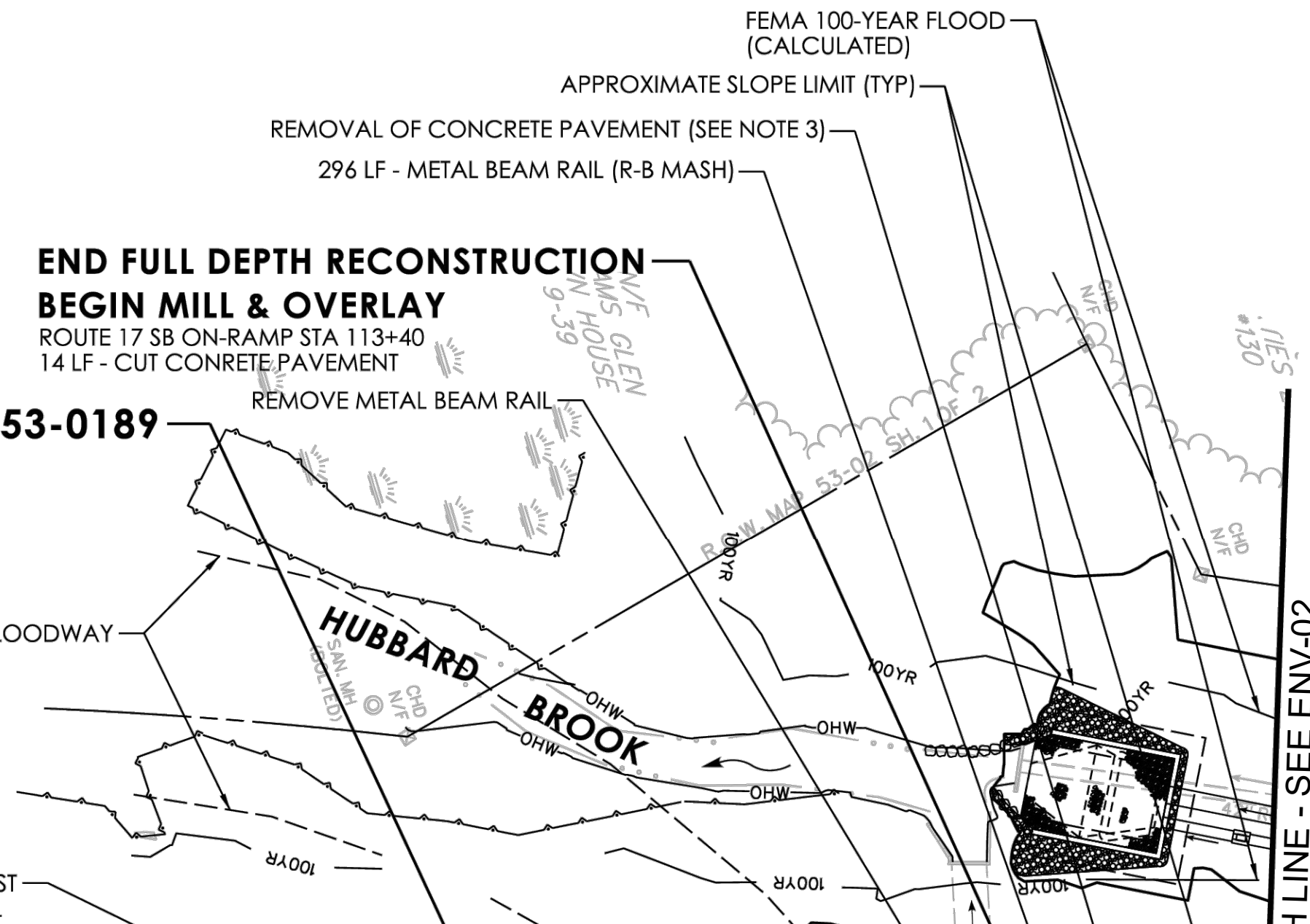

NOTES:
1. ALL REUSABLE AND SURPLUS SOILS WITHIN THE PROJECT LIMITS SHALL BE HANDLED IN ACCORDANCE WITH ITEM NO. 0202329A - MANAGEMENT OF REUSABLE AND SURPLUS SOIL.

REV.	DATE	DESCRIPTION

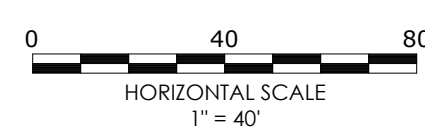

SIGNATURE/BLOCK:

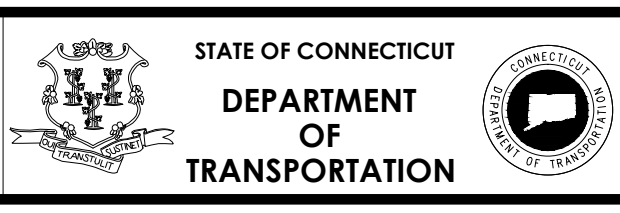

PROJECT NUMBER: 0053-0189
PROJECT DESCRIPTION: REMOVAL OF BR. NOS. 00388 & 00389, DECK REPLACEMENT ON BR. NO. 00870, AND MODIFICATIONS TO ROUTE 17 & NEW LONDON TURNPIKE
TOWN(S): GLASTONBURY
DRAWING TITLE: PROJECT SOIL CONDITIONS



DRAWING NO. ENV-05
SHEET NO. 08-05

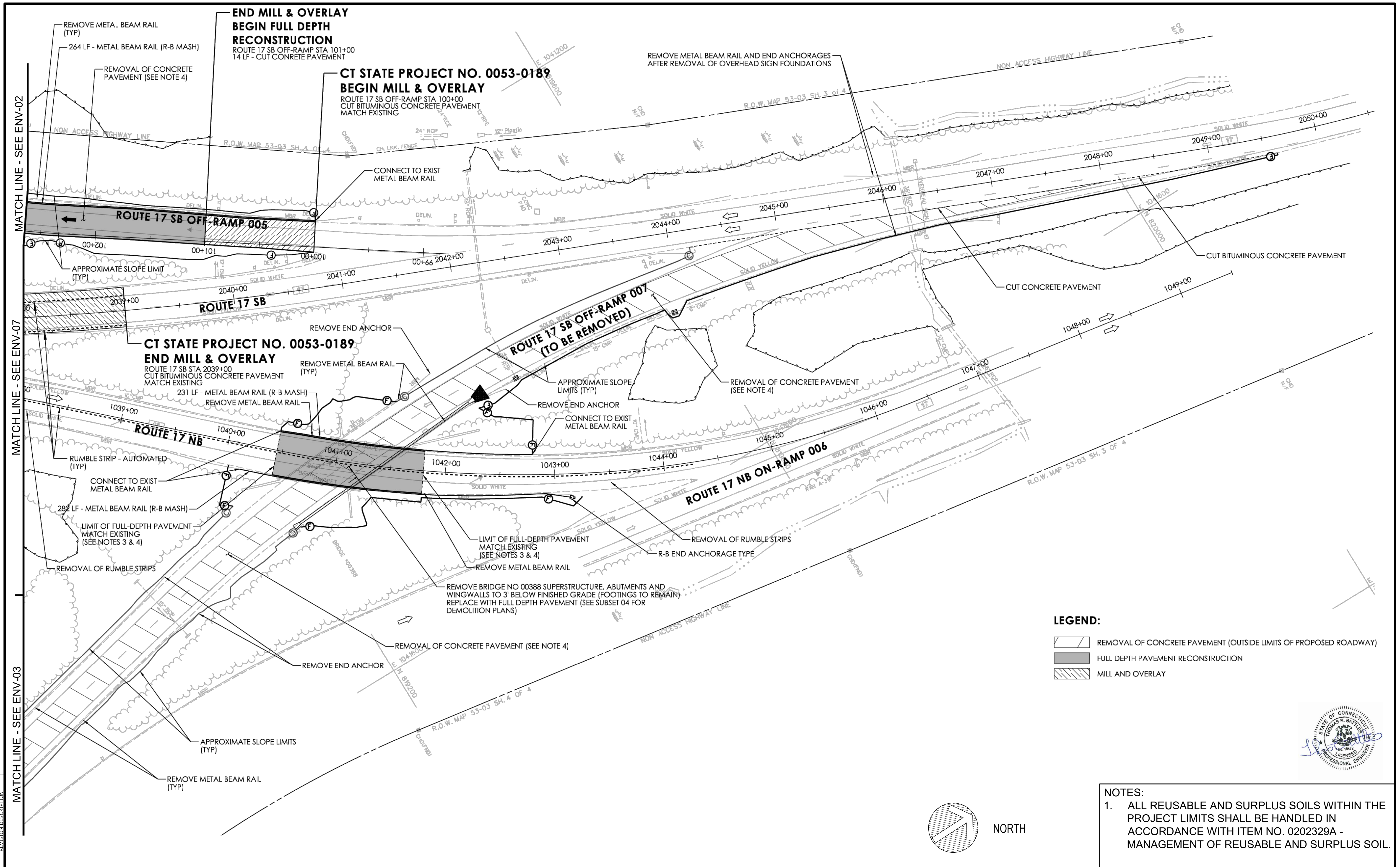

MATCH LINE - SEE ENV-02
MATCH LINE - SEE ENV-07
MATCH LINE - SEE ENV-03

- LEGEND:**
- REMOVAL OF CONCRETE PAVEMENT (OUTSIDE LIMITS OF PROPOSED ROADWAY)
 - FULL DEPTH PAVEMENT RECONSTRUCTION
 - MILL AND OVERLAY

- NOTES:**
- ALL REUSABLE AND SURPLUS SOILS WITHIN THE PROJECT LIMITS SHALL BE HANDLED IN ACCORDANCE WITH ITEM NO. 0202329A - MANAGEMENT OF REUSABLE AND SURPLUS SOIL.



REV.	DATE	REVISION DESCRIPTION

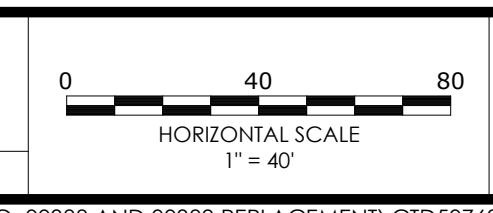

SIGNATURE/BLOCK:

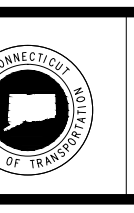
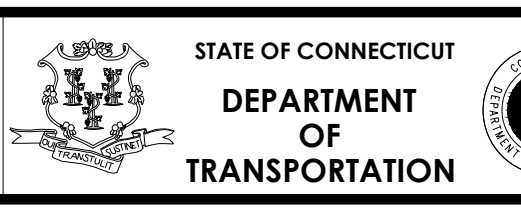

PROJECT NUMBER: 0053-0189
PROJECT DESCRIPTION: REMOVAL OF BR. NOS. 00388 & 00389, DECK REPLACEMENT ON BR. NO. 00870, AND MODIFICATIONS TO ROUTE 17 & NEW LONDON TURNPIKE
TOWN(S): GLASTONBURY
DRAWING TITLE: PROJECT SOIL CONDITIONS

DRAWING NO. ENV-06
SHEET NO. 08-06

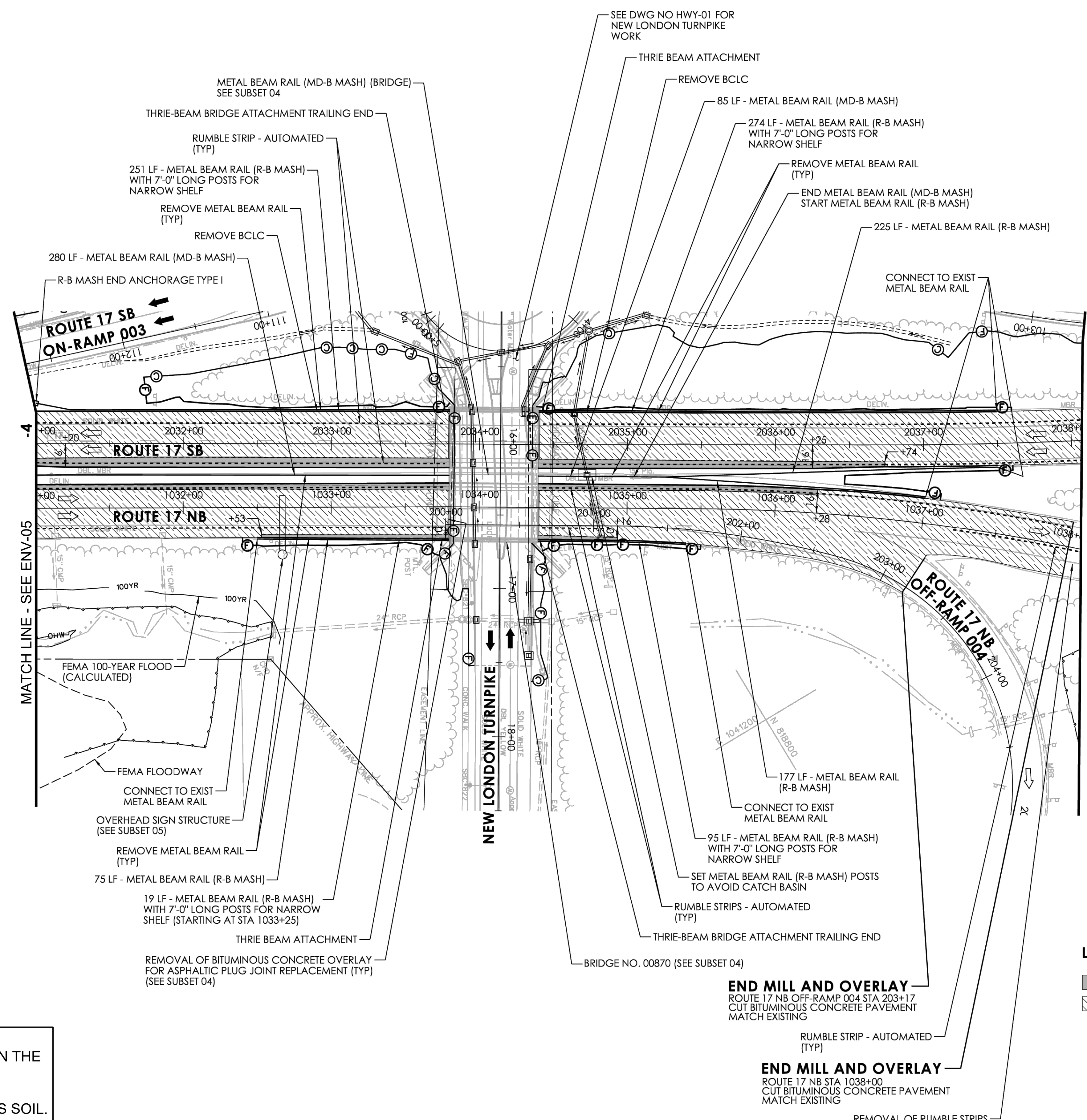

MATCH LINE - SEE ENV-05

MATCH LINE - SEE ENV-06

LEGEND:

- FULL DEPTH PAVEMENT RECONSTRUCTION
- MILL AND OVERLAY

END MILL AND OVERLAY
 ROUTE 17 NB OFF-RAMP 004 STA 203+17
 CUT BITUMINOUS CONCRETE PAVEMENT
 MATCH EXISTING

END MILL AND OVERLAY
 ROUTE 17 NB STA 1038+00
 CUT BITUMINOUS CONCRETE PAVEMENT
 MATCH EXISTING

NOTES:

- ALL REUSABLE AND SURPLUS SOILS WITHIN THE PROJECT LIMITS SHALL BE HANDLED IN ACCORDANCE WITH ITEM NO. 0202329A - MANAGEMENT OF REUSABLE AND SURPLUS SOIL.

REV.	DATE	REVISION DESCRIPTION

DESIGNER/DRAFTER: WAS/BOB CHECKED BY: TRB

HORIZONTAL SCALE
 1" = 40'

SIGNATURE/BLOCK: **HRP**

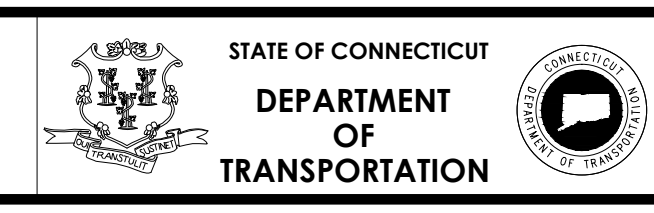

PROJECT NUMBER: 0053-0189
 PROJECT DESCRIPTION: REMOVAL OF BR. NOS. 00388 & 00389, DECK REPLACEMENT ON BR. NO. 00870, AND MODIFICATIONS TO ROUTE 17 & NEW LONDON TURNPIKE
 TOWN(S): GLASTONBURY
 DRAWING TITLE: PROJECT SOIL CONDITIONS

DRAWING NO. ENV-07
 SHEET NO. 08-07



TRSA LOCATION AND LAYOUT

SCALE: 1" = 80'

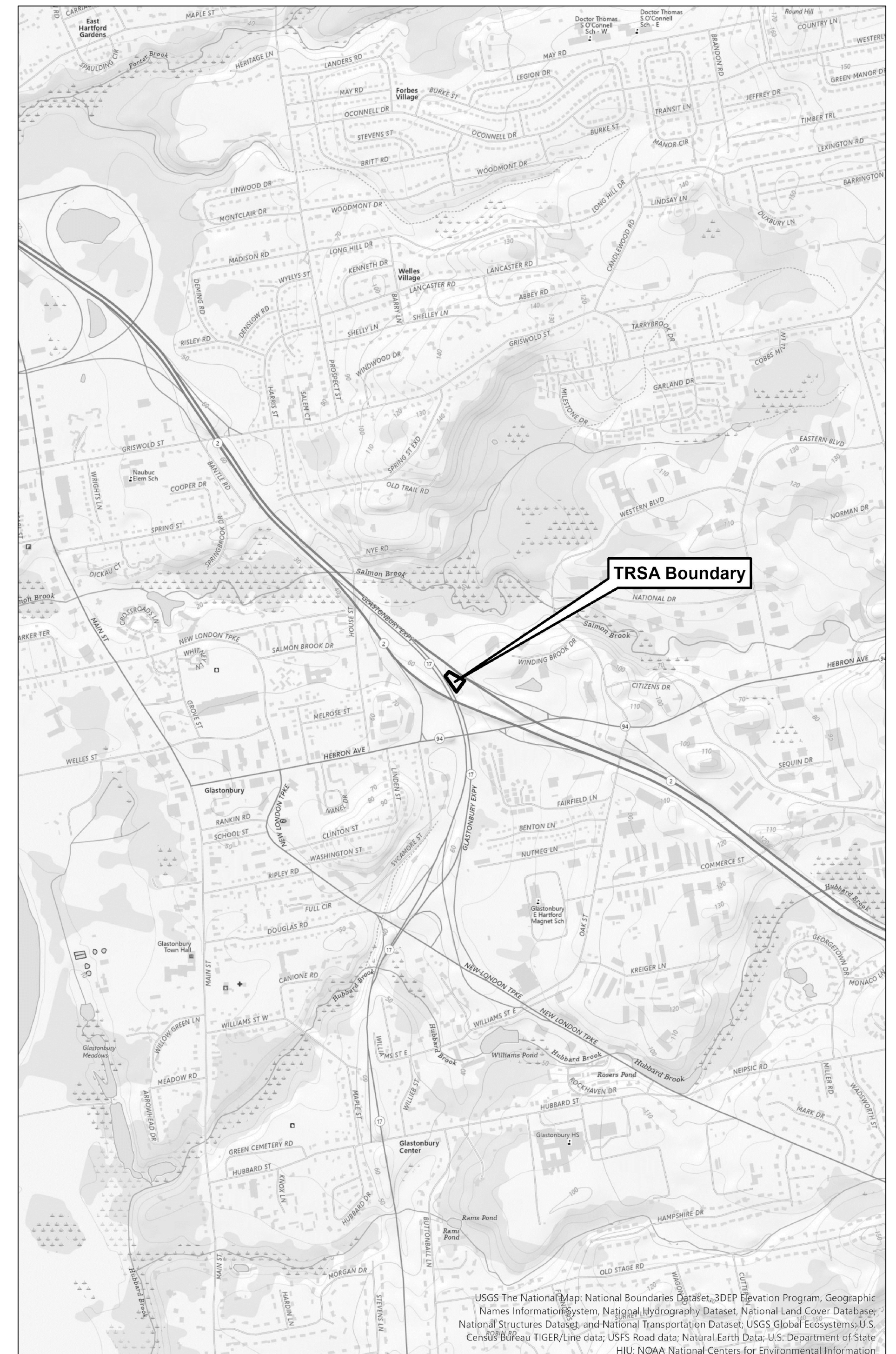

TRSA LOCATION MAP

SCALE: 1" = 1,000'

GENERAL NOTES

1. TEMPORARY REUSE STOCKPILE AREA (TRSA) MAINTENANCE AND ALL REQUIRED MATERIALS ARE AS INDICATED ON THE TRSA DETAILS SHEET.
2. WHERE FEASIBLE, A MINIMUM DISTANCE OF 5' IMMEDIATELY OUTSIDE THE PERIMETER OF THE TRSA CONCRETE BLOCK WALLS SHALL REMAIN CLEAR AND FREE OF ANY OBJECT TO PROVIDE ACCESS FOR MAINTENANCE.
3. HEIGHT OF THE CONCRETE BLOCKS, STOCKPILED REUSABLE AND SURPLUS SOIL AND CONFIGURATION OF THE BIN(S) MAY VARY BASED ON THE SIZE AS INDICATED ON THE TRSA DETAILS SHEET OR AS DIRECTED BY THE ENGINEER.
4. THE TRSA SURFACE SHALL BE SUFFICIENTLY IMPERVIOUS TO PREVENT OR MINIMIZE THE TRANSFER OR INFILTRATION OF CONTAMINANTS FROM THE STOCKPILES TO THE GROUND. THE TRSA SURFACE WILL VARY BASED ON PROJECT SPECIFICS AND MAY BE MAINTAINED ON NEW OR EXISTING PAVEMENT, BEDDING SAND, OR OTHER MATERIALS AS SHOWN ON THE TRSA DETAILS SHEET.
5. MATERIALS STORED WITHIN THE TRSA ARE TO BE COVERED AT ALL TIMES AS DEPICTED, OR AS DIRECTED BY THE ENGINEER.
6. REUSABLE AND SURPLUS SOIL COVERS MUST BE SECURED AND PROTECTED AGAINST HEAVY RAIN AND WIND WITH PROPER WEIGHTS.

REV.	DATE	REVISION DESCRIPTION

DESIGNER/DRAFTER: WAS/BOB CHECKED BY: TRB

SIGNATURE/BLOCK: **HRP**

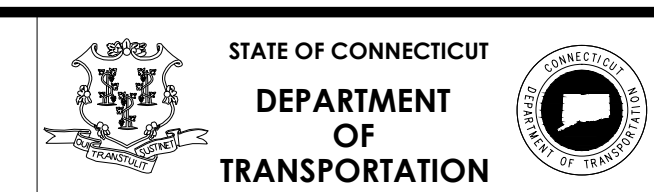

PROJECT NUMBER: 0053-0189
 PROJECT DESCRIPTION: REMOVAL OF BR. NOS. 00388 & 00389, DECK REPLACEMENT ON BR. NO. 00870, AND MODIFICATIONS TO ROUTE 17 & NEW LONDON TURNPIKE
 TOWN(S): GLASTONBURY
 DRAWING TITLE: TEMPORARY REUSE STOCKPILE AREA (TRSA) LOCATION



DRAWING NO. ENV-08
 SHEET NO. 08-08

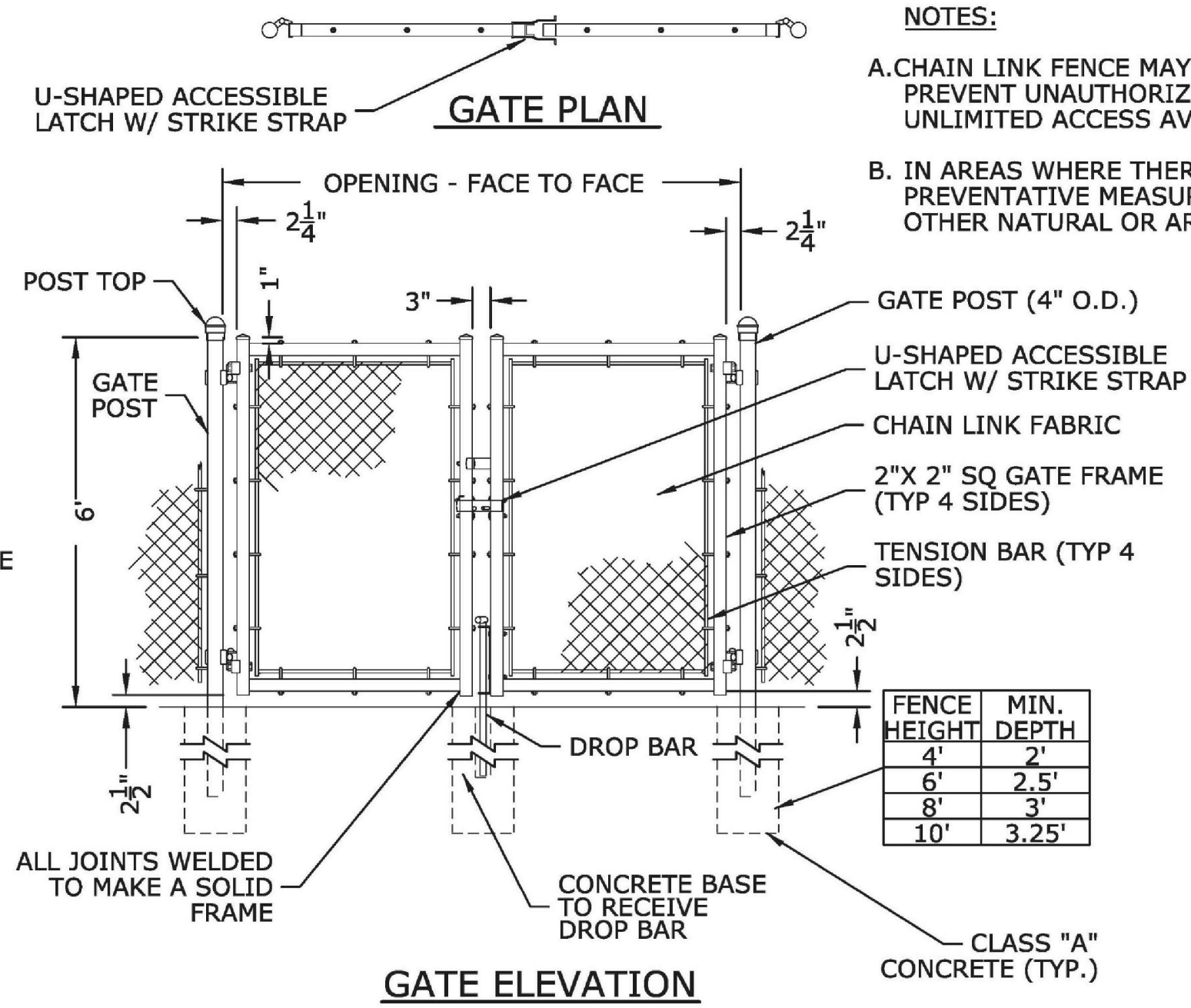

1 TYPICAL DOUBLE SWING GATES

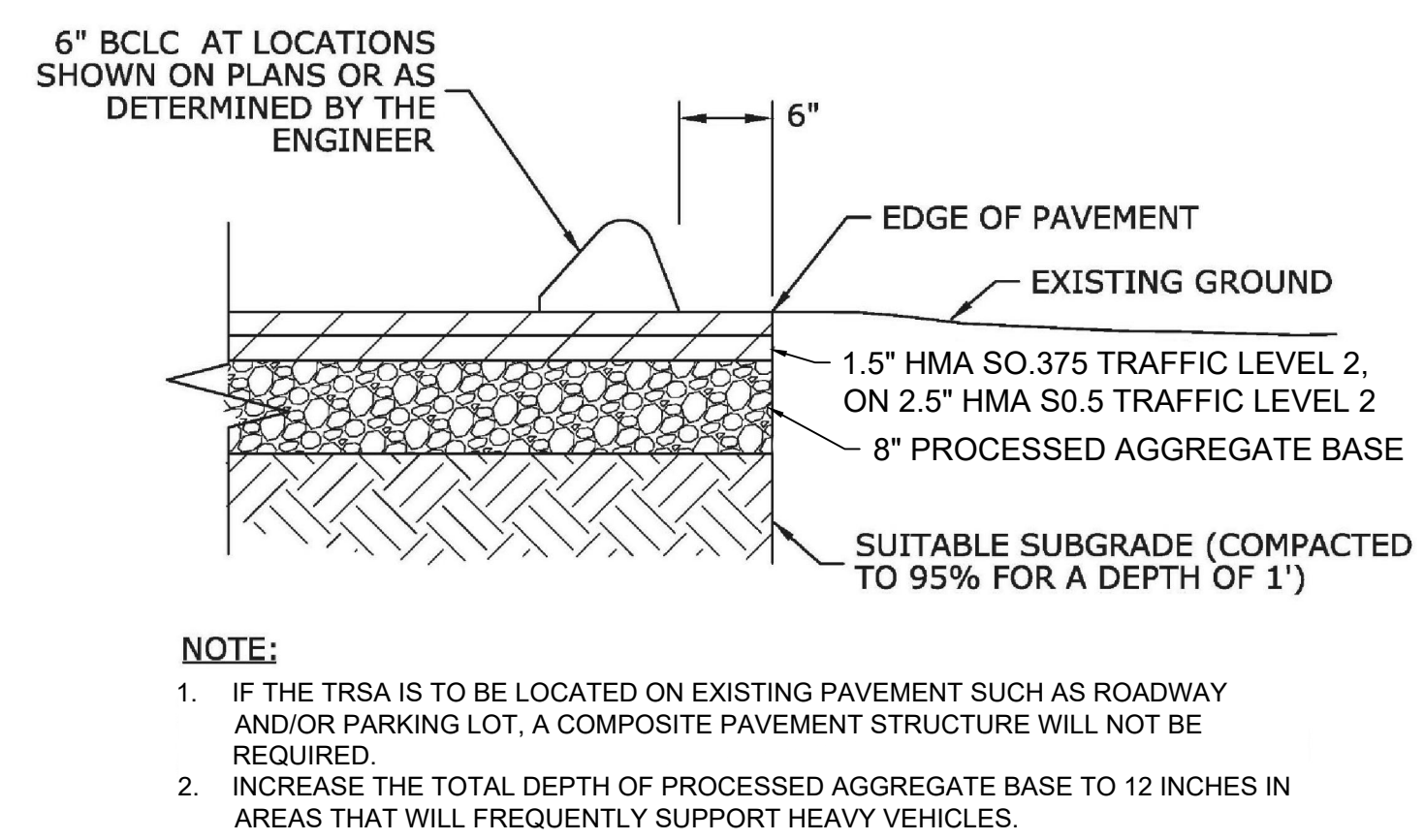

3 COMPOSITE PAVEMENT STRUCTURE DETAIL

- GENERAL NOTES**
- TEMPORARY REUSE STOCKPILE AREA (TRSA) MAINTENANCE AND ALL REQUIRED MATERIALS ARE AS INDICATED ON THE TRSA DETAILS SHEET.
 - WHERE FEASIBLE, A MINIMUM DISTANCE OF 5' IMMEDIATELY OUTSIDE THE PERIMETER OF THE TRSA CONCRETE BLOCK WALLS SHALL REMAIN CLEAR AND FREE OF ANY OBJECT TO PROVIDE ACCESS FOR MAINTENANCE.
 - HEIGHT OF THE CONCRETE BLOCKS, STOCKPILED REUSABLE AND SURPLUS SOIL AND CONFIGURATION OF THE BIN(S) MAY VARY BASED ON THE SIZE AS INDICATED ON THE TRSA DETAILS SHEET OR AS DIRECTED BY THE ENGINEER.
 - THE TRSA SURFACE SHALL BE SUFFICIENTLY IMPERVIOUS TO PREVENT OR MINIMIZE THE TRANSFER OR INFILTRATION OF CONTAMINANTS FROM THE STOCKPILES TO THE GROUND. THE TRSA SURFACE WILL VARY BASED ON PROJECT SPECIFICS AND MAY BE MAINTAINED ON NEW OR EXISTING PAVEMENT, BEDDING SAND, OR OTHER MATERIALS AS SHOWN ON THE TRSA DETAILS SHEET.
 - MATERIALS STORED WITHIN THE TRSA ARE TO BE COVERED AT ALL TIMES AS DEPICTED, OR AS DIRECTED BY THE ENGINEER.
 - REUSABLE AND SURPLUS SOIL COVERS MUST BE SECURED AND PROTECTED AGAINST HEAVY RAIN AND WIND WITH PROPER WEIGHTS.

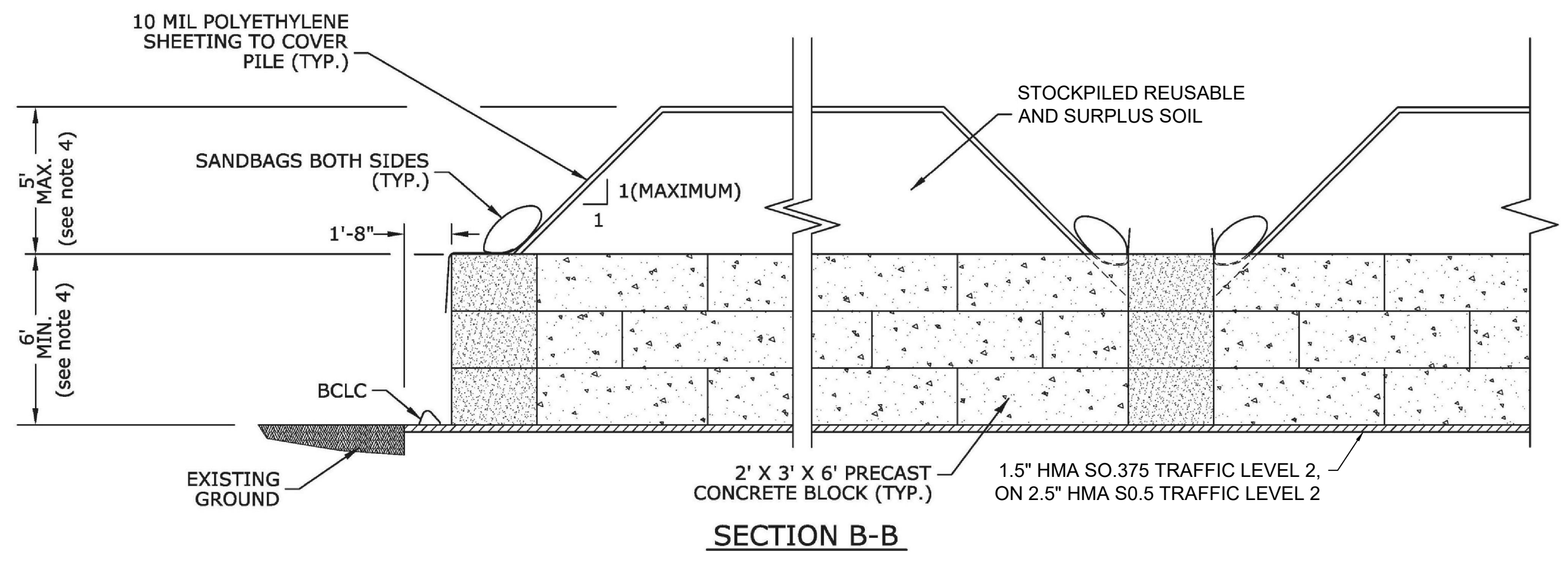

2 TEMPORARY REUSE STOCKPILE AREA DETAIL

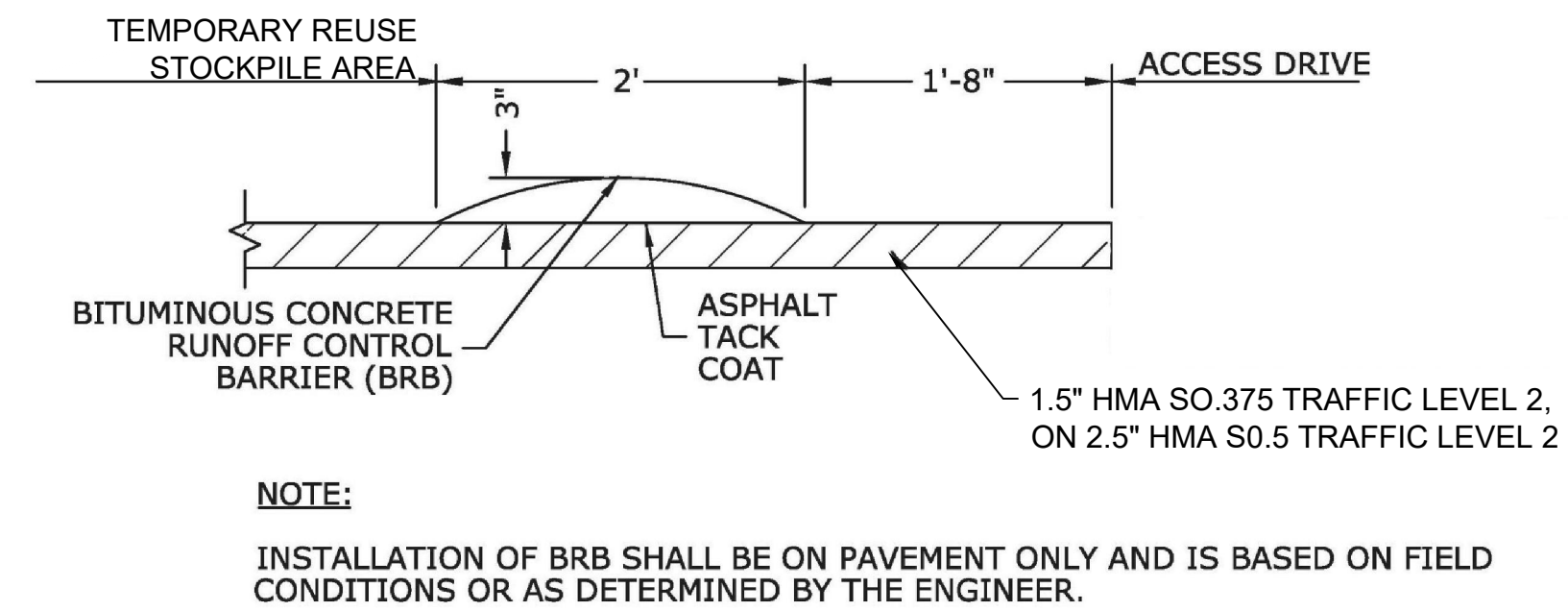

4 BITUMINOUS CONCRETE RUNOFF CONTROL BARRIER (BRB) DETAIL

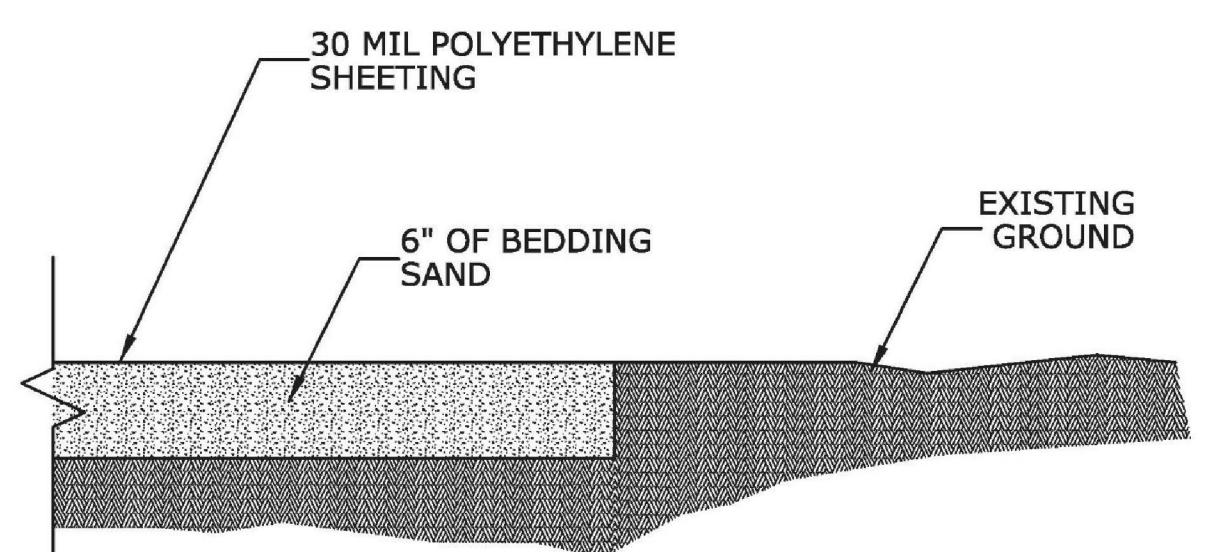

5 BEDDING SAND OVER EXISTING GROUND DETAIL

REV.	DATE	REVISION DESCRIPTION